



- Two Bedrooms
- Reception Room
- Separate Kitchen
- Communal Garden
- One allocated off Street Parking Space
- Close to Richmond Park

### Flat D (2nd Floor), 76 Church Road, Richmond, TW10 6LW

**Price: £575,000 - Leasehold**

Situated in a sought-after area within easy walking distance of Richmond Town Centre and Station, this bright top-floor two-bedroom conversion apartment offers wonderful living space and views over gardens at the rear. The property features two bedrooms with built-in wardrobes, a bathroom, a good size reception room with a feature fireplace and separate fully fitted kitchen with breakfast area. The property comes with a delightful communal garden which provides a peaceful retreat and a convenient allocated off-street parking space at the rear for one car.

This property presents an opportunity to buy a comfortable home in an idyllic location on Richmond Hill.

EPC - 52 E (Potential 66 C) Council Tax Band - E Lease – 118 years unexpired with share of freehold

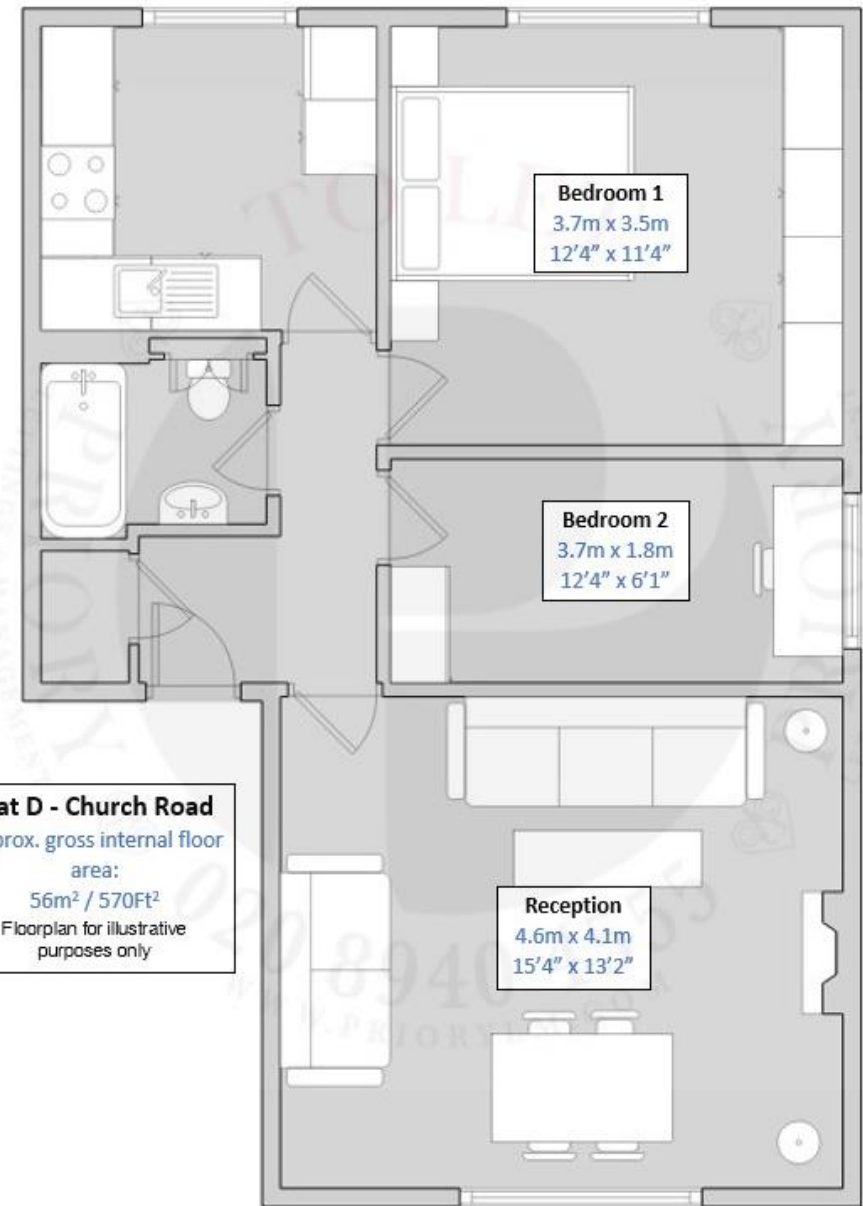

16 Kew Green  
Richmond  
Surrey  
TW9 3BH

www.priorylm.com  
020 8940 4555  
sales@priorylm.com

Agents Note: Whilst every care has been taken to prepare these sales particulars, they are for guidance purposes only. All measurements are approximate and are for general guidance purposes only and whilst every care has been taken to ensure their accuracy, they should not be relied upon and potential buyers are advised to recheck the measurements