

Julian Reid



**Flat 10, The Trees, 85-89 Amhurst Park, London, N16 5DP**

**A light and airy flat arranged on the first floor of a terrace of Victorian houses set back from the road and within a short walk of Stamford Hill overground station**

**Guide Price £400,000**  
**Leasehold**

- **Excellent condition**
- **Council Tax Band: C**
- **EPC Rating: C**
- **1 Bedroom**
- **Large Reception room**

A spacious flat arranged on the first floor of a converted Victorian house, part of a terrace set back from the road behind parking and gardens. The flat offers well presented accommodation which has been recently refurbished. Large, bright reception room into bay window, separate well fitted kitchen, modern bathroom and bedroom to the rear. Ideal pied-a-terre of first purchase which is located within a short walk of Stamford Hill overground station (Liverpool Street 15 minutes) and accessible to the vibrant selection of shops, bars and restaurants in Stoke Newington



Julian Reid  
51 Stoke Newington Church Street London N16 0AR  
jreid@julianreid.co.uk Fax: 020 7923 8651  
+44 (0) 20 7923 8650

## The Trees

Approximate Gross Internal Area

First Floor = 489 sq ft / 45.43 sq m  
Total = 489 sq ft / 45.43 sq m

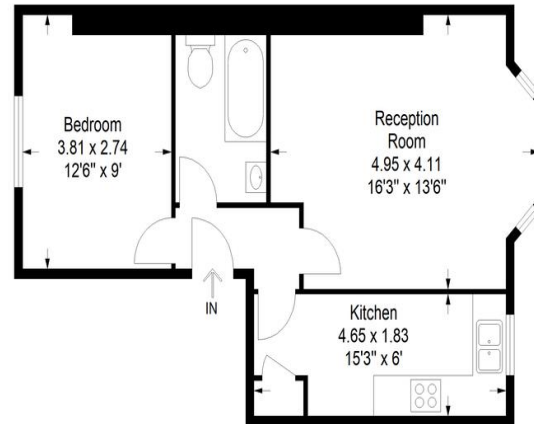

## First Floor

JULIAN REID SPECIAL DISCLAIMER:-  
For Illustration Purposes Only - Not To Scale  
Floor plan For Julian Reid

**Important notice:** Julian Reid, their clients and any joint agents give notice that: 1: They are not authorized to make or give representations or warranties in relation to the property either here or elsewhere, either on their own behalf or on behalf of the client or otherwise. They assume no responsibility for any statement that may be made in these particulars. These particulars do not form part of any offer or contract and must not be relied upon as statements or representations of fact. 2: Any areas, measurements or distances are approximate. The text, photographs and plans are for guidance only and are not necessarily comprehensive. It should not be assumed that the property has all necessary planning, building regulation or other consents and Julian Reid have not tested any services, equipment or facilities. Purchasers must satisfy themselves by inspection or otherwise.

