



Property Summary

Immaculate detached home for sale on the ever popular Wigston Harcourt. The current owners have extended the kitchen and added a utility room and downstairs w.c. Along with an extra reception room looking on to the garden. The accommodation comprises entrance hall, lounge, dining room, family room, kitchen, utility area, downstairs w.c., three bedrooms, bathroom, garage, rear garden and off road parking.



GROUND FLOOR
606 sq.ft. (56.3 sq.m.) approx.

1ST FLOOR
315 sq.ft. (29.3 sq.m.) approx.

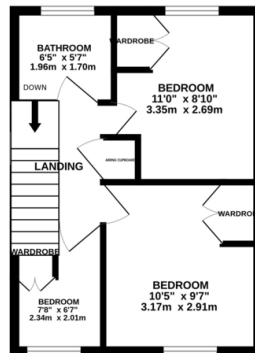
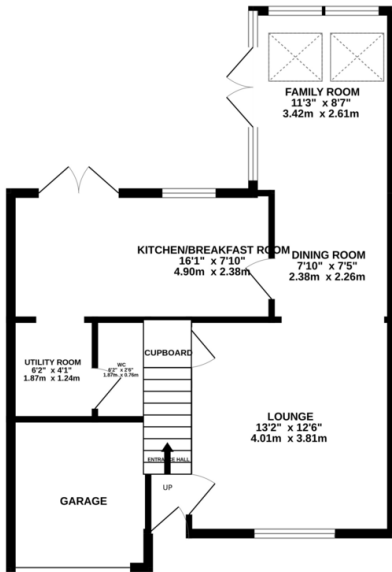

TOTAL FLOOR AREA: 921 sq.ft. (85.6 sq.m.) approx.

Whilst every attempt has been made to ensure the accuracy of the floorplan contained here, measurements of doors, windows, rooms and any other items are approximate and no responsibility is taken for any error, omission or mis-statement. This plan is for illustrative purposes only and should be used as such by any prospective purchaser. The services, systems and appliances shown have not been tested and no guarantee as to their operability or efficiency can be given.
Made with Metropix C2023

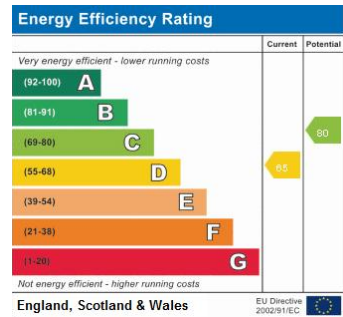

- Extended
- Detached
- Popular Location
- Three Bedrooms
- Garage
- Utility Room
- Downstairs W.C.
- Three Reception Rooms

phillips george | sales & lettings

Agents Note: Whilst every care has been taken to prepare these sales particulars, they are for guidance purposes only. All measurements are approximate and for general guidance purposes only and whilst every care has been taken to ensure their accuracy, they should not be relied upon and potential buyers are advised to recheck the measurements

46 Long Street, Wigston, Leicestershire, LE18 2AH

info@phillipsgeorge.co.uk
0116 216 8178

