

Property Details

368 Tempest Road, Lostock,
Bolton, Lancashire, BL6 4HS

Guide Price **£225,000**



Property Photos

368 Tempest Road, Lostock, Bolton, Lancashire, BL6 4HS



Creation Date

27/04/2023

Property Photos

368 Tempest Road, Lostock, Bolton, Lancashire, BL6 4HS



Creation Date
27/04/2023

Property Photos

368 Tempest Road, Lostock, Bolton, Lancashire, BL6 4HS



Creation Date
27/04/2023

Property Floor Plans

368 Tempest Road, Lostock, Bolton, Lancashire, BL6 4HS



GROUND FLOOR
APPROX. FLOOR
AREA 540 SQ.FT.
(51.0 SQ.M.)

1ST FLOOR
APPROX. FLOOR
AREA 434 SQ.FT.
(40.3 SQ.M.)

TOTAL APPROX. FLOOR AREA 982 SQ.FT. (91.3 SQ.M.)

Whilst every attempt has been made to ensure the accuracy of the floor plan contained here, measurements of doors, windows, rooms and any other items are approximate and no responsibility is taken for any error, omission, or mis-statement. This plan is for illustrative purposes only and should be used as such by any prospective purchaser. The services, systems and appliances shown have not been tested and no guarantee as to their operability or efficiency can be given.

Made with Metropix ©2018

Creation Date

27/04/2023

Property Floor Plans

368 Tempest Road, Lostock, Bolton, Lancashire, BL6 4HS

GROUND FLOOR
549 sq.ft. (51.0 sq.m.) approx.

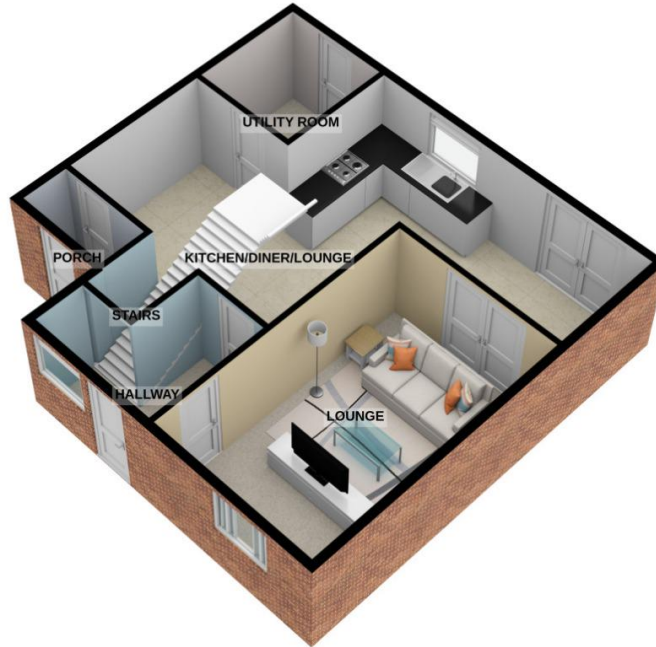

1ST FLOOR
434 sq.ft. (40.3 sq.m.) approx.

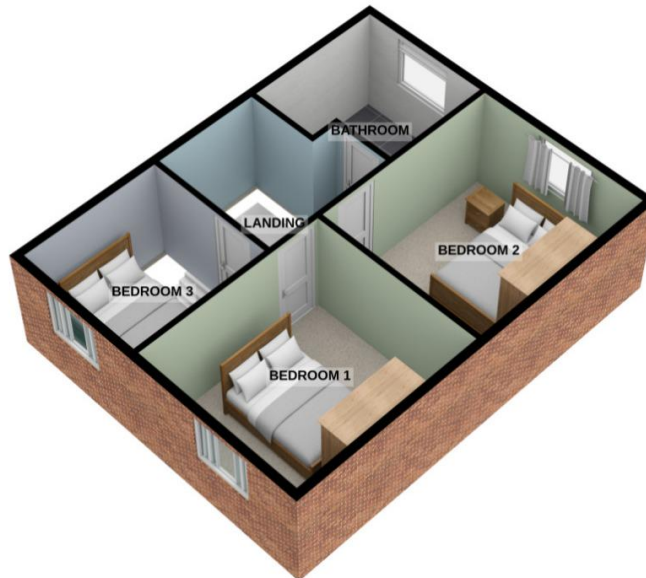

TOTAL FLOOR AREA : 982 sq.ft. (91.3 sq.m.) approx.

For illustrative purposes only. Decorative finishes, fixtures, fittings and furnishings do not represent the current state of the property. Measurements are approximate. Not to scale.
Made with Metropix © 2023

Creation Date
27/04/2023

Property EPC

368 Tempest Road, Lostock, Bolton, Lancashire, BL6 4HS

Energy efficiency rating for this property

This property's current energy rating is C. It has the potential to be B.

See how to improve this property's energy performance.



The graph shows this property's current and potential energy rating.

Properties get a rating from A (best) to G (worst) and a score. The better the rating and score, the lower your energy bills are likely to be.

For properties in England and Wales:

- the average energy rating is D
- the average energy score is 60

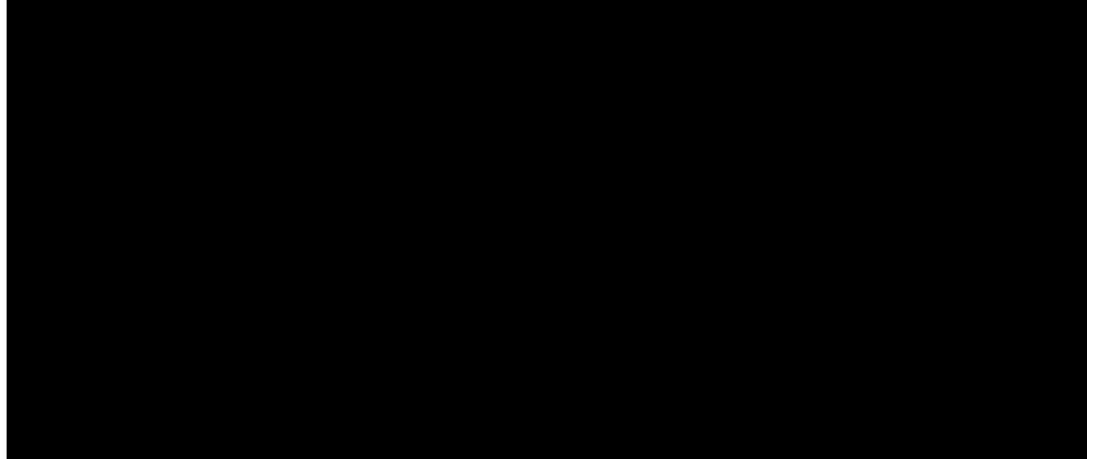

Creation Date

27/04/2023

Property Info

368 Tempest Road, Lostock, Bolton, Lancashire, BL6 4HS

Property Type	Property Style
House	Semi-Detached
Bedrooms	Bathroom
3	1
Receptions	Tenure Type
3	Leasehold
Floor Area	Agency Type
-	-
Parking	Type
Drive	Sales
Price Qualifier	Price
Guide Price	£225,000
Land Size	Age of Property
-	-
Year Built	New Home
-	No

Creation Date

27/04/2023

Property Features

368 Tempest Road, Lostock, Bolton, Lancashire, BL6 4HS

Feature 1

3 Bedrooms

Feature 2

Semi Detached

Feature 3

Open Plan Kitchen

Feature 4

Utility Room

Feature 5

Off Road Parking

Feature 6

Spacious Garden

Feature 7

No Chain

Creation Date

27/04/2023

Property Description

368 Tempest Road, Lostock, Bolton, Lancashire, BL6 4HS

Tempest Road, Chew Moor, Lostock, Bolton, Lancashire. **Offered With No Chain**

Welcome to Tempest Road, Chew Moor, Lostock.

Ever fancied living in the heart of Lostock?

Offered with no onward chain, this charming 3 bedroom extended semi-detached property is now available for sale. It boasts a spacious living area, open-plan kitchen, and three comfortable bedrooms. The property also benefits from a lovely garden and off-street parking. Close access to Westhoughton, Lostock Train Station, and the local pub which is the Duke Of Wellington.

The property does require some updating, however a fantastic opportunity to create your dream family home!

Don't miss out on this fantastic opportunity, early viewing is recommended to view this property.

Council Tax Band: C

EPC Rating: C

Tenure: Leasehold

Creation Date

27/04/2023