



3 Bedroom Mid Terraced Offers Over £270,000

165 Avonmead, Greenmeadow, Swindon, Wiltshire, SN25 3PS

mcfarlane
property.com

3 Bedroom Mid Terraced Avonmead, Greenmeadow

- IMMACULATELY PRESENTED THROUGHOUT
- REFURBISHED THROUGHOUT
- POPULAR LOCATION
- FANTASTIC FIRST TIME BUY / INVESTMENT

McFarlane are delighted to offer this beautifully presented and spacious three-bedroom terraced home to the market, positioned in the desirable location of Greenmeadow, North Swindon. The property has been fully refurbished and modernised throughout by the current owner and ready to move in to without any works required. Comprising; living room/diner, a modern refitted kitchen, separate lobby and downstairs WC. Upstairs is occupied by three great sized bedrooms and a refitted, three-piece family bathroom with shower over the bath. Further new features include new boiler, PVCU double glazing throughout, guttering, new fencing, fascia's and all internal and external doors. The rear garden has been landscaped and is laid mostly to lawn with a patio area to bottom. A garage & off-road parking are also a plus point of this fantastic home. Viewings are highly recommended.





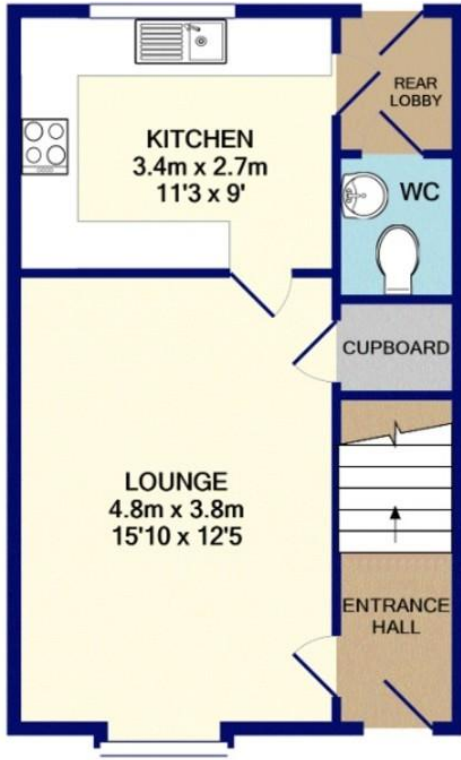

GROUND FLOOR
APPROX. FLOOR
AREA 36.2 SQ.M.
(390 SQ.FT.)

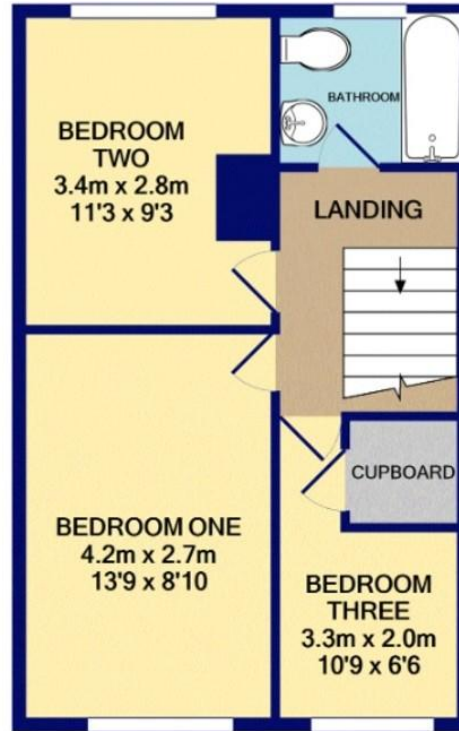

1ST FLOOR
APPROX. FLOOR
AREA 35.2 SQ.M.
(378 SQ.FT.)

TOTAL APPROX. FLOOR AREA 71.4 SQ.M. (768 SQ.FT.)

Whilst every attempt has been made to ensure the accuracy of the floor plan contained here, measurements of doors, windows, rooms and any other items are approximate and no responsibility is taken for any error, omission, or mis-statement. This plan is for illustrative purposes only and should be used as such by any prospective purchaser. The services, systems and appliances shown have not been tested and no guarantee as to their operability or efficiency can be given

Made with Metropix ©2021

We 
where you
LIVE

Our team are friendly, experienced and are all local. They know it better than they do their own living rooms and can help you find what you're looking for because **we love where we live.**

We would be delighted to show you around this property.

**Because every home
needs a personal touch.**

**If you would like to view this
property then please get in touch.**

 01793 296600

 swindon@mcfarlaneproperty.com

mcfarlaneproperty.com

mcfarlane
property.com

Cricklade.
102 High Street
Cricklade SN6 6AA
 01793 751044

Marlborough.
106 High Street
Marlborough SN8 1LT
 01672 514380

Old Town.
28-30 Wood Street
Swindon SN1 4AB
 01793 296880

Swindon.
The Village Centre,
Redhouse SN25 2FW
 01793 296600

Agents Note: Whilst every care has been taken to prepare these sales particulars, they are for guidance purposes only. All measurements are approximate and for general guidance purposes only and whilst every care has been taken to ensure their accuracy, they should not be relied upon and potential buyers are advised to recheck the measurements