

FOR SALE



Willis Road, Haddenham

3 Bedrooms, 1 Bathroom, Semi-Detached Bungalow

Guide Price £420,000

MARTIN&CO



Key Notes:

- Spacious 3 Bedroom Home
- South Easterly Garden
- Detached Garage
- Great Potential
- Additional Cloakroom
- Close to Amenities
- Train Station - Marylebone C. 40min
- No Onward Chain
- Council Tax Band: D



Score	Energy rating	Current	Potential
92+	A		
81-91	B		83 B
69-80	C		
55-68	D		
39-54	E	46 E	
21-38	F		
1-20	G		





This lovely 3 bedroom dormer bungalow features a bright open spaced living room and dining room. On the ground floor is also a well equipped kitchen, main bedroom and a walking in shower room.

From the dining room the stairs take you to a further 2 bedrooms and separate cloak room.

The property is decorated mainly in neutral colours and ready to be made into a home of your choosing.

Outside is a separate garage and storage room to the side/rear of the property with plentiful off street parking in the form of a drive to the front aspect.

The well-appointed garden is a mixture of bedding, grass and raised beds and offers good space with the added benefit of being a south easterly orientation. To the front of the property the home is set back and offers a matured front garden.



Haddenham, Aylesbury, HP17



Access
To Eaves

Approximate Area = 1046 sq ft / 97.2 sq m (includes garage)

Outbuilding = 98 sq ft / 9.1 sq m

Total = 1144 sq ft / 106.3 sq m

For identification only - Not to scale

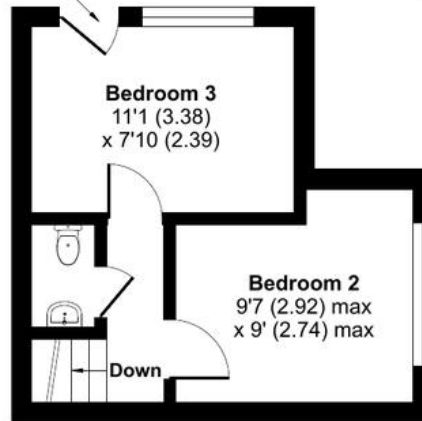

FIRST FLOOR

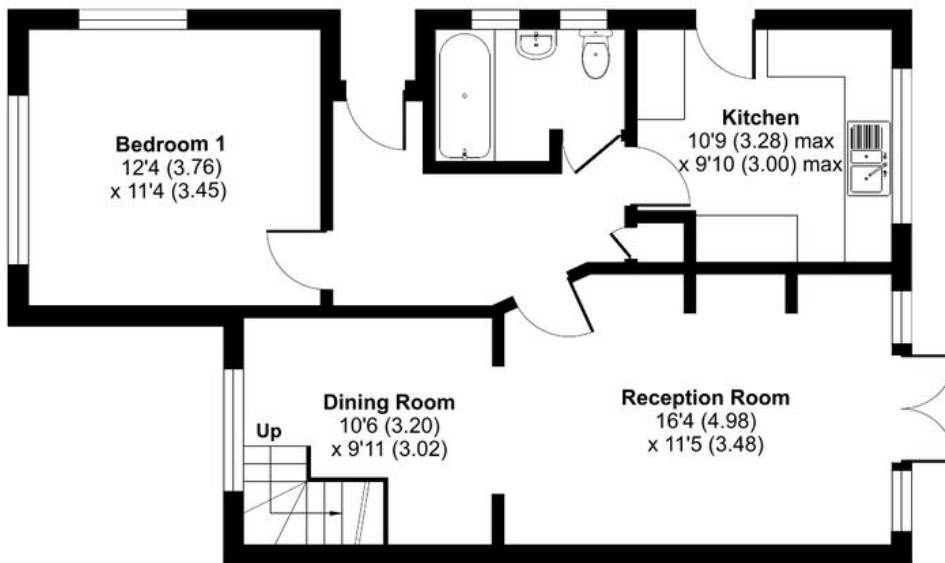

GROUND FLOOR



Floor plan produced in accordance with RICS Property Measurement Standards incorporating International Property Measurement Standards (IPMS2 Residential). © nchecon 2023
Produced for Urwin (Oxford) Limited t/a Martin & Co. REF: 977210

Martin & Co Thame

13 Upper High Street • • Thame • OX9 3ER
T: 01844 216667 • E: thame@martinco.com

01844 216667

<http://www.martinco.com>



Accuracy: References to the Tenure of a Property are based on information supplied by the Seller. The Agent has not had sight of the title documents. A Buyer is advised to obtain verification from their Solicitor. Items shown in photographs including but not limited to carpets, fixtures and fittings are not included unless specifically mentioned within the sales particulars. They may however be available by separate negotiation. Buyers must check the availability of any property and make an appointment to view before embarking on any journey to see a property. No person in the employment of the agent has any authority to make any representation about the property, and accordingly any information given is entirely without responsibility on the part of the agents, sellers(s) or lessors(s). Any property particulars are not an offer or contract, nor form part of one. **Sonic / Laser Tape:** Measurements taken using a sonic / laser tape measure may be subject to a small margin of error. **All Measurements:** All Measurements are Approximate. **Services Not tested:** The Agent has not tested any apparatus, equipment, fixtures and fittings or services and so cannot verify that they are in working order or fit for the purpose. A Buyer is advised to obtain verification from their Solicitor or Surveyor.

