



2 Bedroom Ground Floor Apartment £155,000

Purcell's Court , George Lane, Marlborough, SN8 4BS

**mcfarlane**  
property.com

## 2 Bedroom Ground Floor Marlborough

---

- Walking Distance of Town Centre
  - Two Bedrooms
  - Retirement Home for over 55's
  - Ground Floor
- 

An extremely well presented 2 bedroom, ground floor retirement apartment within walking distance of Marlborough Town Centre and the river Kennet. The property benefits from 2 bedrooms, lounge/diner, kitchen and bathroom with a low maintenance garden area to the front which is owned and maintained by the management company..

This retirement property is one of the closest developments to Marlborough Town Centre. You also have the benefit of buying a leasehold and becoming a freeholder on completion as each resident owns 1/15th of the development. In house management is by Warwick Estates who employ a House Manager, who is on duty for 2 hours per day during the week, thus ensuring the property is maintained to an exceptional standard including the communal areas, gardens, laundry room and parking area.

To the rear of the property are a number of car parking spaces and the communal gardens which are mainly laid to lawn.



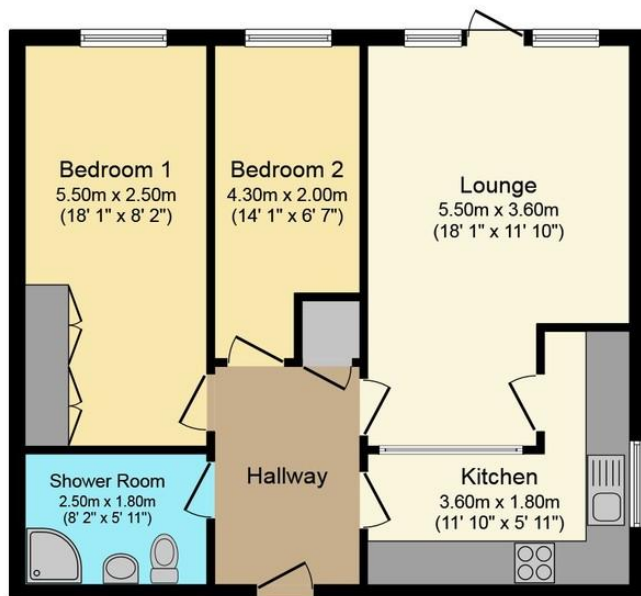

### Floor Plan

Floor area 61.4 sq.m. (661 sq.ft.) approx

Total floor area 61.4 sq.m. (661 sq.ft.) approx

This Floor Plan is for illustration purposes only and may not be representative of the property. The position and size of doors, windows and other features are approximate. Unauthorized reproduction prohibited. © PropertyBOX

We   
 where you  
**LIVE**

Our team are friendly, experienced and are all local. They know it better than they do their own living rooms and can help you find what you're looking for because **we love where we live.**

We would be delighted to show you around this property.

**Because every home  
 needs a personal touch.**

**If you would like to view this  
 property then please get in touch.**

 01672 514380

 [marlborough@mcfarlaneproperty.com](mailto:marlborough@mcfarlaneproperty.com)

[mcfarlaneproperty.com](http://mcfarlaneproperty.com)

**mcfarlane**  
 property.com

**Cricklade.**  
 102 High Street  
 Cricklade SN6 6AA  
 01793 751044

**Marlborough.**  
 106 High Street  
 Marlborough SN8 1LT  
 01672 514380

**Old Town.**  
 28-30 Wood Street  
 Swindon SN1 4AB  
 01793 296880

**Swindon.**  
 The Village Centre,  
 Redhouse SN25 2FW  
 01793 296600

Agents Note: Whilst every care has been taken to prepare these sales particulars, they are for guidance purposes only. All measurements are approximate are for general guidance purposes only and whilst every care has been taken to ensure their accuracy, they should not be relied upon and potential buyers are advised to recheck the measurements