



 **4**
Bedrooms

 **2**
Bathrooms



Offered with no further chain is this spacious Three/Four-bedroom, Two Bathroom family home. Internally the property could benefit from some updating but offers a large living area. To the ground floor you will find a lounge, dining room/fourth bedroom, breakfast room, family kitchen, family bathroom and guests WC. To the first floor there are a further three bedrooms and the family bathroom. Externally you will find that the property is well placed providing easy access to transport links and local shops. All in all, this is one not to be missed.

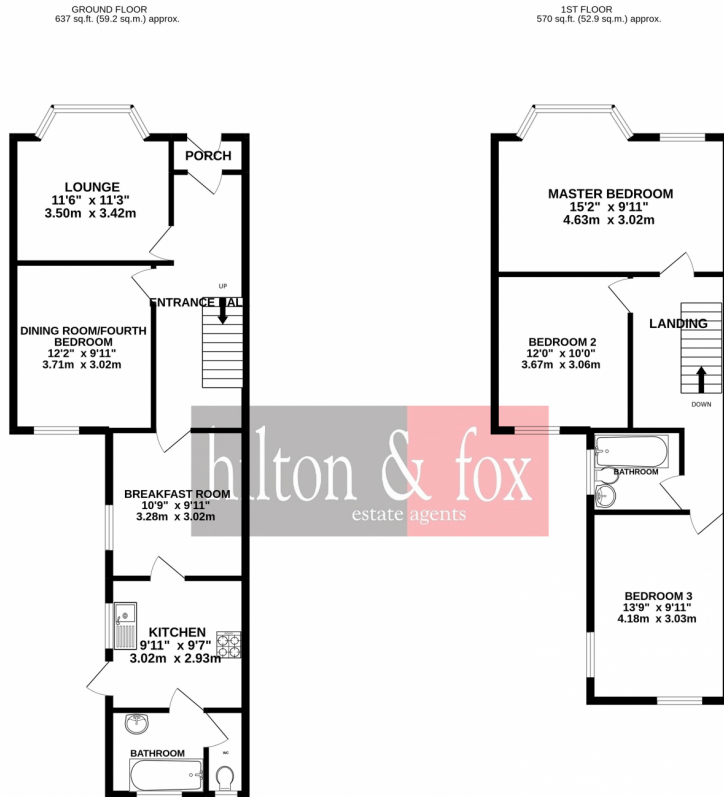

TOTAL FLOOR AREA : 1207 sq.ft. (112.1 sq.m.) approx.
 Whilst every attempt has been made to ensure the accuracy of the floorplan contained here, measurements of doors, windows, rooms and any other items are approximate and no responsibility is taken for any error, omission or mis-statement. This plan is for illustrative purposes only and should be used as such by any prospective purchaser. The services, systems and appliances shown have not been tested and no guarantee as to their operability or efficiency can be given.
 Made with Metropix ©2022

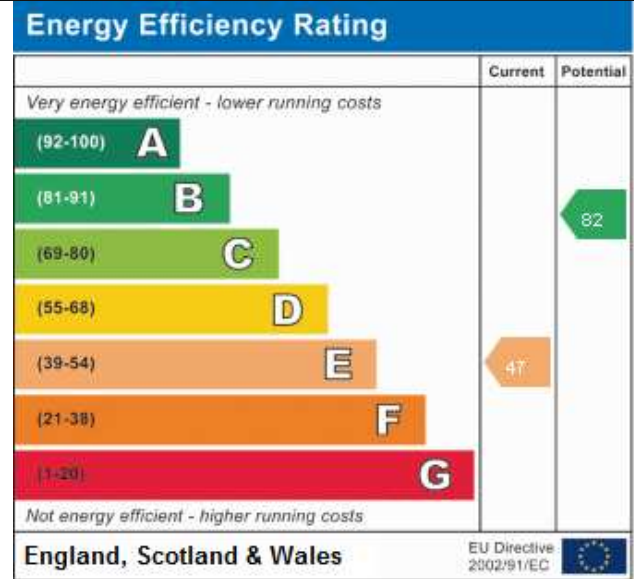



Mitchell Brook Primary School

B&M Home Store with Garden Centre

BAPS Shri Swaminarayan Mandir, London

Willesden Bus Garage

Brentfield Primary School

Willesden New Cemetery

Power Station

Willesden Cemetery

CHURCH END & ROUNDWOOD

Liberal Jewish Cemetery Prayer Hall

Total Energies

Bridge Park

Roundwood Park

Amigos Burgers & Shakes

Pak's Hair and Cosmetic Centre

The Stonebridge School

St Claudine's Catholic School for Girls

Newman Catholic College

Mordaunt Rd
Lawrence Ave

Greenhill Park

Nicoll Rd

A404