

To Let



Flat 1, 78 Commercial Street, London, E1 6LY

First-floor Victorian Conversion

£2,400 per calendar month

Net Lettings are delighted to offer this first-floor converted apartment situated in the heart of Spitalfields. Comprising a modern open-plan kitchen & living area, a double bedroom with French sliding doors to a private balcony, and three piece bathroom suite.

- Refurbished to a high standard
- Victorian-period property
- Wood-sash windows
- High-specification kitchen & bathroom
- Private balcony
- Five minutes walk to Liverpool Street
- Short walk to Spitalfields Market

Viewings by appointment only

info@netlettings.com

0208 981 5551



F1 Commercial St

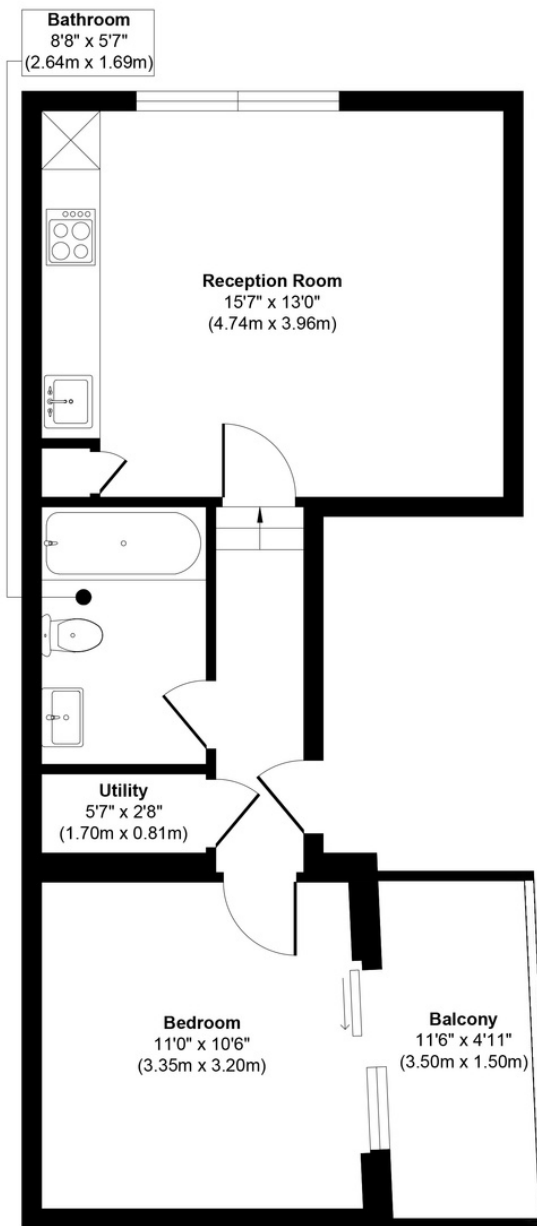



First Floor
Approximate Floor Area
432 sq. ft
(40.20 sq. m)

Approx. Gross Internal Floor Area 432 sq. ft / 40.20 sq. m

Illustration for identification purposes only, measurements are approximate, not to scale.
Produced by Elements Property

Location & Transport

-  57 mins walk to Canary Wharf
-  7 mins walk to Liverpool Street
-  19 mins walk to Bank

-  Aldgate East Underground - 0.3 miles | 6 mins walk
-  Liverpool Street Station - 0.3 miles | 7 mins walk
-  Shoreditch High Street Overground - 0.4 miles | 7 mins walk

 11 mins to Bank - Liverpool Street (Stop L)

 24 mins to Canary Wharf - Aldgate East Station (Stop H)





