

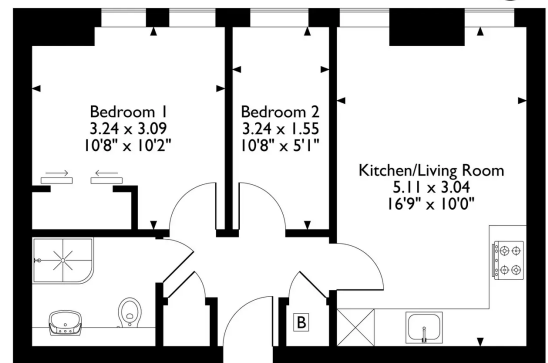

Verve Apartments, 5 Mercury Gardens, Romford
 Approximate Gross Internal Area
 40 Sq M/431 Sq Ft



Ground Floor Flat

Please note that the location of doors, windows and other items are approximate and this floorplan is to be used for illustrative purposes only. Unauthorized reproduction is prohibited.



7 Verve Apts, 5 Mercury Gardens, Romford

£250,000 Leasehold

INVESTMENT OPPORTUNITY • OPTIONAL PARKING AVAILABLE • LOWER GROUND FLOOR • ACCESS TO A12, A13, A127 & M25 • ELIZABETH LINE ROMFORD STATION • VARIOUS BUS ROUTES OUTSIDE DEVELOPMENT • MODERN INTERIOR • ELECTRIC • SECURE ENTRY & CONCEIRGE • FANTASTIC CONDITION

