

Renown House, NW10

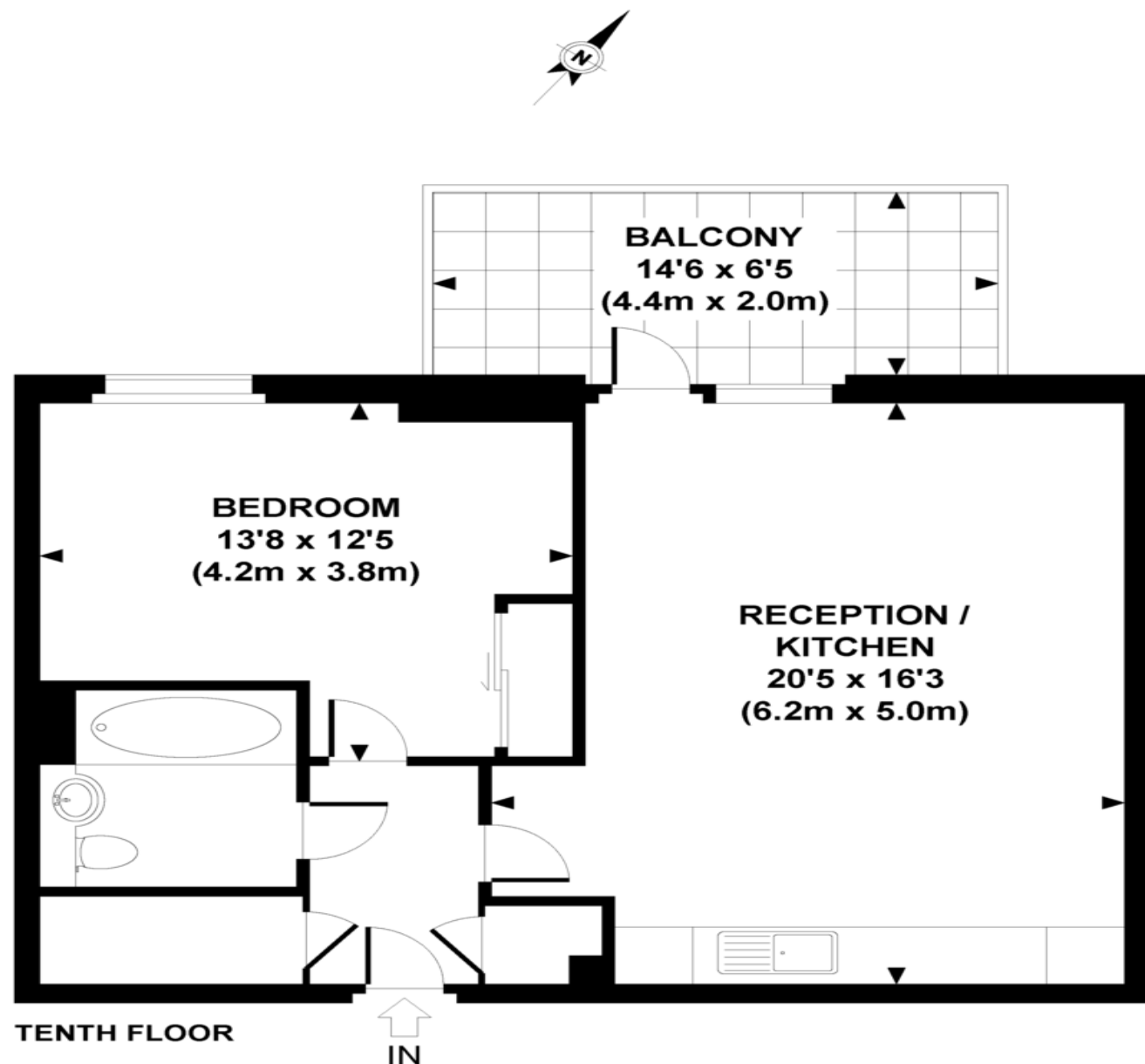

APPROXIMATE GROSS INTERNAL AREA 568 SQ FT / 52.8 SQ M

Whilst every attempt has been made to ensure the accuracy of this floor plan; measurements of door, windows, rooms and all other items are approximate. No responsibility is taken for any error, omission or mis-statement. This floor plan is for illustrative purposes only, and should be treated as such.



Acton Lane, London, NW10 7AL

£350,000 Leasehold

Key Features

- Stunning Apartment
- Highly Sought After
- Stylish Decor
- Jaw Dropping Views
- Huge Reception Room
- 568 sq ft
- Sought After Development
- Must Be Seen

Description

Hart and co are proud to present this bright and spacious one bedroom luxury apartment in this highly sought after lift serviced purpose built block in a popular location. This stunning apartment situated on the 10th floor offers specular London sky line views from the shard and as far as crystal palace, views of Wembley stadium can also be observed together with BT Telecom Tower.

The accommodation comprises a open planned kitchen reception room leading onto the private balcony double bedroom with built in wardrobes stylish bathroom 3 piece suite and good ample storage. There is a mix of local shops and Asda Park Royal Superstore is approx. 3 minutes' walk away. There is also a post office and a bank

