



HARRISON
Sales &
Lettings
HARDENSON

14 Willoughby Place Station Road, Bourton-On-The-Water
Cheltenham

Guide Price **£275,000**



A luxury two bedroom retirement apartment in the Willoughby Place development. Presented to a high standard the accommodation comprises; living room, two bathrooms, two bedrooms and fully fitted kitchen.

Part of our McCarthy & Stone's Retirement Living range, Willoughby Place is exclusively for those of 60 years or over. It has been designed and constructed for modern living. The dedicated House Manager is on site during working hours to take care of things and make you feel at home. There's no need to worry about the burden of maintenance costs as the service charge covers the cost of all external maintenance, gardening and landscaping, external window cleaning, buildings insurance, water rates and security systems.

All energy costs of the homeowners lounge and other communal areas are also covered in the service charge. The development has camera door entry and 24-hour emergency call systems. The owners' lounge provides a great space to socialise with friends and family and there is also a guest suite subject to availability and charge.

EPC - B

Council tax - E

Tenure - The property is Leasehold with approximately 993 years remaining. The ground rent is £247.50 and the service charge is £390.28.

Bourton on the Water is a large village situated in the heart of the North Cotswolds - a popular tourist destination, a village of enormous character and appeal, with period Cotswold stone houses and shops flanking the shallow River Windrush that runs through the village centre. There are a range of amenities, including gift shops, restaurants, pubs, hotels, clothes shops, hairdresser, supermarkets, library, post office, churches, primary and secondary schools.





14 Willoughby Place Bourton GL54 0GX
Main House Approx. Gross Internal Area:- 70.66 sq.m. 761 sq.ft.

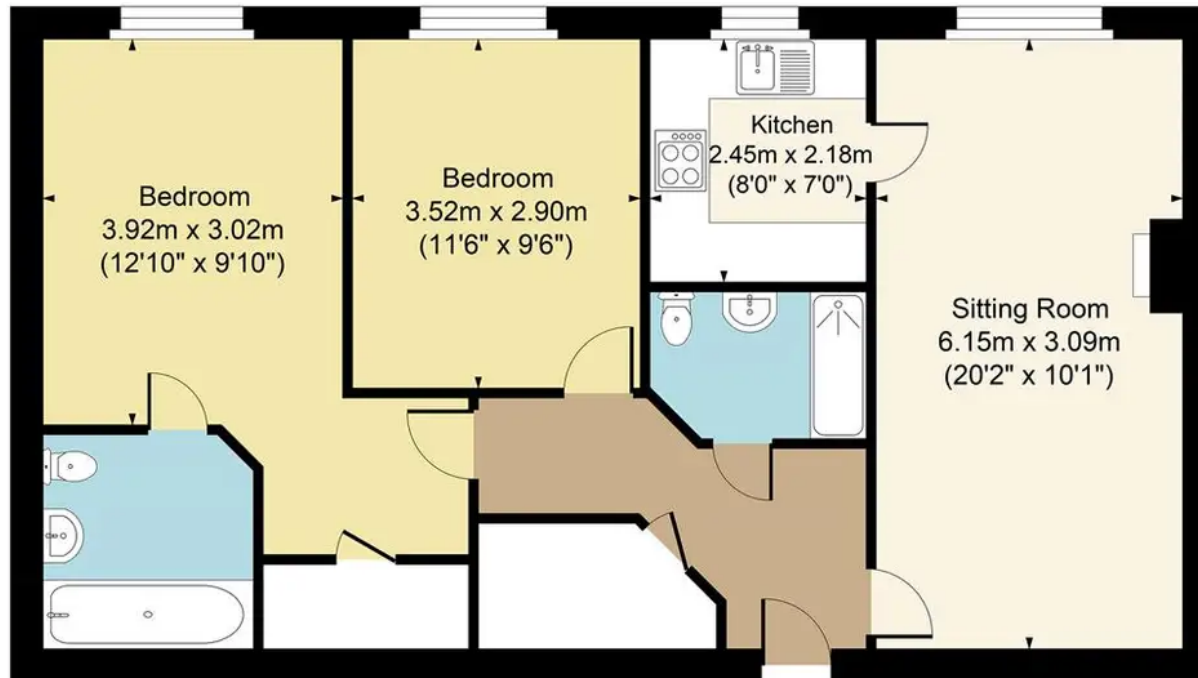

es &
ings
RDIE N

FOR ILLUSTRATIVE PURPOSES ONLY-NOT TO SCALE
The position & size of doors, windows, appliances and other features are approximate only.
□ □ □ Denotes restricted head height
www.dmlphotography.co.uk

14 Willoughby Place Station Road, Bourton-On-The-Water
Cheltenham

Guide Price £275,000