



Rye Hill | Sudbury | CO10 2BB

Available May is this two-bedroom bungalow with off-road parking. The property is located in a popular location of Sudbury and benefits from a modern fitted kitchen and bathroom, two bedrooms and large reception room. Call now to secure a viewing!

£850 pcm

- Available May
- Off-Road Parking
- Popular Location
- Gas Central Heating
- Large Reception Room
- Two Bedrooms

ENTRANCE HALL Enter from the front door into entrance hall. Access to living room, both bedrooms, kitchen and bathroom. Door to storage cupboard.

KITCHEN 11' 01" x 8' 0" (3.38m x 2.44m) The kitchen comprises of a range of matching wall and base units with wood effect doors and complementary work surface over. There is space under the counter for a washing machine and dishwasher as well as space for a fridge/freezer. Kitchen also benefits from four ring gas hob and double electric oven. Large window to the front overlooking front garden.

LIVING ROOM 12' 3" x 10' 7" (3.73m x 3.23m) Carpeted flooring. Window to rear with radiator below. Electrical sockets and aerial points.

MASTER BEDROOM 10' 7" x 10' 3" (3.23m x 3.12m) Carpeted flooring. Window to rear with radiator below.

BEDROOM TWO 6' 2" x 11' 2" (1.88m x 3.4m) Carpeted flooring. Window to front with radiator below.

BATHROOM 8' 1" x 5' 4" (2.46m x 1.63m) Paneled bath with shower over and glass shower screen, pedestal sink and low-level WC. Heated towel rail.

AGENTS NOTE The landlord is not currently accepting pets in this property.

Local Authority – Babergh District Council
Council Tax Band – B
Post Code – CO10 2BB

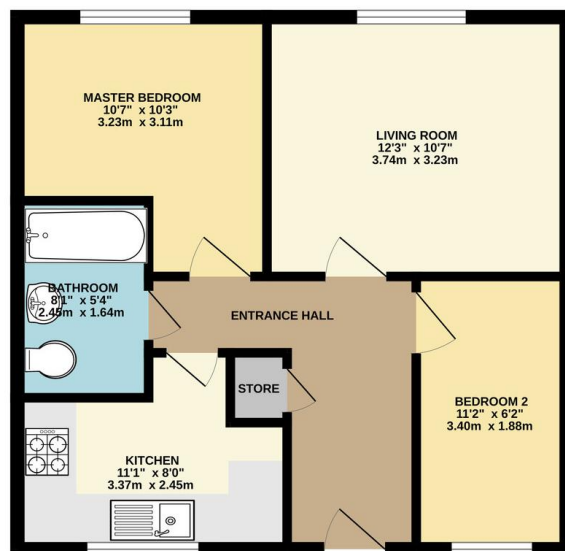

Contact Details

6 King Street, Sudbury, Suffolk, CO10 2EB

Tel: 01787 468400

Email: sudbury@bychoice.co.uk

Agents Note: Whilst every care has been taken to prepare these sales particulars, they are for guidance purposes only. All measurements are approximate and for general guidance purposes only and whilst every care has been taken to ensure their accuracy, they should not be relied upon and potential buyers are advised to recheck the measurements

