



- Three Bedroom End Terrace House
- Rustington Village Location
- Garage En Bloc
- 14'5 Lounge
- 15'1 Kitchen/ Diner
- In Need of Modernisation
- 12'6 Master Bedroom
- 13'5 Sunroom
- Close To Local Shops
- Chain Free

4 Woodlands Cottages, Woodlands Avenue, Rustington,

£299,950



KITCHEN/BREAKFAST ROOM 15' 1" x 11' 3" (4.6m x 3.43m)

LOUNGE 14' 5" x 11' 10" (4.39m x 3.61m)

SUN ROOM 13' 5" x 7' 3" (4.09m x 2.21m)

BEDROOM 1 12' 8" x 8' 11" (3.86m x 2.72m)

BEDROOM 2 11' x 8' 3" (3.35m x 2.51m)

BEDROOM 3 9' 8" x 5' 11" (2.95m x 1.8m)

GARAGE 16' 11" x 7' 11" (5.16m x 2.41m)

Littlehampton is a charming seaside town sheltered by the South Downs and providing a range of amenities to suit individuals, couples and families of all ages. The town benefits from two beaches with the popular East Beach providing a long promenade, family fun at Harbour Park, the award winning East Beach café, childrens playground and many other highlights. West Beach offers a quieter experience with the unspoilt grassy sand dunes offering ideal dog walking opportunities as well as watersports for those seeking adventure

The River Arun divides the two beaches and offers traditional seaside fun as well as modern cafes and restuarants as well as stunning views. The town's other recreational facilities include a cinema, modern sports centre, museum and golf course as well as many parks and green spaces. The mainline train station will take you to Gatwick Airport, Victoria Station and beyond and Littlehampton is located approximately 7 miles from Worthing and 13 miles from Chichester. There are a number of primary and junior schools in the town as well as The Littlehampton Academy. In the High Street you will find a range of shops including household names such as Costa,Sainsburys, Boots, New Look and Lidl mixed with a number of independent shops and a parking disk scheme allowing up to 2 hours free parking.

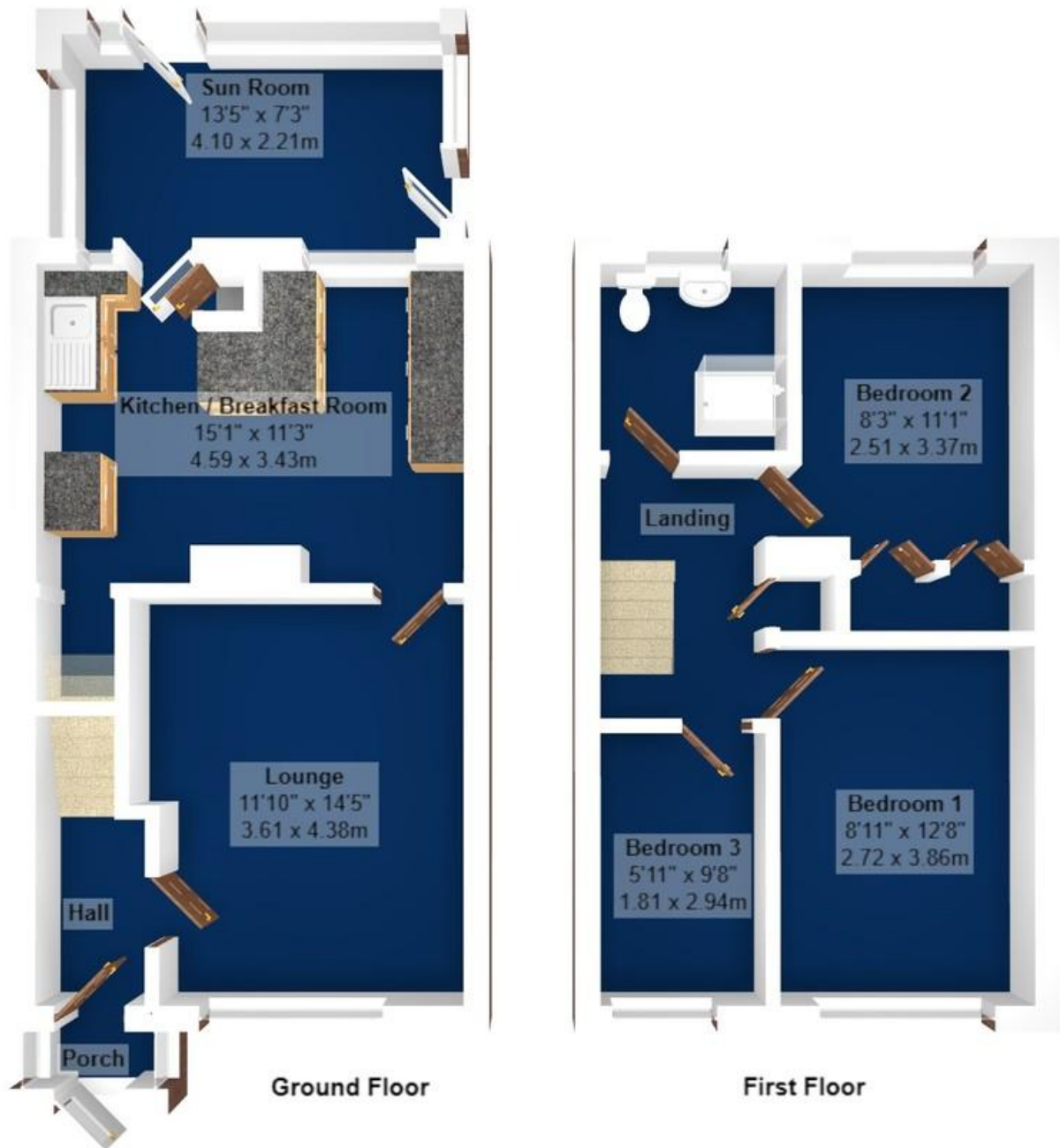

Total Area: 925 ft² ... 86.0 m²

Whilst every attempt has been made to ensure the accuracy of the floor plan contained here, measurements are approximate and no responsibility is taken for error, omission or mis-statement.

This plan is for illustrative purposes only and should be used as such by any prospective purchaser.

Created by Jtm 2023

These particulars are produced in good faith and are believed to be correct, but their accuracy is in no way guaranteed and they do not form part of a contract. We have not carried out a survey, nor tested the services, appliances and specified fittings. Room measurements are approximate.