



 2 Bedroom Semi-Detached House Offers In Excess Of £210,000
Symonds, Freshbrook, Swindon, SN5 8QL

mcfarlane
property.com

2 Bedroom Semi-Detached West Swindon

- GREAT INVESTMENT OPPORTUNITY
- BUY TO LET INVESTORS ONLY
- TWO BEDROOM SEMI DETACHED HOUSE

- BUY TO LET INVESTORS ONLY - TWO BEDROOM SEMI DETACHED HOUSE - POPULAR WEST SWINDON CUL-DE-SAC LOCATION - EXCELLENT YIELD POTENTIAL - CONSERVATORY – UTILITY - GARAGE & DRIVEWAY - VIEWING RECOMMENDED -

A superb opportunity for buy to let investors to acquire a two bedroom semi detached property with garage to the side located in a residential cul-de-sac in West Swindon. The accommodation comprises: Entrance Hall, Lounge, Fitted Kitchen/Diner, Conservatory, Utility Area, Landing, Two Bedrooms and Bathroom. Additionally there is Gas Central Heating and Double Glazing. Outside there is a Single Garage & Driveway along with enclosed Gardens. Viewing Recommended.





Ground Floor

Approx. 26.2 sq. metres (281.7 sq. feet)

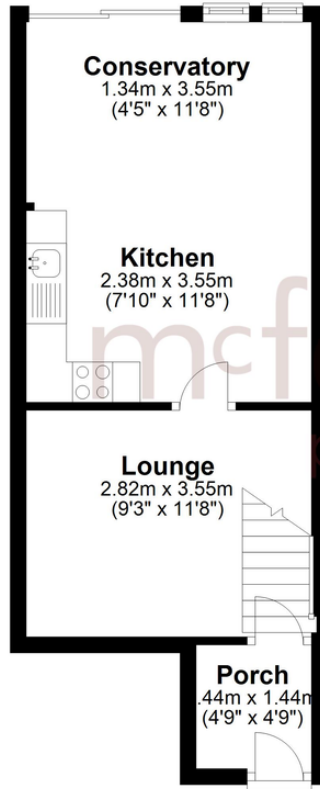

First Floor

Approx. 17.5 sq. metres (188.1 sq. feet)

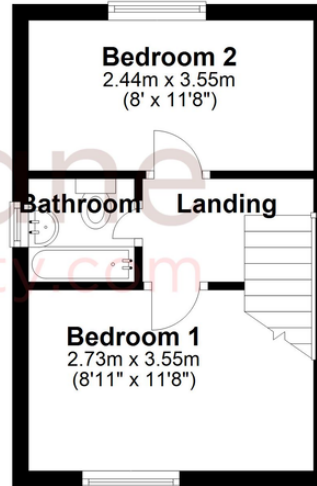

Total area: approx. 43.7 sq. metres (469.9 sq. feet)

We 
where you
LIVE

Our team are friendly, experienced and are all local. They know it better than they do their own living rooms and can help you find what you're looking for because **we love where we live.**

We would be delighted to show you around this property.

**Because every home
needs a personal touch.**

**If you would like to view this
property then please get in touch.**

 01793 751044

 cricklade@mcfarlaneproperty.com

mcfarlaneproperty.com

mcfarlane
property.com

Cricklade.

102 High Street
Cricklade SN6 6AA

 01793 751044

Marlborough.

106 High Street
Marlborough SN8 1LT

 01672 514380

Old Town.

28-30 Wood Street
Swindon SN1 4AB

 01793 296880

Swindon.

The Village Centre,
Redhouse SN25 2FW

 01793 296600

Agents Note: Whilst every care has been taken to prepare these sales particulars, they are for guidance purposes only. All measurements are approximate and are for general guidance purposes only and whilst every care has been taken to ensure their accuracy, they should not be relied upon and potential buyers are advised to recheck the measurements