

25
YEARS

SERVING
BEACONSFIELD
SINCE 1998



11 Somerford Place, Beaconsfield

Guide Price £745,000 | £2,500 pcm

Ashington Page

Well-presented, 3-bedroom, 2-bathroom house located in a quiet residential cul-de-sac within a stones-throw of Beaconsfield New Town shops and station. Upon entering the property through the front door, you are welcomed into a spacious entrance hall with access to the garage, which features light and power and an electric up and over door, providing ample storage space for your vehicle and other belongings. The entrance hall also includes a downstairs cloakroom and a coat cupboard, providing convenient storage solutions.

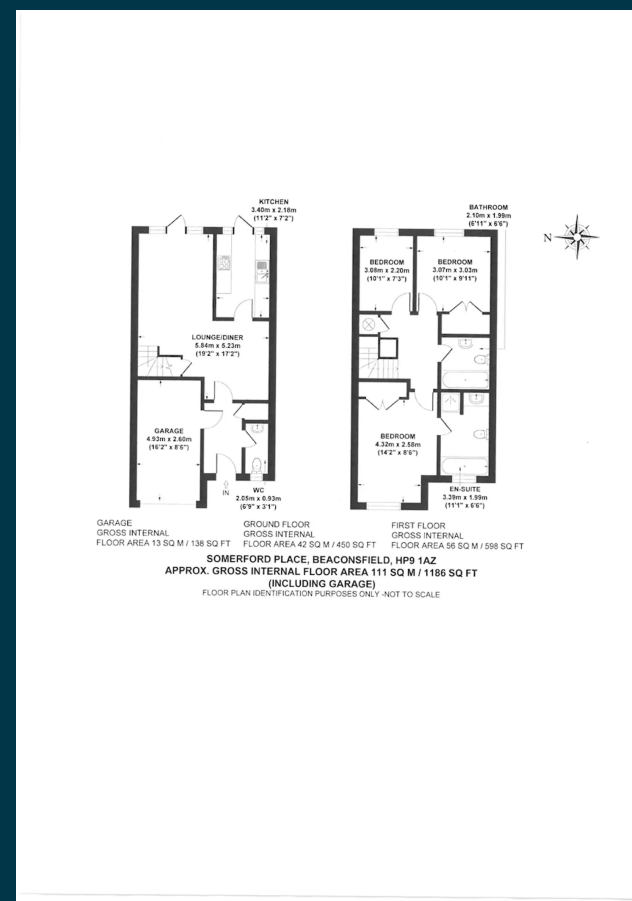

These particulars are for guidance only. They are prepared and issued in good faith and are intended to give a fair summary of the property. Any description should not be relied on as a statement or representation of fact or that the property, or its services, are in good condition. The photographs show only certain parts of the property at the time they were taken. Any areas, measurements or distance given are approximate only. Any reference to alterations to, or use of, any part of the property is not a statement that any necessary planning, building regulations or other consent has been obtained. These matters must be verified by an intending purchaser. All statements contained in these particulars in relation to the property are made without responsibility of Ashington Page or its clients. Neither Ashington Page (nor any joint agents) nor any of their employees has any authority to make or give any representation or warranty whatsoever in relation to the property

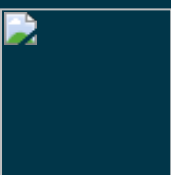

01494 680018
 info@ashingtonpage.co.uk
 www.AshingtonPage.co.uk

