



2 Bedroom First Floor Apartment

Saxon Close, Cricklade, Wiltshire, SN6 6LZ

Guide Price of £185,000

mcfarlane
property.com

Spacious 2 Bedroom Apartment Cricklade, North Wiltshire

- First Floor Apartment
- Spacious Accommodation
- Close to High Street & Amenities

- TWO BEDROOM FIRST FLOOR APARTMENT -
SOUGHT AFTER CRICKLADE POSITION - CLOSE TO
ALL AMENITIES - IDEAL FIRST PURCHASE OR
INVESTMENT -

A spacious first floor apartment located within easy reach of all local amenities, transport links and schools. The property includes spacious living accommodation to include Security Entrance, Hallway, Two Bedrooms, Lounge, Fitted Kitchen/Dining Room and Bathroom. Additionally, there is Gas Central Heating. Viewing is Essential.



mcfarlane
property.com

Owners Comments

Our client has caringly noted and improved 10 Saxon Close to include new living room carpets (Sept 21). New uPVC double glazing (2017). The central heating system is serviced annually and was replaced 2009 with the addition of a new shower and WC. The costings are favourable with Council tax banding of A and a maintenance charge of £77.61 per month. There was insulation added to the loft space recently in 2020.



We 
where you
LIVE



Ground Floor

Approx. 59.9 sq. metres (645.1 sq. feet)

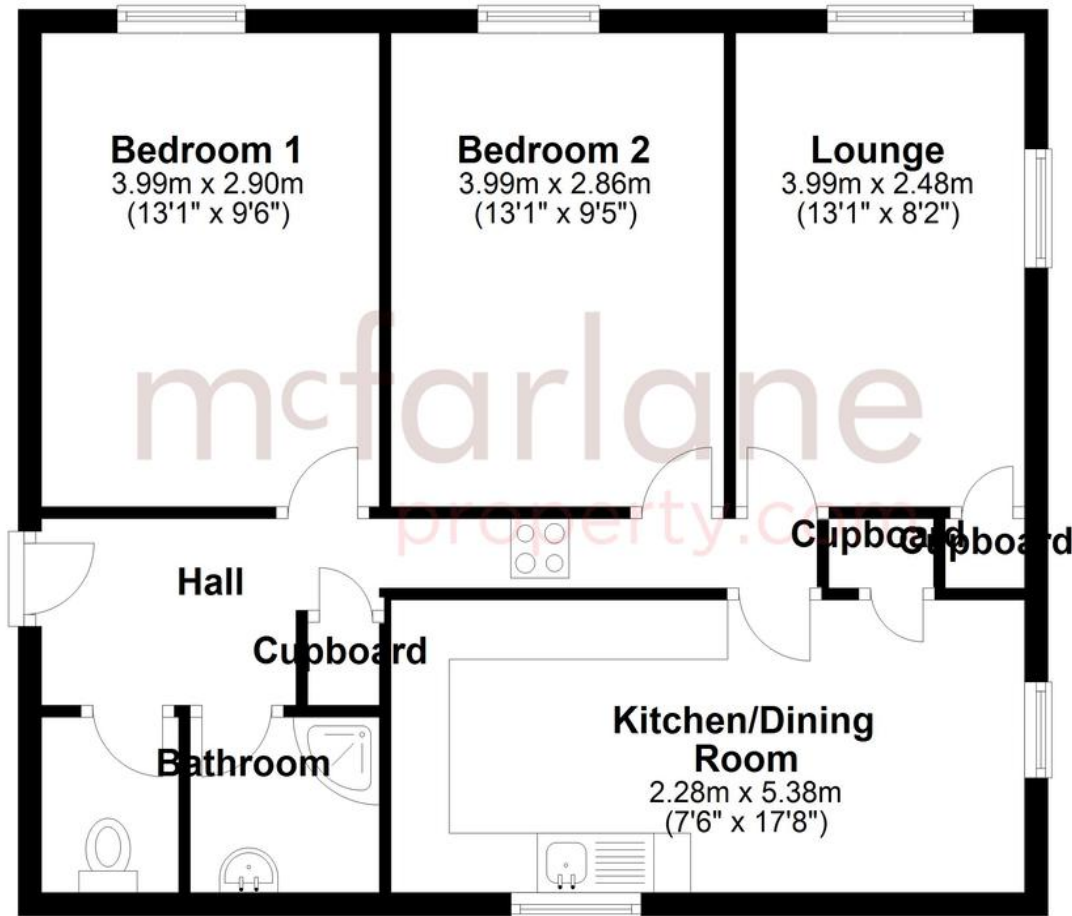

Total area: approx. 59.9 sq. metres (645.1 sq. feet)

We 
where you
LIVE

Our team are friendly, experienced and are all local. They know it better than they do their own living rooms and can help you find what you're looking for because **we love where we live.**

We would be delighted to show you around this property.

**Because every home
needs a personal touch.**

**If you would like to view this
property then please get in touch.**

📞 01793 751044

✉ cricklade@mcfarlaneproperty.com

mcfarlaneproperty.com

mcfarlane
property.com

Cricklade.

102 High Street
Cricklade SN6 6AA

📞 01793 751044

Marlborough.

106 High Street
Marlborough SN8 1LT

📞 01672 514380

Old Town.

28-30 Wood Street
Swindon SN1 4AB

📞 01793 296880

Swindon.

The Village Centre,
Redhouse SN25 2FW

📞 01793 296600

Agents Note: Whilst every care has been taken to prepare these sales particulars, they are for guidance purposes only. All measurements are approximate and are for general guidance purposes only and whilst every care has been taken to ensure their accuracy, they should not be relied upon and potential buyers are advised to recheck the measurements