



Property Summary

Immaculate semi detached home for sale on the ever popular Little Hill estate. The accommodation comprises entrance hall, lounge, kitchen diner, three bedrooms, four piece bathroom, Resin driveway, garage and low maintenance landscaped rear garden. This property is a real mustsee so call Phillips George today!



GROUND FLOOR
424 sq.ft. (39.4 sq.m.) approx.

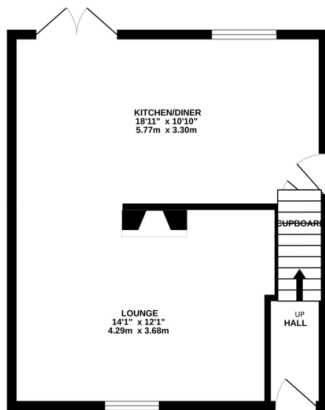

1ST FLOOR
428 sq.ft. (39.8 sq.m.) approx.

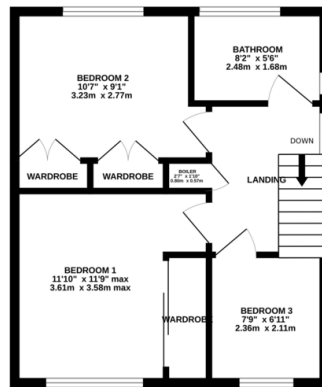

TOTAL FLOOR AREA: 852 sq.ft. (79.2 sq.m.) approx.
Whilst every attempt has been made to ensure the accuracy of the floorplan contained here, measurements of doors, windows, rooms and any other items are approximate and no responsibility is taken for any error, omission or mis-statement. This plan is for illustrative purposes only and should be used as such for any prospective purchase. The services, systems and appliances shown have not been tested and no guarantee as to their operability or efficiency can be given.
Made with Metropix C2023

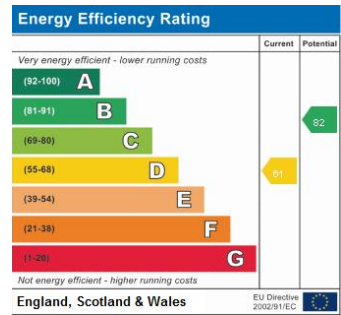

- Immaculate Throughout
- Landscaped Rear Garden
- Semi Detached
- Three Bedrooms
- Popular Location
- Kitchen Diner
- Garage
- Resin Drive

phillips george | sales & lettings

Agents Note: Whilst every care has been taken to prepare these sales particulars, they are for guidance purposes only. All measurements are approximate and for general guidance purposes only and whilst every care has been taken to ensure their accuracy, they should not be relied upon and potential buyers are advised to recheck the measurements

46 Long Street, Wigston, Leicestershire, LE18 2AH

info@phillipsgeorge.co.uk
0116 216 8178

