



Kinson Grove, Kinson, Bournemouth, Dorset

Kinson Grove, Dorset

Asking Price: £1,650 Per month

Corbin & Co are pleased to offer For Let this spacious three bedroom detached family home located in Kinson. The property consists of: GROUND FLOOR: Large front to rear lounge / dining room with french doors leading to the patio & garden * Modern fitted kitchen with back door access to the side of the property which leads you to the garage * UPSTAIRS: Two double bedrooms with wardrobes & single bedroom * Modern fitted bathroom with over the bath shower * Newly fitted grey carpet * Good size private rear garden mainly laid to lawn with added bonus of large summer house at the bottom of the garden which is fitted with electric and water * Off road parking for 2 cars * Available early July 2023 * Please call Corbin & Co 01202 519761 to arrange a viewing.

Corbin & Co , 1567-1569 Wimborne Road, Bournemouth, Dorset, BH10 7BB | 01202 519761
sales@corbinandco.com | www.corbinandco.com

VIEWING ARRANGEMENTS

By Appointment With: Corbin & Co
Tel: 01202 519761

OPENING HOURS:

Mon - Thur 9- 6 Friday 9 - 5 Sat 9 - 4

THINKING OF SELLING?

If you are thinking of selling your home or just curious to discover the value of your property, We would be pleased to provide free, no obligation sales and marketing advice. Even if your home is outside the area covered by our local offices we can arrange a Market Appraisal through our national network of estate agents.

DISCLAIMER

These particulars are intended to give a fair and reliable description of the property but no responsibility for any inaccuracy or error can be accepted and do not constitute an offer or contract. We have not tested any services or appliances (including central heating if fitted) referred to in these particulars and the purchasers are advised to satisfy themselves as to the working order and condition. If a property is unoccupied at any time there may be reconnection charges for any switched off/disconnected or drained services or appliances - All measurements are approximate.

OUTBUILDING
296 sq.ft. (27.5 sq.m.) approx.

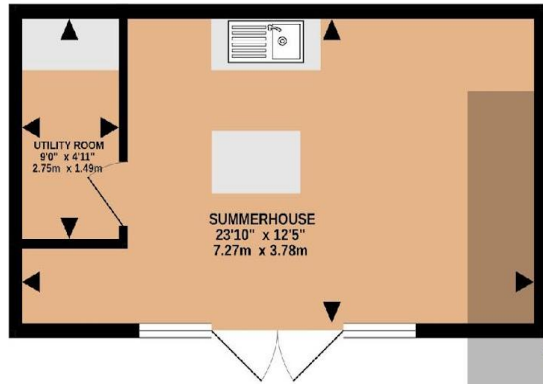

GROUND FLOOR
456 sq.ft. (42.3 sq.m.) approx.

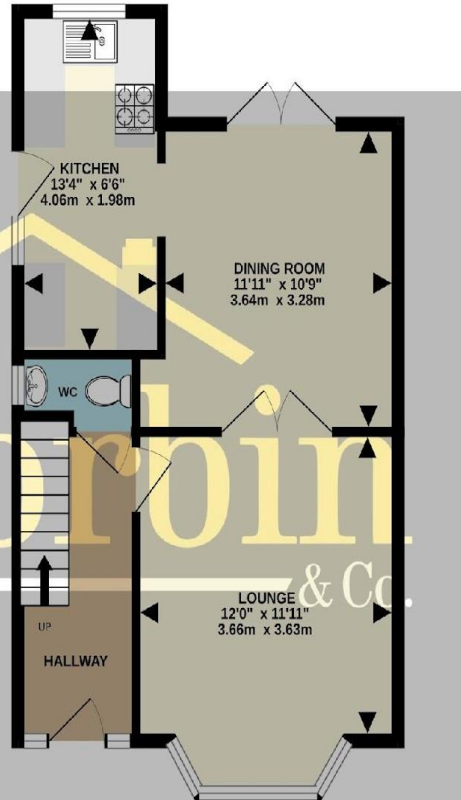

FIRST FLOOR
423 sq.ft. (39.3 sq.m.) approx.

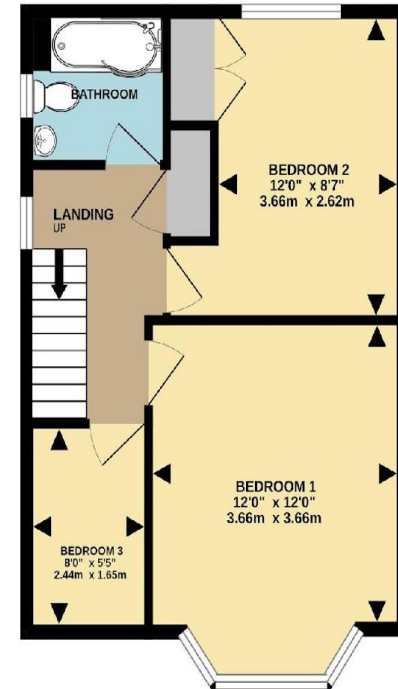

TOTAL FLOOR AREA : 1174 sq.ft. (109.1 sq.m.) approx.

Whilst every attempt has been made to ensure the accuracy of the floorplan contained here, measurements of doors, windows, rooms and any other items are approximate and no responsibility is taken for any error, omission or mis-statement. This plan is for illustrative purposes only and should be used as such by any prospective purchaser. The services, systems and appliances shown have not been tested and no guarantee as to their operability or efficiency can be given.

Made with Metropix ©2023



