

Compton

Shoreditch

Bonhill Building
EC2A 4DN

Newly refurbished fully fitted office space in the heart of Shoreditch with private terraces.

For Rent

12,925 to 26,424 ft²

020 7101 2020
compton.london



Compton

Shoreditch

Bonhill Building
EC2A 4DN

Newly refurbished fully fitted office space in the heart of Shoreditch with private terraces.

For Rent

12,925 to 26,424 ft²



Location

Bonhill Building is planted right in the heart of Shoreditch – just south of Old Street Station and North of Finsbury Square. And with the City a stroll around the corner, it really is the best of both worlds.

This is a great place to work, but it's just as good a place to play. Arts, culture, shopping, high-end dining, amazing street food scene... Bonhill Building puts you in touch with it all.

Compton

Shoreditch

Bonhill Building
EC2A 4DN

Newly refurbished fully fitted office space in the heart of Shoreditch with private terraces.

For Rent

12,925 to 26,424 ft²



Compton

Shoreditch

Bonhill Building
EC2A 4DN

Newly refurbished fully fitted office space in the heart of Shoreditch with private terraces.

For Rent

12,925 to 26,424 ft²



020 7101 2020
compton.london

CGI - Courtyard

Compton

Shoreditch

Bonhill Building
EC2A 4DN

Newly refurbished fully fitted office space in the heart of Shoreditch with private terraces.

For Rent

12,925 to 26,424 ft²

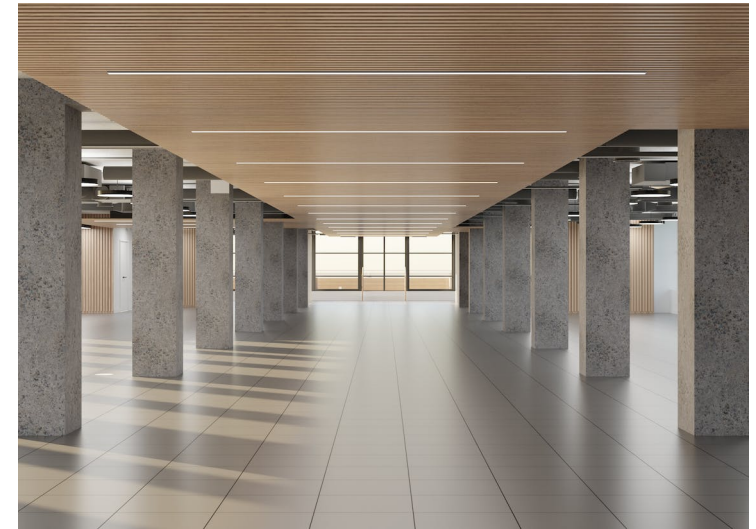

Compton

Shoreditch

Bonhill Building
EC2A 4DN

Newly refurbished fully fitted office space in the heart of Shoreditch with private terraces.

For Rent

12,925 to 26,424 ft²

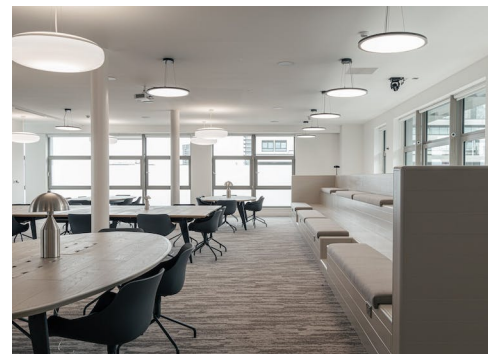

Shoreditch

Bonhill Building
EC2A 4DN

Newly refurbished fully fitted office space in the heart of Shoreditch with private terraces.

For Rent

12,925 to 26,424 ft²

Amenities

- Excellent natural light
- 24 hour access & security
- Exposed concrete finishes
- VRF air conditioning
- Raised floors
- 4 x passenger lifts
- Goods lift
- Newly refurbished reception
- Secure bike storage & showers
- 4th & 5th floors benefit from roof terraces
- Car parking available

Description

15 Bonhill Street offers excellent accommodation in a prime City location situated within the thriving tech city district of Shoreditch and a short walk away from Old Street, Shoreditch High Street, Moorgate and Liverpool Street stations.

The property benefits from an impressive, newly refurbished reception area and outstanding views over the City of London via the roof terraces provided on the 4th and 5th floors.

Compton

Shoreditch

Bonhill Building
EC2A 4DN

Newly refurbished fully fitted office space in the heart of Shoreditch with private terraces.

For Rent

12,925 to 26,424 ft²

Content

[View on Website](#)



Compton

Shoreditch

Bonhill Building
EC2A 4DN

Newly refurbished fully fitted office space in the heart of Shoreditch with private terraces.

For Rent

12,925 to 26,424 ft²

Floor Areas & Outgoings

The accommodation comprises the following areas:

Name	sq ft	Rent (sq ft)	Rates Payable (sq ft)	Service Charge (sq ft)	Total /sq ft	Total month	Total year	Availability
5th - Fully Fitted	12,925	£74.50	£22	£14.99	£111.49	£120,084.02	£1,441,008.25	Available
4th	13,499	£69.50	£22	£14.99	£106.49	£119,792.38	£1,437,508.51	Available
Total	26,424	£72	£22	£14.99	£108.99	£239,876.40	£2,878,516.76	

Compton

Contact Us

All appointments to view must be arranged via sole agents, Compton, through —

Jake Kinsler
jk@compton.london
07840 638668

Shaun Simons
ss@compton.london
07788 423131

