



Jackman Close, Abingdon

Abingdon

Simpsons

The Proactive Agent

In Excess of **£185,000**



SCAN THE
QR CODE
FOR DETAILS



521 sq.ft. (48.4 sq.m.) approx.

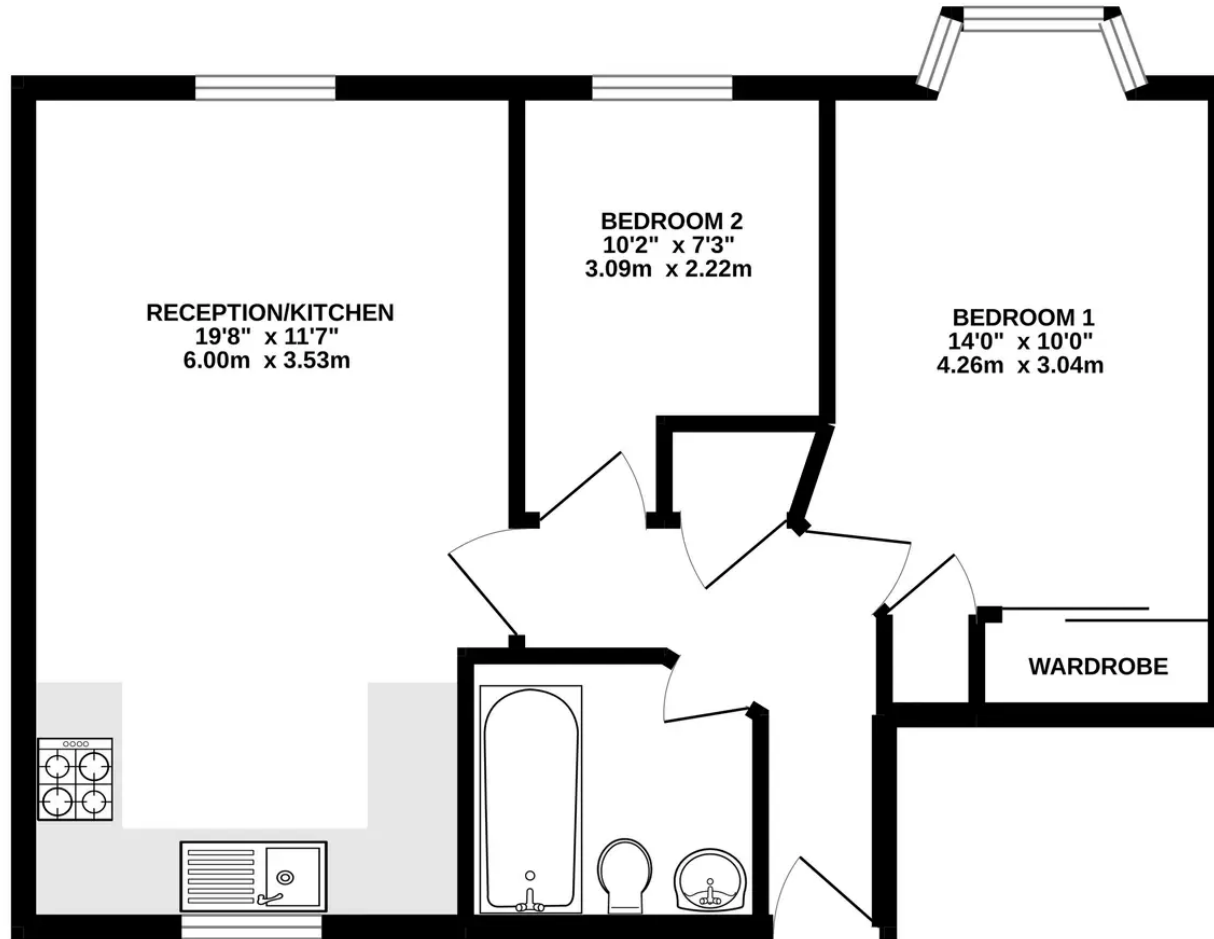

TOTAL FLOOR AREA : 521 sq.ft. (48.4 sq.m.) approx.

Whilst every attempt has been made to ensure the accuracy of the floorplan contained here, measurements of doors, windows, rooms and any other items are approximate and no responsibility is taken for any error, omission or mis-statement. This plan is for illustrative purposes only and should be used as such by any prospective purchaser. The services, systems and appliances shown have not been tested and no guarantee as to their operability or efficiency can be given.
Made with Metropix ©2022

120 Jackman Close

Abingdon, Abingdon

Purchase with a tenant in situ, yielding 5%+. This first-floor apartment is situated in the popular development of Jackman Close, and is within easy reach of the town centre along with many nearby amenities.

Council Tax band: C

Tenure: Leasehold

- Extendable 68 year leasehold term (please ask for more detail)
- Ground rent £200 per year, Service Charge £1435 per year
- Investors Only
- Two Bedrooms
- Allocated Parking
- First Floor Apartment



SCAN THE
QR CODE
TO BOOK
YOUR VIEWING



