



Whitecross, Abingdon

Abingdon

Simpsons

The Proactive Agent

£497,500



SCAN THE
QR CODE
FOR DETAILS



Approximate Gross Internal Area
Ground Floor = 78.5 sq m / 845 sq ft
First Floor = 60.2 sq m / 648 sq ft
Total = 138.7 sq m / 1,493 sq ft

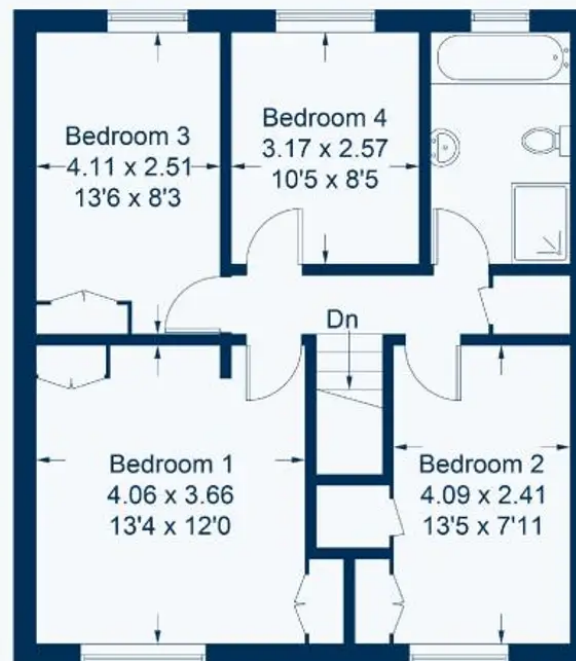

Ground Floor

First Floor

This plan is for layout guidance only. Not drawn to scale unless stated. Windows and door openings are approximate. Whilst every care is taken in the preparation of this plan, please check all dimensions, shapes and compass bearings before making any decisions reliant upon them.

Whitecross

Abingdon, Abingdon

This modernised family home is located on the outskirts of Abingdon and enjoys stunning views over Boars Hill. Benefitting from four well proportioned bedrooms, a garden room extension and useful downstairs WC.

Council Tax band: E

Tenure: Freehold

- Modern kitchen/breakfast room with granite worksurfaces.
- Four piece bathroom suite with walk in shower.
- Newly laid carpets and flooring throughout.
- Utility/WC.
- Fully insulated garden home office with heating, light, power and new roof.



SCAN THE
QR CODE
TO BOOK
YOUR VIEWING



