



# Whitecross, Abingdon

Abingdon

**Simpsons**

The Proactive Agent

£497,500



SCAN THE  
QR CODE  
FOR DETAILS



Approximate Gross Internal Area  
Ground Floor = 78.5 sq m / 845 sq ft  
First Floor = 60.2 sq m / 648 sq ft  
Total = 138.7 sq m / 1,493 sq ft

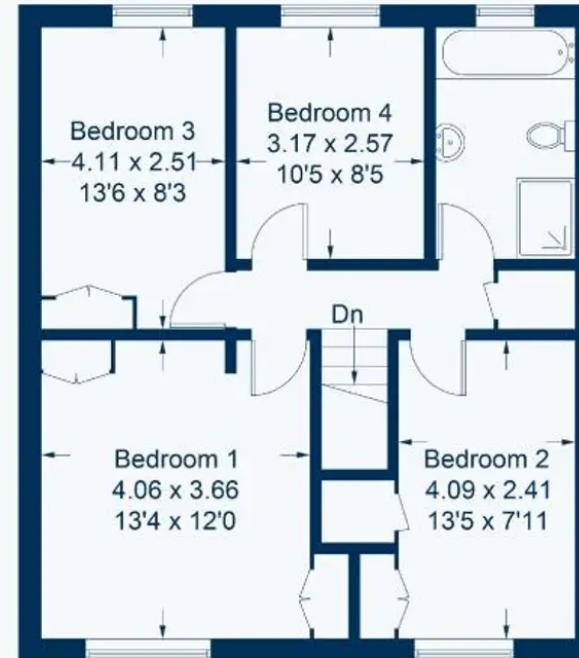

### Ground Floor

### First Floor

This plan is for layout guidance only. Not drawn to scale unless stated. Windows and door openings are approximate. Whilst every care is taken in the preparation of this plan, please check all dimensions, shapes and compass bearings before making any decisions reliant upon them.

# Whitecross

Abingdon, Abingdon

This modernised family home is located on the outskirts of Abingdon and enjoys stunning views over Boars Hill. Benefitting from four well proportioned bedrooms, a garden room extension and useful downstairs WC.

Council Tax band: E

Tenure: Freehold

- Modern kitchen/breakfast room with granite worksurfaces.
- Four piece bathroom suite with walk in shower.
- Newly laid carpets and flooring throughout.
- Utility/WC.
- Fully insulated garden home office with heating, light, power and new roof.
- Electric garage door.



SCAN THE  
QR CODE  
**TO BOOK**  
YOUR VIEWING



