



Borough Walk, Abingdon

Guide Price £275,000

Abingdon

Simpsons

The Proactive Agent



SCAN THE
QR CODE
FOR DETAILS



GROUND FLOOR
295 sq.ft. (27.4 sq.m.) approx.

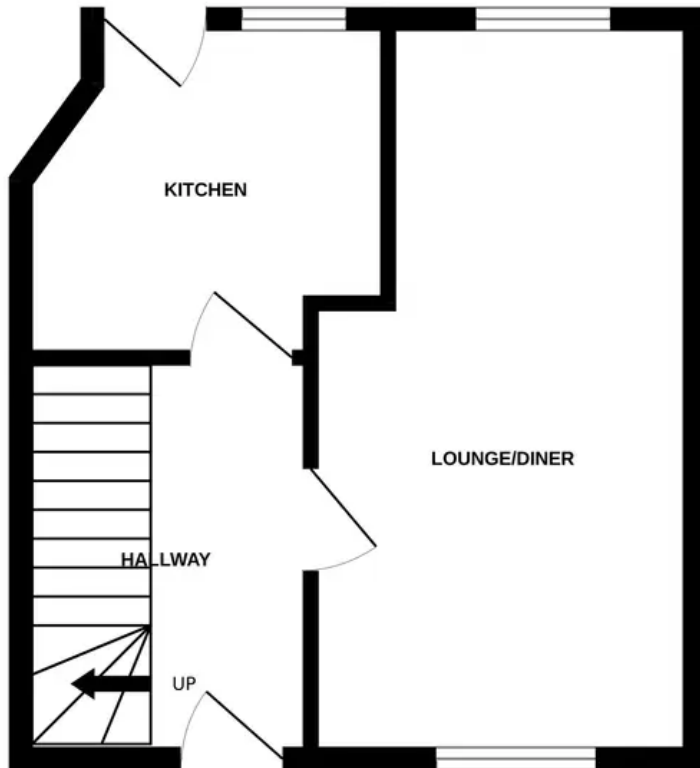

1ST FLOOR
299 sq.ft. (27.8 sq.m.) approx.

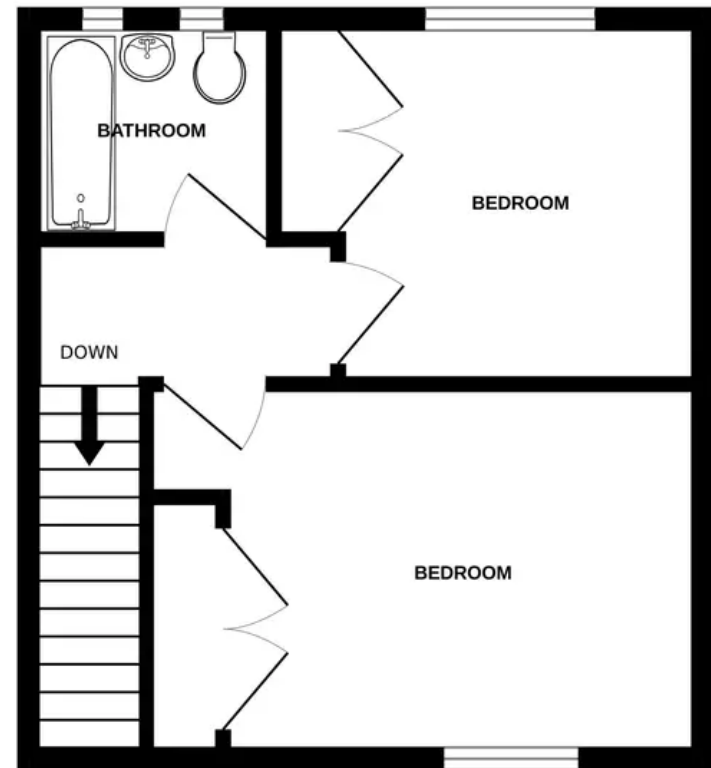

TOTAL FLOOR AREA : 594 sq.ft. (55.2 sq.m.) approx.

Whilst every attempt has been made to ensure the accuracy of the floorplan contained here, measurements of doors, windows, rooms and any other items are approximate and no responsibility is taken for any error, omission or mis-statement. This plan is for illustrative purposes only and should be used as such by any prospective purchaser. The services, systems and appliances shown have not been tested and no guarantee as to their operability or efficiency can be given.
Made with Metropix ©2023

8 Borough Walk

Abingdon, Abingdon

No onward chain - A rarely available home with scope to extend, improve and add value.

Council Tax band: C

Tenure: Freehold

- Two double bedrooms.
- Modern white kitchen units.
- Potential to extend under permitted development.
- Double glazing.
- Gas central heating.
- No onward chain.



SCAN THE
QR CODE
TO BOOK
YOUR VIEWING



