



Kimberley Street, Coppull

Chorley

£675 pcm



Well presented bay fronted mid terrace with two bedrooms and new bathroom available to let now.

This spacious two bedroom property is close to all local amenities and transport links, it is perfect for a young family or professional couple. The ground floor comprises of a good sized living room with bay window, gas fire and surround. To the rear of the property is a second reception room making an ideal dining area perfect for entertaining family and friends.

Off the dining to the rear elevation is a kitchen extension, equipped with a range of wall and base units, space for Fridge Freezer plus an electric oven and hob.

The first floor hosts two good size bedrooms both neatly decorated and offer substantial space, perfect for accommodating large bedroom furniture. The newly fitted bathroom is equipped with WC, wash basin, and panelled bath with shower over. There is new carpets and flooring throughout.

The property is garden fronted and a rear low maintenance yard with access to the rear for bins and on street parking to the front.



The property is available now and requires a deposit of £775 including holding deposit of £155. The Zero Deposit Scheme is also available.

Council Tax Band: A

EPC Rating: D

- Two bedrooms
- Two reception rooms
- New bathroom
- Enclosed yard to rear
- Zero Deposit Scheme available
- Available now



**Eccleston Branch**

265 The Green, Eccleston, PR7 5TF  
01257 451673

**Coppull Branch**

244 Spendmore Lane, Coppull, PR7 5DE  
01257 794588

[www.hometruthslancs.co.uk](http://www.hometruthslancs.co.uk)  
[office@hometruthslancs.co.uk](mailto:office@hometruthslancs.co.uk)



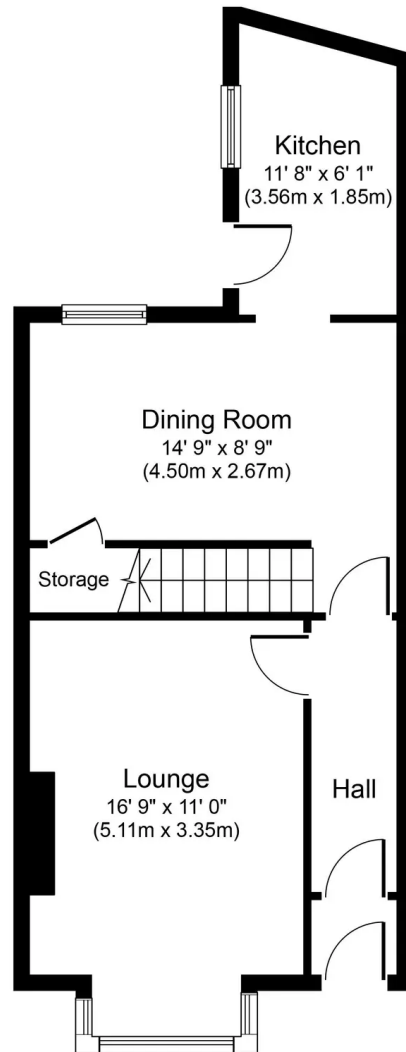

**Ground Floor**  
**Approximate Floor Area**  
**473 sq. ft.**  
**(43.9 sq. m.)**

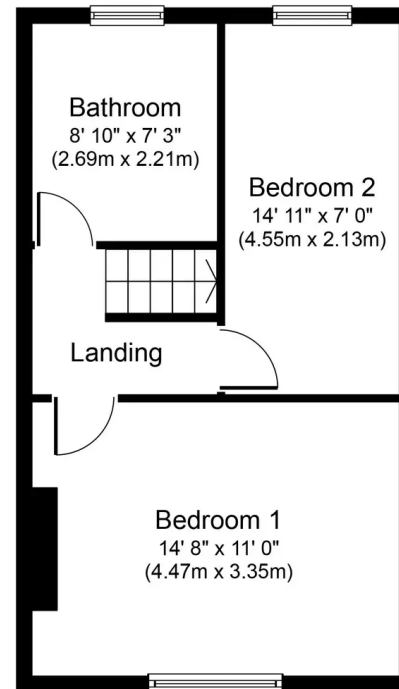

**First Floor**  
**Approximate Floor Area**  
**388 sq. ft.**  
**(36.0 sq. m.)**

Whilst every attempt has been made to ensure the accuracy of the floor plan contained here, measurements of doors, windows, rooms and any other items are approximate and no responsibility is taken for any error, omission, or mis-statement. This plan is for illustrative purposes only and should be used as such by any prospective purchaser or tenant. The services, systems and appliances shown have not been tested and no guarantee as to their operability or efficiency can be given.