



2 Bedroom Semi-Detached Offers Over £210,000

39 Bilborough Drive, Walcot, Swindon, Wiltshire , SN3 2GZ

mcfarlane
property.com

2 Bedroom Semi-Detached Bilborough Drive, East Swindon

- TWO DOUBLE BEDROOMS
- SEMI-DETACHED HOUSE
- ENCLOSED REAR GARDEN
- ALLOCATED PARKING

- TWO DOUBLE BEDROOMS - SEMI-DETACHED HOME - ALLOCATED PARKING - CLOSE TO AMENITIES - NEWLY FITTED BATHROOM -

This two bedroom semi-detached home is an ideal first time buy or investment, offering two double bedrooms alongside a spacious lounge/diner, kitchen, cloakroom and a newly fitted bathroom. Externally, the property further benefits from an enclosed rear garden featuring both lawn and patio areas with gated access to the rear. Various amenities such as schools and shops are all within walking distance as well as various bus routes and easy access to the A419. Viewings are highly recommended.



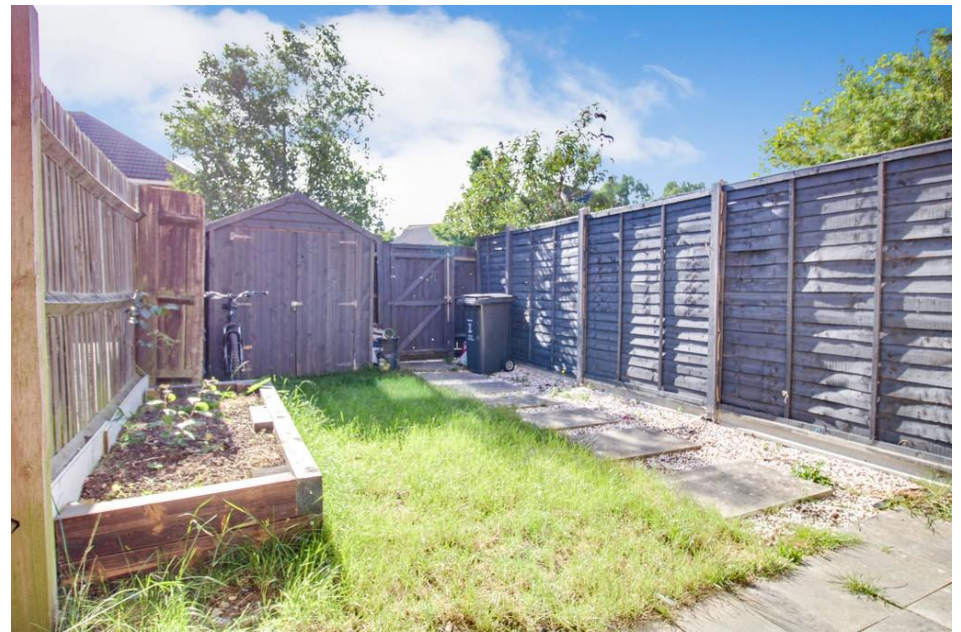

Ground Floor
Approx. 31.6 sq. metres (339.7 sq. feet)

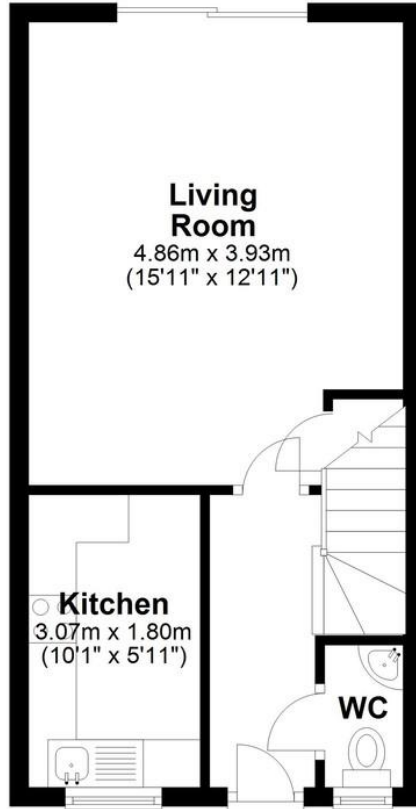

First Floor
Approx. 31.1 sq. metres (334.3 sq. feet)

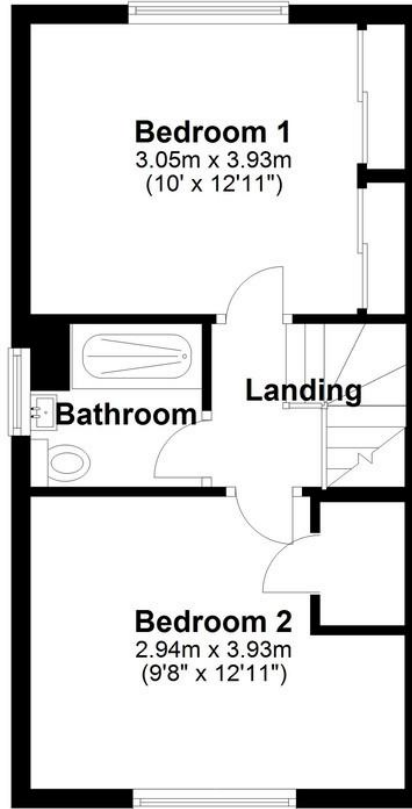

Total area: approx. 62.6 sq. metres (674.0 sq. feet)

We 
where you
LIVE

Our team are friendly, experienced and are all local. They know it better than they do their own living rooms and can help you find what you're looking for because **we love where we live.**

We would be delighted to show you around this property.

Because every home needs a personal touch.

If you would like to view this property then please get in touch.

 01793 296600

 swindon@mcfarlaneproperty.com

mcfarlaneproperty.com

mcfarlane
property.com

Cricklade.
102 High Street
Cricklade SN6 6AA
 01793 751044

Marlborough.
106 High Street
Marlborough SN8 1LT
 01672 514380

Old Town.
28-30 Wood Street
Swindon SN1 4AB
 01793 296880

Swindon.
The Village Centre,
Redhouse SN25 2FW
 01793 296600

Agents Note: Whilst every care has been taken to prepare these sales particulars, they are for guidance purposes only. All measurements are approximate are for general guidance purposes only and whilst every care has been taken to ensure their accuracy, they should not be relied upon and potential buyers are advised to recheck the measurements