



HELLIER
LANGSTON

Commercial Property Consultants

TO LET

High quality office suites with excellent parking
First Floor, East Wing, Southern House, Sparrowgrove,
Otterbourne, Winchester SO21 2RU



KEY FEATURES

**Modern office suite in
beautiful parkland setting**

7,155 sq ft (664.7 sq m)

Car parking ratio of 1:123 sq ft

Part Air Conditioned

**Use of up to 18 EV charging
points**

**Mainly open plan
accommodation**

Call us on: **02382 022 111**
Visit: **www.hlp.co.uk**

Hellier Langston

Enterprise House, Ocean Village
Southampton SO14 3XB

TO LET

First Floor, East Wing, Southern House, Sparrowgrove, Otterbourne, Winchester SO21 2RU

Description

Southern House provides approximately 2,873 sq m (30,929 sq ft) of self-contained office accommodation in two wings, one of three storeys and the other of two storeys. The property is set within an attractive parkland site that extends to 2.39 hectares (5.91 acres).

The building, originally constructed in the 1980's, has undergone substantial refurbishment to include re-roofing and the upgrading of the common parts.

The property is constructed in a L-shape with a central service core containing a ground floor reception and a canteen. Owing to nature of the site the north wing comprises office accommodation on the first floor and on a second floor mezzanine, whilst the east wing provides office accommodation on the ground and first floors levels with a second floor mezzanine.

All of the floors are accessible from the central core with additional staircases from the first floors to the mezzanine levels. The property provides open plan, flexible accommodation benefitting from good natural light.

Accommodation

The property has been measured to Net Internal Area as follows:

Floor	sq m	sq ft
East Wing, First Floor	664.7	7,155

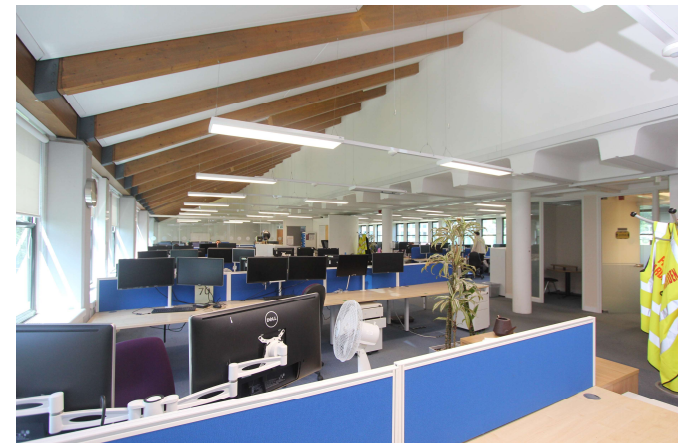

Call us on: 02382 022 111 Visit: www.hlp.co.uk

TO LET

First Floor, East Wing, Southern House, Sparrowgrove, Otterbourne, Winchester SO21 2RU

EPC
C-72

Terms

The premises are available as a whole, or floor by floor on new effectively Full Repairing and Insuring lease(s) for a term to be agreed

Rent

£17.60 sq ft

Business Rates

The premises are currently is two separate assessments with a main rate of £125.98 sq m (£11.70 sq ft) making 2023/24 rates payable £5.99 sq ft (Source: tax.service.gov.uk)

Service Charge

There is a service charge for the communal running costs of the building together with estate management. Further information available upon request.

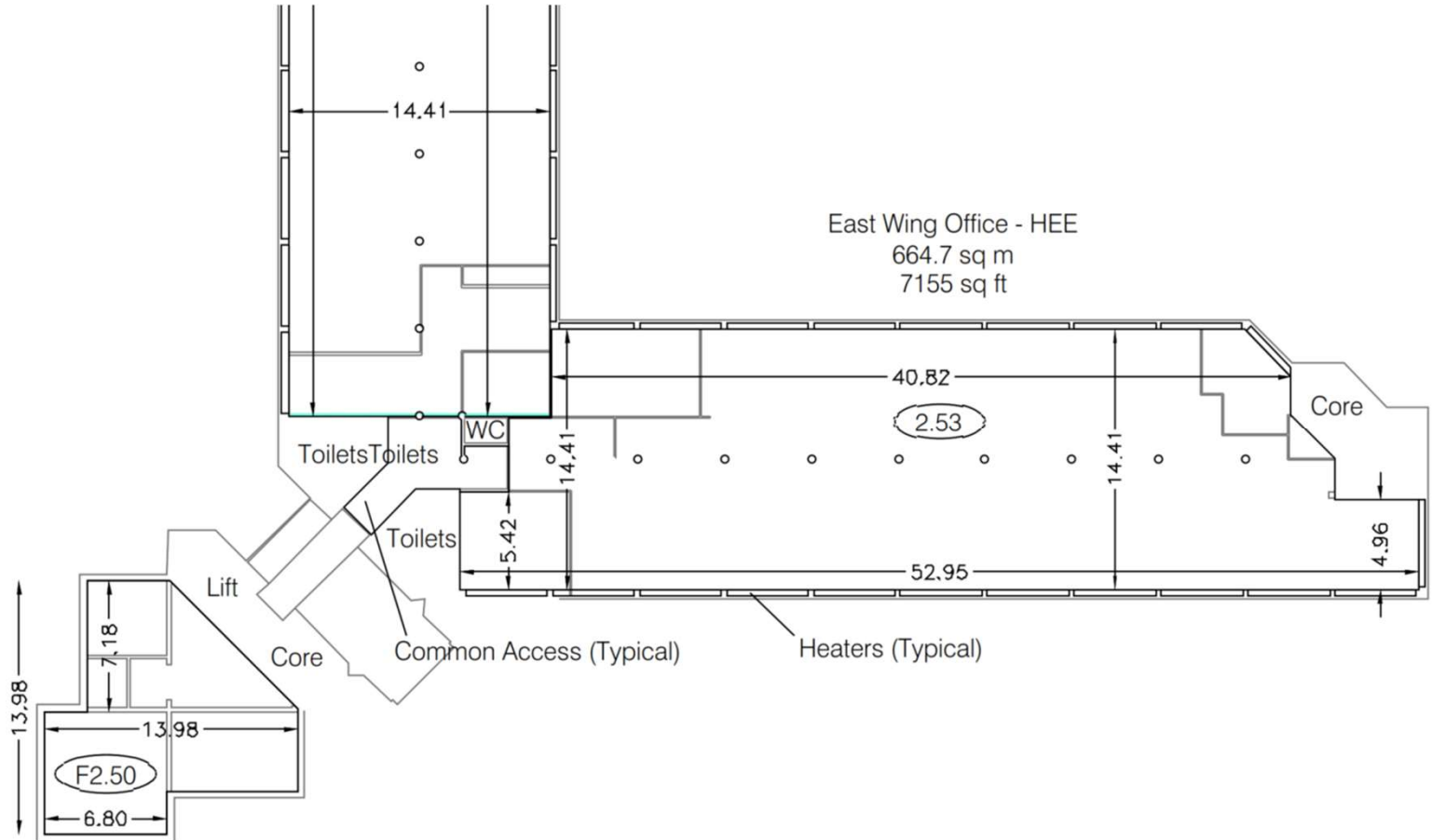

Call us on: 02382 022 111 Visit: www.hlp.co.uk

TO LET

First Floor, East Wing, Southern House, Sparrowgrove, Otterbourne, Winchester SO21 2RU



Call us on: 02382 022 111 Visit: www.hlp.co.uk

TO LET

First Floor, East Wing, Southern House, Sparrowgrove, Otterbourne, Winchester SO21 2RU



Call us on: 02382 022 111 Visit: www.hlp.co.uk

TO LET

First Floor, East Wing, Southern House, Sparrowgrove, Otterbourne, Winchester SO21 2RU

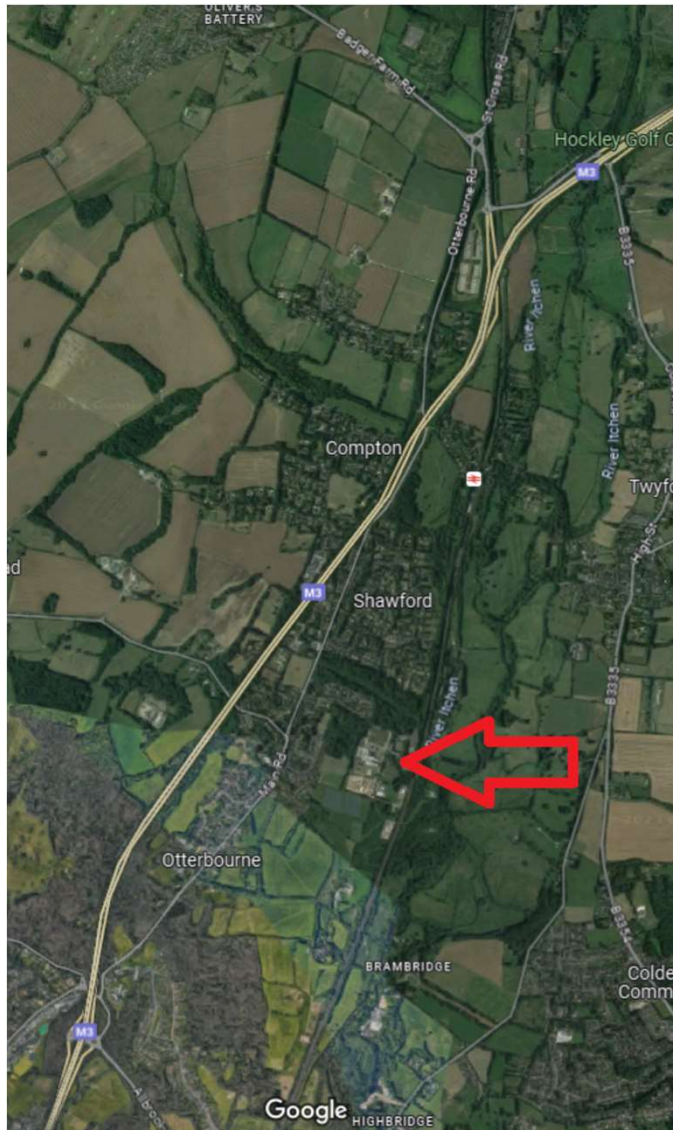

Location

Southern House is located just off the Otterbourne Road, conveniently positioned within 5 minutes' drive of both Junctions 11 and 12 of the M3 motorway. Winchester City Centre is 6 km (4 miles) north of the subject property. Public transport links to the City centre are good with a regular bus service and frequent commuter rail services from the nearby railway station of Shawford, which is on the London to Southampton line.

The property is accessed via Sparrowgrove and onto Waterworks Road which run through a high quality and desirable residential area.

Location	Miles	Kms
Junction 12 M3	5	8
Junction 11 M3	2.5	4
Southampton International Airport and Parkway Station	5.3	8.5

Viewing

Strictly by appointment with the sole agents:

Call us on: 02382 022 111 Visit: www.hlp.co.uk



Jason Webb
m: 07989 959064
e: jason@hlp.co.uk

Hellier Langston
Enterprise House
Ocean Village
Southampton
SO14 3XB
02382 022 111
www.hlp.co.uk



HELLIER LANGSTON
Commercial Property Consultants

02382 022 111
www.hlp.co.uk

Disclaimer: Hellier Langston Limited and its subsidiaries and their joint agents if any ("HL") for themselves and for the seller or landlord of the property whose agents they are give notice that: (i) These particulars are given and any statement about the property is made without responsibility on the part of HL or the seller or landlord and do not constitute the whole or any part of an offer or contract. (ii) Any description, dimension, distance or area given or any reference made to condition, working order or availability of services or facilities, fixtures or fittings, any guarantee or warranty or statutory or any other permission, approval or reference to suitability for use or occupation, photograph, plan, drawing, aspect or financial or investment information or tenancy and title details or any other information set out in these particulars or otherwise provided shall not be relied on as statements or representations of fact or at all and any prospective buyer or tenant must satisfy themselves by inspection or otherwise as to the accuracy of all information or suitability of the property. (iii) No employee of HL has any authority to make or give any representation or warranty arising from these particulars or otherwise or enter into any contract whatsoever in relation to the property in respect of any prospective purchase or letting including in respect of any resale potential or value or at all. (iv) Price or rent may be subject to VAT and any prospective buyer or tenant must satisfy themselves concerning the correct VAT position. (v) Except in respect of death or personal injury caused by the negligence of HL or its employees or agents, HL will not be liable, whether in negligence or otherwise howsoever, for any loss arising from the use of these particulars or any information provided in respect of the property save to the extent that any statement or information has been made or given fraudulently by HL. (vi) In the case of new development or refurbishment prospective buyers or tenants should not rely on any artists' impressions or architects' drawings or specification or scope of works or amenities, infrastructure or services or information concerning views, character or appearance and timing concerning availability or occupation and prospective buyers or tenants must take legal advice to ensure that any expectations they may have are provided for direct with the seller or landlord and HL shall have no liability whatsoever concerning any variation or discrepancy in connection with such matters.