



5 Bedroom End Terraced House Offers Over **£325,000**

1 Mycroft Road, Haydon End, Swindon, Wiltshire, SN25 1SP

**mcfarlane**  
property.com



## 5 Bedroom End Terraced House Mycroft Road, Haydon End

- FIVE GOOD SIZE BEDROOMS
- SOUTH FACING GARDEN
- GATED ENTRANCE
- GARAGE & DRIVEWAY PARKING

NO ONWARD CHAIN - SOUGHT AFTER  
LOCATION - SOUTH FACING GARDEN - FIVE  
GOOD SIZE BEDROOMS - GARAGE &  
DRIVEWAY PARKING - MUST BE VIEWED

McFarlane are delighted to offer this spacious end-terraced home situated in the popular area of Haydon End to the North of Swindon. Just a short distance from local shops, schools and transport links, this property briefly comprises of entrance hall, spacious living room, separate fitted kitchen, downstairs WC, master bedroom with dressing area with en-suite, four additional bedrooms and a modern family bathroom. Further benefits include an enclosed low maintenance garden, garage with driveway parking and gas central heating. Offered to the market with NO ONWARD CHAIN!







We   
where you  
**LIVE**

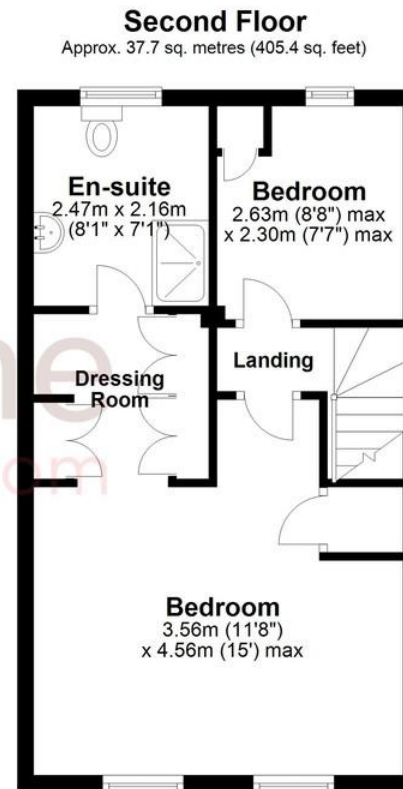
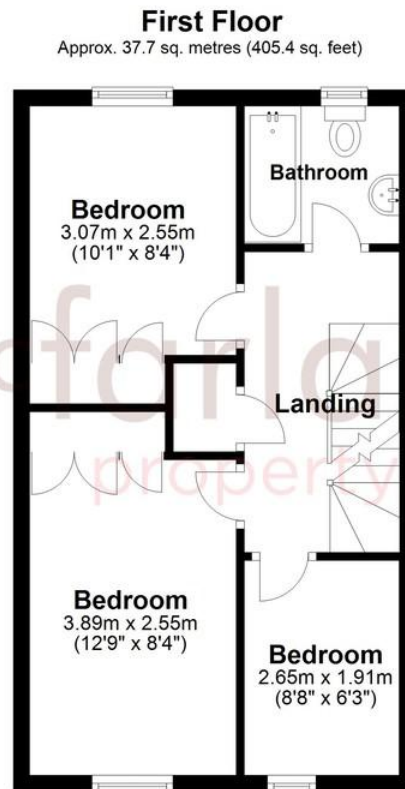

Total area: approx. 113.7 sq. metres (1224.0 sq. feet)

Our team are friendly, experienced and are all local. They know it better than they do their own living rooms and can help you find what you're looking for because **we love where we live.**

We would be delighted to show you around this property.

**Because every home needs a personal touch.**

**If you would like to view this property then please get in touch.**

📞 01793 296600

✉ swindon@mcfarlaneproperty.com

[mcfarlaneproperty.com](http://mcfarlaneproperty.com)

**mcfarlane**  
property.com

**Cricklade.**

102 High Street  
Cricklade SN6 6AA

📞 01793 751044

**Marlborough.**

106 High Street  
Marlborough SN8 1LT

📞 01672 514380

**Old Town.**

28-30 Wood Street  
Swindon SN1 4AB

📞 01793 296880

**Swindon.**

The Village Centre,  
Redhouse SN25 2FW

📞 01793 296600

Agents Note: Whilst every care has been taken to prepare these sales particulars, they are for guidance purposes only. All measurements are approximate are for general guidance purposes only and whilst every care has been taken to ensure their accuracy, they should not be relied upon and potential buyers are advised to recheck the measurements