



3 Bedroom House **£275,000**

6 Little Avenue, Swindon, SN2 1NL

mcfarlane
property.com

3 Bedroom House

Swindon Town Centre

-
- Semi-Detached
 - No Onward Chain
 - Three Reception Rooms
-

*** NO ONWARD CHAIN*** Three bedroom semi-detached property which has been extended to now provide three reception rooms, three bedrooms, kitchen, shower room and cloakroom. Large garden, garage and driveway parking.



Property description

A spacious three bedroom family home which has been extended to the ground floor. Open plan sitting room/dining room with box bay to the front. Kitchen with a range of base and eye level units and space for white goods. Door to rear garden. Also to the ground floor there is a snug/family room and cloakroom with basin and WC. To the first floor there are two double bedrooms and a single bedroom/ office. The modern shower room has a double walk in shower, basin and WC.





Ground Floor

Approx. 45.6 sq. metres (491.2 sq. feet)

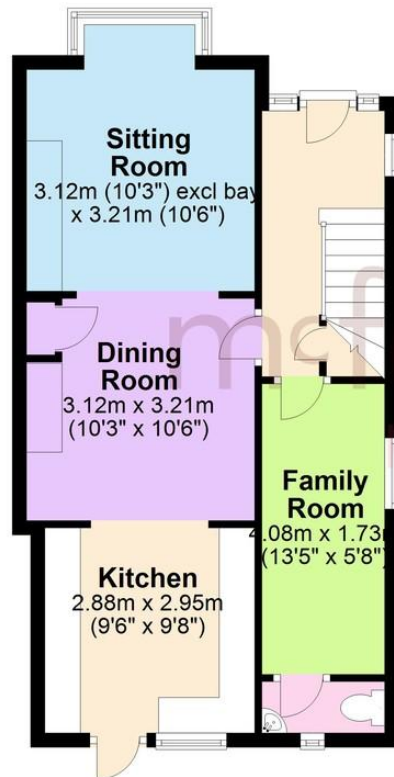

Total area: approx. 77.6 sq. metres (835.0 sq. feet)

First Floor

Approx. 31.9 sq. metres (343.8 sq. feet)

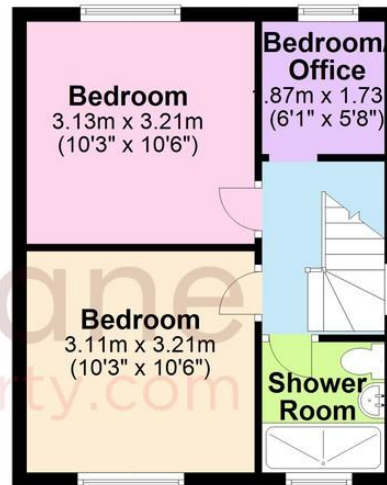

We 
where you
LIVE

Our team are friendly, experienced and are all local. They know it better than they do their own living rooms and can help you find what you're looking for because **we love where we live.**

We would be delighted to show you around this property.

**Because every home
needs a personal touch.**

**If you would like to view this
property then please get in touch.**

📞 01793 296880

✉️ oldtown@mcfarlaneproperty.com

mcfarlaneproperty.com

mcfarlane
property.com

Cricklade.

102 High Street
Cricklade SN6 6AA

📞 01793 751044

Marlborough.

106 High Street
Marlborough SN8 1LT

📞 01672 514380

Old Town.

28-30 Wood Street
Swindon SN1 4AB

📞 01793 296880

Swindon.

The Village Centre,
Redhouse SN25 2FW

📞 01793 296600

Agents Note: Whilst every care has been taken to prepare these sales particulars, they are for guidance purposes only. All measurements are approximate are for general guidance purposes only and whilst every care has been taken to ensure their accuracy, they should not be relied upon and potential buyers are advised to recheck the measurements