



3 Bedroom House £305,000

35 Vistula Crescent, Haydon End, Swindon, SN25 1QG

mcfarlane
property.com

3 Bedroom House

Haydon End, North Swindon

-
- No Chain
 - End Terrace
 - Three Bedrooms
-

****NO CHAIN**** Situated in the popular location of Haydon End is this **LARGER THAN AVERAGE** David Wilson built **THREE BEDROOM** end terrace family home. The property benefits from a spacious living room and kitchen/dining room. Master bedroom with dressing area plus en suite, **NON OVERLOOKED GARDEN** and driveway parking leading to a single garage next to the property. The Orbital Shopping Centre is within walking distance and schooling plus easy access to junction 15 of the M4.









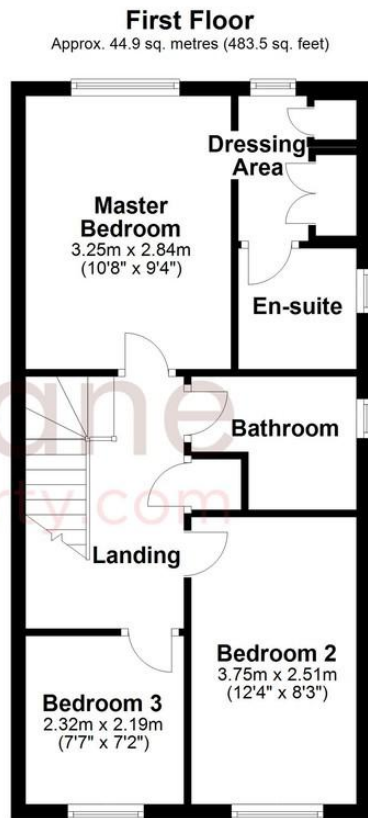
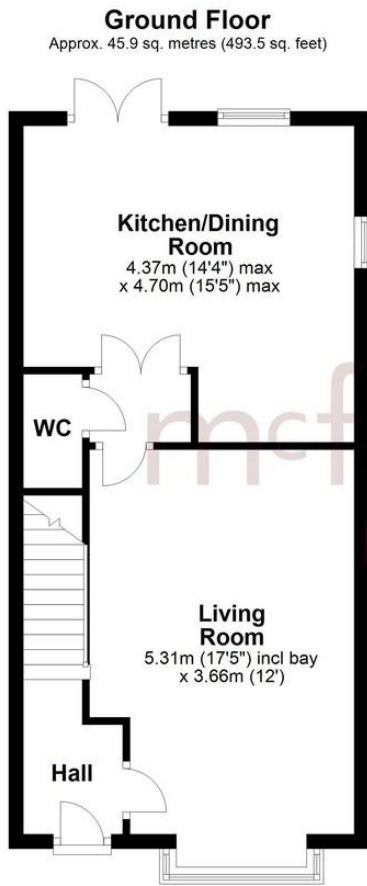

Total area: approx. 90.8 sq. metres (977.0 sq. feet)

We 
where you
LIVE

Our team are friendly, experienced and are all local. They know it better than they do their own living rooms and can help you find what you're looking for because **we love where we live.**

We would be delighted to show you around this property.

**Because every home
needs a personal touch.**

**If you would like to view this
property then please get in touch.**

📞 01793 296880

✉️ oldtown@mcfarlaneproperty.com

mcfarlaneproperty.com

mcfarlane
property.com

Cricklade.
102 High Street
Cricklade SN6 6AA
📞 01793 751044

Marlborough.
106 High Street
Marlborough SN8 1LT
📞 01672 514380

Old Town.
28-30 Wood Street
Swindon SN1 4AB
📞 01793 296880

Swindon.
The Village Centre,
Redhouse SN25 2FW
📞 01793 296600

Agents Note: Whilst every care has been taken to prepare these sales particulars, they are for guidance purposes only. All measurements are approximate are for general guidance purposes only and whilst every care has been taken to ensure their accuracy, they should not be relied upon and potential buyers are advised to recheck the measurements