

Expansive First Floor Apartment

Neighbourhood Centre, Highdown Way, St Andrews Ridge, Swindon, SN25 4FD

Guide Price £125,000

**mcfarlane**  
property.com

## First Floor

Approx. 82.0 sq. metres (882.9 sq. feet)

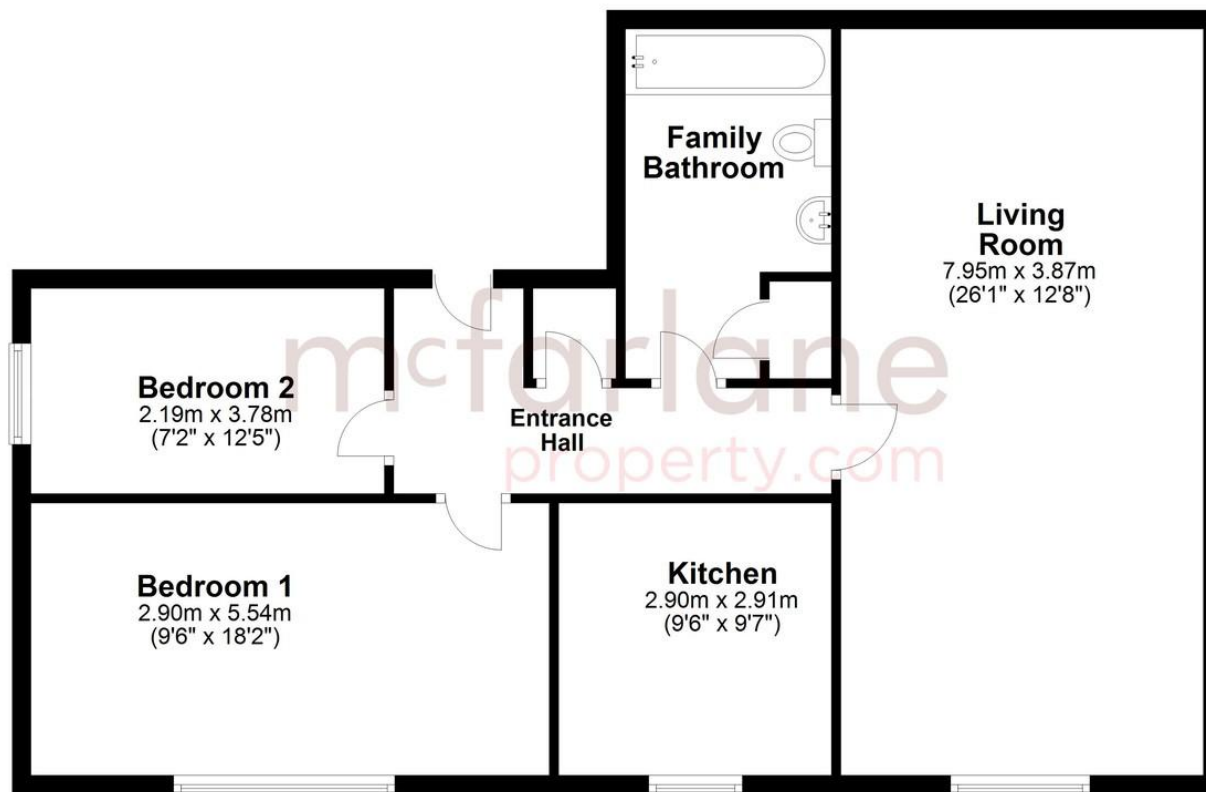

Total area: approx. 82.0 sq. metres (882.9 sq. feet)

- Two Double Bedroom Apartment
- Neighbourhood Centre St Andrews Ridge
- Living Room 26ft
- Close to Amenities

A rare opportunity to purchase a substantial First Floor Apartment in the sought after Neighbourhood Centre in St Andrews Ridge, North Swindon. Ideally positioned for the local amenities and transport links, we feel this is an ideal first purchase or a shrewd investment (potential yield of 9%) A summary comprises: Secure Access Entrance Hallway, Living Room 26ft, Kitchen, Family Bathroom, Two Double Bedrooms, uPVC Double Glazing, Electric Heating. No Chain call to Register Tim Stanley or Craig Norris 01793 751 044

We   
where you  
**LIVE**

Our team are friendly, experienced and are all local. They know it better than they do their own living rooms and can help you find what you're looking for because **we love where we live.**

We would be delighted to show you around this property.

**Because every home  
needs a personal touch.**

**If you would like to view this  
property then please get in touch.**

 01793 751044

 [cricklade@mcfarlaneproperty.com](mailto:cricklade@mcfarlaneproperty.com)

[mcfarlaneproperty.com](http://mcfarlaneproperty.com)

**mcfarlane**  
property.com

### **Cricklade.**

102 High Street  
Cricklade SN6 6AA

 01793 751044

### **Marlborough.**

106 High Street  
Marlborough SN8 1LT

 01672 514380

### **Old Town.**

28-30 Wood Street  
Swindon SN1 4AB

 01793 296880

### **Swindon.**

The Village Centre,  
Redhouse SN25 2FW

 01793 296600

Agents Note: Whilst every care has been taken to prepare these sales particulars, they are for guidance purposes only. All measurements are approximate and are for general guidance purposes only and whilst every care has been taken to ensure their accuracy, they should not be relied upon and potential buyers are advised to recheck the measurements