





Property Summary

Balcony flat to let on the 4th floor with a lift. Living room, Bedroom and modern kitchen and shower room. Central location.

Property Features

- One Bedroom Flat
- 4th Floor
- Lift
- Living Room
- Balcony
- Modern Kitchen
- Modern Shower room
- Central Location
- West Facing
- Central Heating



For Sale is this fourth floor self contained one bedroom flat. The flat is west facing and therefore bright and has the benefit of a balcony. There is a modern kitchen and a good sized double bedroom with a built in wardrobe. There is a shower room with large shower and a hallway with an additional cupboard. The flat is located between three mainline stations, and several great parks, this is a very central flat. Although on the fourth floor the flat has use of an elevator.

AGENTS NOTE:

We have been told the following:

LEASE: Lease Term From 14 March 2005 to 17 November 2116

Lease Term Remaining

SERVICE CHARGE/GROUND RENT: The service charge for this year is currently estimated (by Lewisham Homes) at £939.24, that includes the £10 Ground Rent.

VENDOR'S COMMENTS:

- It has a west facing balcony, so you get great evening sunlight as well as a splendid sunset
- 10 minute walk to Hither Green, Ladywell and Lewisham train stations
- Lots of pubs, shops, supermarkets and restaurants all within a 10 minute walk



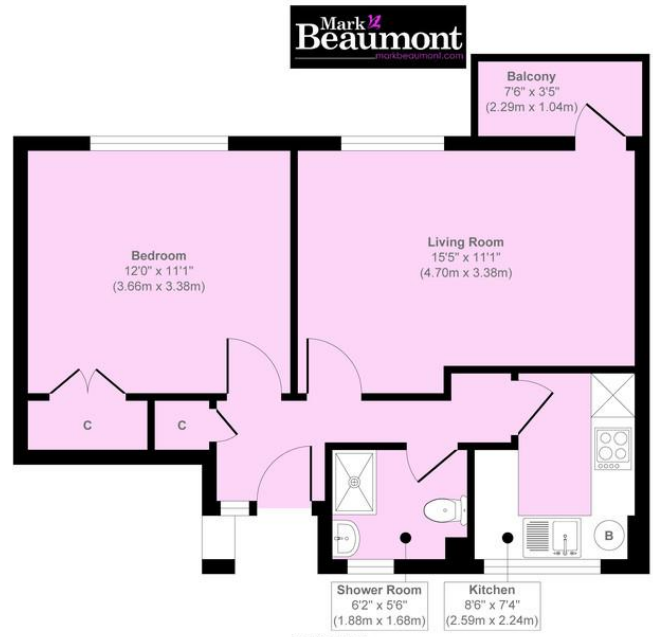

Forth Floor
 Approximate Floor Area
 460 sq. ft
 (42.73 sq. m)

Approx. Gross Internal Floor Area 460 sq. ft / 42.73 sq. m

Illustration for identification purposes only, measurements are approximate, not to scale.

Copyright © markbeaumont.com
 Produced by Elements Property

