



24 The Crescent, Plymouth, PL1 3FG

£145,000 LEASEHOLD



24 The Crescent

Plymouth, PL1 3FG

One bedroom apartment located in the heart of the city centre. This apartment boasts far reaching 180 degree views, stretching from plymouth sound all the way round to central park and beyond. With it's generously sized balcony, this property is a must view!
Council Tax band: A

Tenure: Leasehold

- Westerly views
- Sixth floor Apartment
- Integral appliances
- Central Location
- Ample storage space
- Modern fitted Bathroom
- Large balcony/terrace



24 The Crescent

Plymouth, PL1 3FG

One bedroom apartment located in the heart of the city centre. This apartment boasts far reaching 180 degree views, stretching from plymouth sound all the way round to central park and beyond. With it's generously sized balcony, this property is a must view!

You enter the property via a modern lobby with lift access or stairs to the sixth floor. You are welcomed into the apartment by a long hallway leading to all rooms. The open plan kitchen living room oozes with natural light and is finished with integrated appliances such as, fridge freezer, oven & washing machine. The living room leads you out onto the spacious balcony which provides opportunity for outdoor living and to take in the fantastic west facing views.

The bedroom has ample room for a double bed and is finished with built in double wardrobes. There are two large storage cupboards which make the apartment living that much easier! Finally the bathroom is stylishly finished with a three piece suite.





Balcony

Tenure & Services

Tenure - Leasehold

Lease Length - 105 Years

Service Charge - £1736

Ground Rent - £250

Council Tax Band - A

EPC - B



Sixth Floor

Approx. 40.8 sq. metres (439.2 sq. feet)

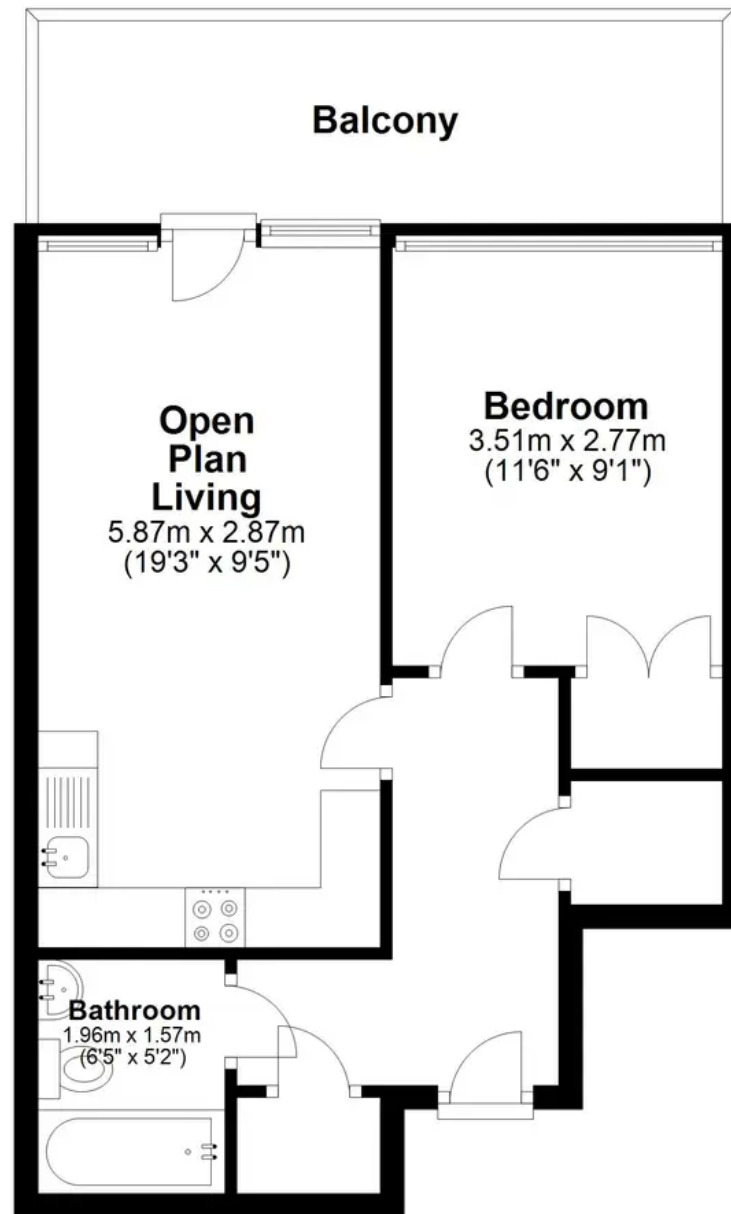

Total area: approx. 40.8 sq. metres (439.2 sq. feet)

The Crescent, Plymouth



Atwell Martin

Atwell Martin, 65 Southside Street – PL1 2LA

01752 202121

plymouthsales@atwell-martin.co.uk

plymouth.atwellmartin.co.uk/

Atwell Martin Plymouth endeavour to ensure the accuracy of property details produced and displayed. Please note that we have not tested any apparatus, equipment, fixtures, fittings or services and so cannot verify that they are connected, in working order or fit for purpose. It is imperative that the buyer of any property makes such checks, prior to purchase so as to satisfy themselves of the properties suitability for their purchase. .