



 3 Bedroom Semi-Detached House Offers in Excess Of £300,000
9 Rysy Court, Haydon End, Swindon, Wiltshire, SN25 1TH

mcfarlane
property.com

3 Bedroom Semi-Detached House Rysy Court, North Swindon

- NO ONWARD CHAIN
 - DESIRABLE LOCATON
 - THREE/ FOUR DOUBLE BEDROOMS
 - OPEN PLAN KITCHEN DINER
-

McFarlane are delighted to offer this beautifully presented and highly spacious semi-detached family home in the popular area of Haydon End, North Swindon. Located just walking distance from local shops, schools and other amenities, this property briefly comprises of entrance hall, downstairs WC, modern fitted kitchen/diner, spacious living room with feature bay window, first floor WC, master bedroom with en-suite and built in wardrobes, two further double bedrooms and a modern family bathroom. Further benefits include a fully enclosed and recently landscaped rear garden with fantastic newly built storage shed, gas central heating and a garage with power and light and off-road parking. The property has been tastefully decorated from top to bottom with brand new carpets throughout and is ready to move in to. Quietly tucked away from the beaten track enjoying views over greenery we highly recommended a viewing at your earliest convenience.





We 
where you
LIVE

Our team are friendly, experienced and are all local. They know it better than they do their own living rooms and can help you find what you're looking for because **we love where we live.**

We would be delighted to show you around this property.

**Because every home
needs a personal touch.**

**If you would like to view this
property then please get in touch.**

📞 01793 296600

✉ swindon@mcfarlaneproperty.com

mcfarlaneproperty.com

Agents Note: Whilst every care has been taken to prepare these sales particulars, they are for guidance purposes only. All measurements are approximate are for general guidance purposes only and whilst every care has been taken to ensure their accuracy, they should not be relied upon and potential buyers are advised to recheck the measurements

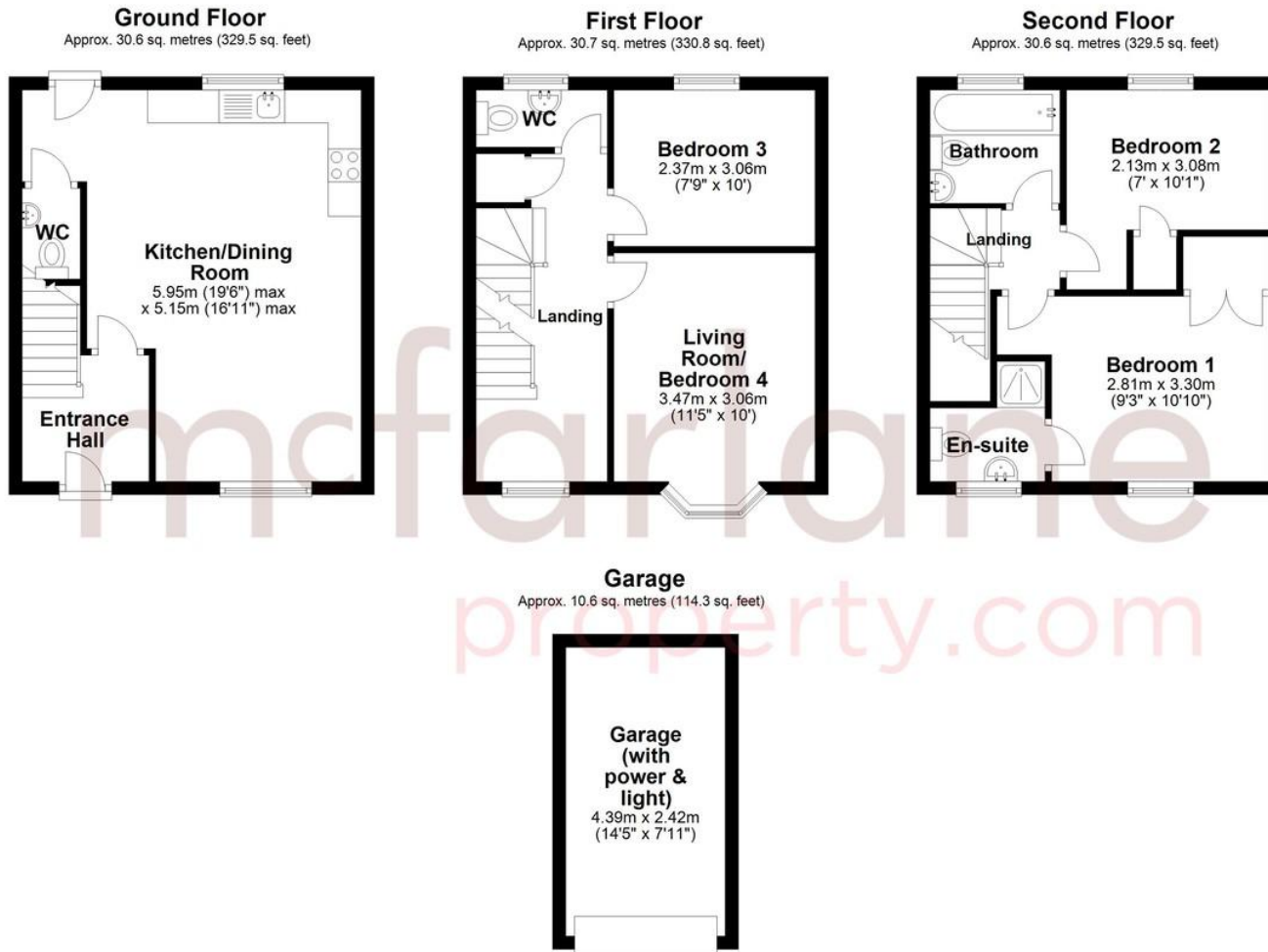

Total area: approx. 102.6 sq. metres (1104.2 sq. feet)

mcfarlane
property.com

Cricklade.
102 High Street
Cricklade SN6 6AA
📞 01793 751044

Marlborough.
106 High Street
Marlborough SN8 1LT
📞 01672 514380

Old Town.
28-30 Wood Street
Swindon SN1 4AB
📞 01793 296880

Swindon.
The Village Centre,
Redhouse SN25 2FW
📞 01793 296600