

The Kilkenny

3 bedroom home



Elegant three bedroom home with combined kitchen and dining area with French doors to the garden, spacious lounge, modern bathroom and cloakroom.

First Floor

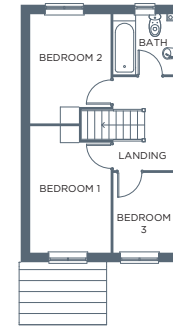

Ground Floor

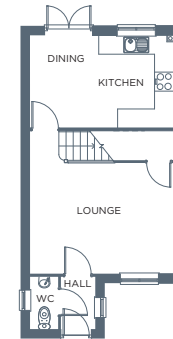

Ground Floor

Room	Metres	Feet & Inches
Kitchen / Dining	4.48 x 2.90	14'8" x 9'6"
Lounge	4.47 x 4.48	14'8" x 14'8"
WC	1.60 x 0.86	5'3" x 2'10"

First Floor

Room	Metres	Feet & Inches
Bedroom 1	3.97 x 2.51	13'0" x 8'2"
Bedroom 2	3.42 x 2.51	11'2" x 8'2"
Bedroom 3	2.49 x 1.88	8'2" x 6'2"
Bathroom	1.88 x 1.87	6'2" x 6'2"

Total area 772ft² / 71.71m²

Design and specification. Gleeson is constantly seeking ways to improve the design, specification and construction of its properties and reserves the right to make alterations at any stage during development. Whilst every effort is made to produce up to date literature, this information should not be regarded as an infallible guide to current specifications - please check the latest details with our sales centre. Due to the nature of construction room sizes may vary and purchasers are advised to satisfy themselves as to their accuracy. Kitchen and bathroom layouts are indicative only. Individual elevations and finishes may vary between each plot and development. These should be checked with our sales centre.

gleeson
Building Homes, Changing Lives.