



Williams Place, Greenwood Way

Didcot

Simpsons

The Proactive Agent

£180,000



SCAN THE
QR CODE
FOR DETAILS



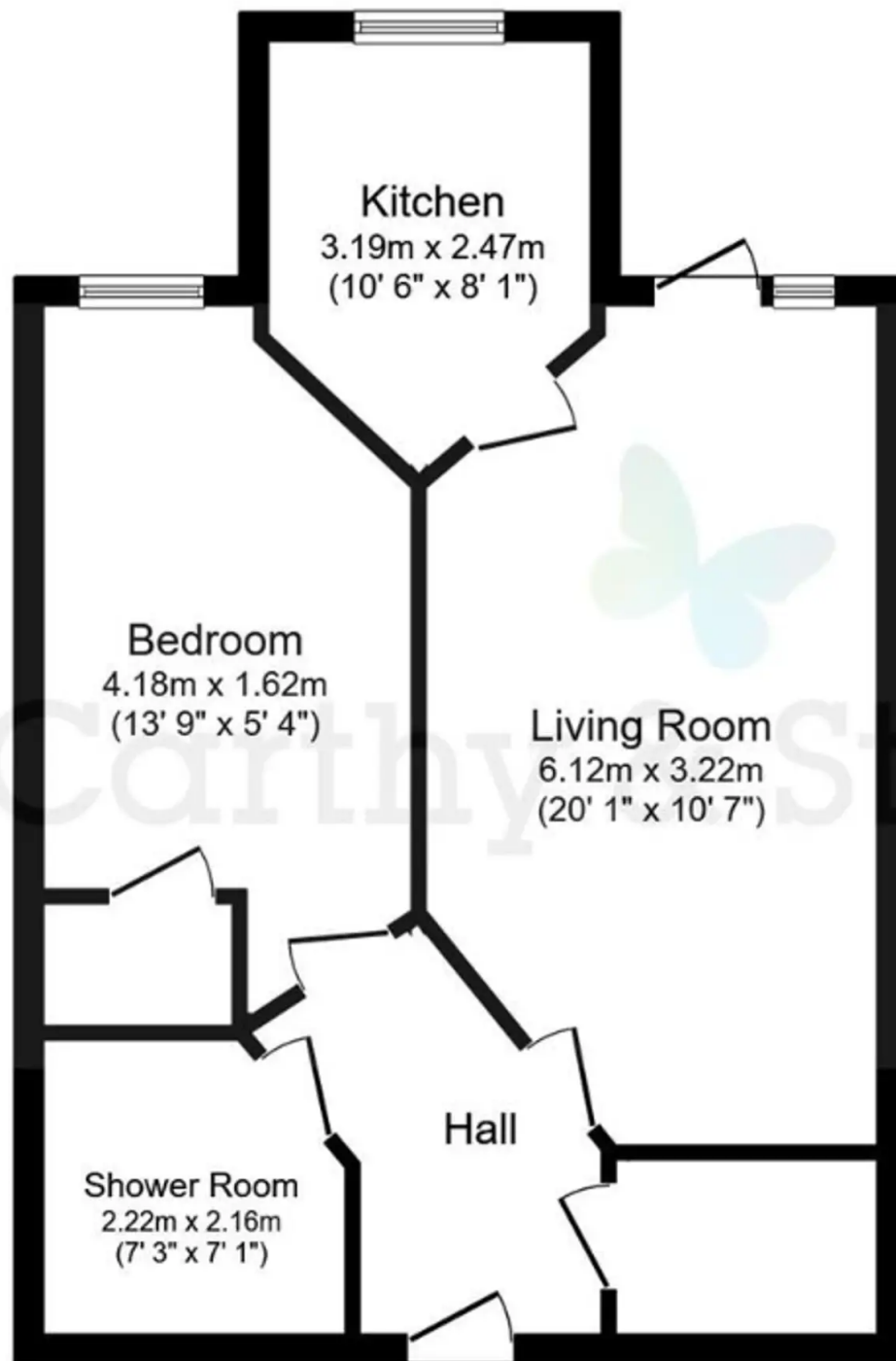

Williams Place

, Didcot

Williams Place is a McCarthy & Stone Retirement Living PLUS development in Harwell, Didcot for those over 70.

Council Tax band: B

Tenure: Leasehold

- Home owners lounge - photos within description.
- Estate Manager and 24-hour on site staffing
- Shops and restaurants within close walking distance
- Personal care packages available from the onsite CQC registered care agency
- Walking distance to a bus route.



SCAN THE
QR CODE
TO BOOK
YOUR VIEWING



