



**SALES**

**LETTINGS**

**MANAGEMENT**

[chiswick@tatepartnership.co.uk](mailto:chiswick@tatepartnership.co.uk)

**020 8996 0000**

**TATEPARTNERSHIP.CO.UK**



**Reynolds Road, W4**

**£1,745 pcm**

This really is a Little Gem. A modern mews styled 2 Bedroom property, located in a delightful private courtyard setting, discreetly sitting behind and unseen from, Reynolds Road. The accommodation is arranged over two floors and was fully decorated last year, plus several upgrades including, new double glazing, CH boiler, carpets, air conditioning unit etc. Downstairs (wooden flooring), entrance hall, living room, kitchen; upstairs (carpeted), landing, 2 bedrooms, bathroom. NB. The small bedroom is more suited to a cot-room or home office. Outside, to the front is the shared courtyard, with each property having its' own designated seating area. Location is about 10 minutes walk from Chiswick Park Station and the main Sainsburys. Available now. Unfurnished.

### Gresham Mews

Approximate Gross Internal Area = 43.0 sq m / 467 sq ft

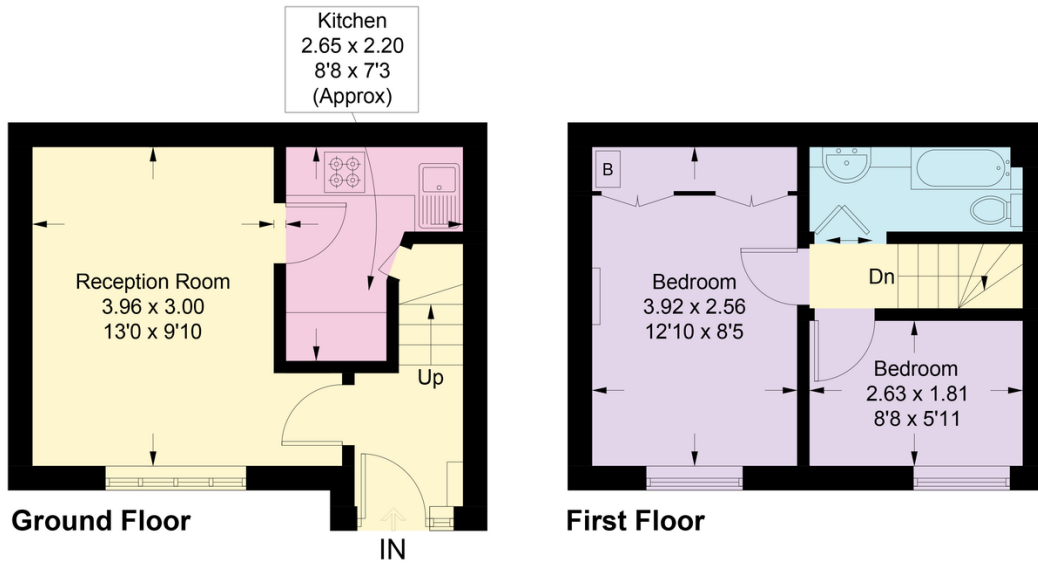

Illustration for identification purposes only, measurements are approximate, not to scale. floorplansUsketch.com © (ID964734)

## EPC

