



- 36' X 12' PARK HOME
- FABULOUS SECLUDED PLOT
- MAIN BEDROOM PLUS GUEST ROOM
- KITCHEN/BREAKFAST ROOM

Brookmeadow Way , Breach Barns Lane, Waltham Abbey, EN9 2AD

Fabulous secluded plot with this 36' x 12' park home on an established semi-rural residential site on the outskirts of Waltham Abbey/Upshire. One main bedroom and small second bedroom. Kitchen/breakfast room and good size lounge. Allocated parking. The unit is well presented and offers LPG gas and full double glazing. CASH PURCHASE ONLY

PRICE: £99,995 (Agreement regulated by The Mobile Homes Act)



Property Description

Breach Barns family park is an established residential park home site set in a semi-rural location on the edge of Essex countryside and Epping Forest borders. There are several public footpaths giving access to the local areas for ramblers and dog walkers.

This particular property is set on an excellent secluded plot on the corner of the park and the gardens surround the unit. The current vendor has landscaped the plot and it now offers a superb outdoor space for al-fresco dining or social entertaining. Additionally there is one allocated parking space adjacent to the property boundary.

The unit is well presented throughout and the accommodation is accessed via the main entrance hall. There is a master bedroom which houses a double bed and bedroom two is a single room, ideal for overnight guests. The bathroom has been replaced in recent years and offers a which three piece suite.

There is a good size kitchen/breakfast room with fitted units and space for a breakfast table and chairs which grants access to the main lounge.

The home is supplied with LPG gas supply and is fully double glazed.

Interested parties should note that park homes are purchased cash and sold under an agreement regulated by The Mobile Homes Act.

Being offered chain free, early viewing is highly recommended.





ACCOMMODATION IN BRIEF COMPRISES:

ENTRANCE HALL

LOUNGE

12' 0" x 10' 10" (3.66m x 3.3m)

KITCHEN/BREAKFAST ROOM

12' 0" x 10' 5" (3.66m x 3.18m) Maximum measurements

BATHROOM

6' 10" x 5' 5" (2.08m x 1.65m)

MASTER BEDROOM

12' 0" x 9' 2" (3.66m x 2.79m) Maximum measurements

BEDROOM TWO

7' 3" x 4' 0" (2.21m x 1.22m)

EXTERIOR

PERSONAL GARDENS

ALLOCATED PARKING

CHARGES

Ground Rent £213.86

Council Tax - Band A within Epping Forest District Council



Ground Floor

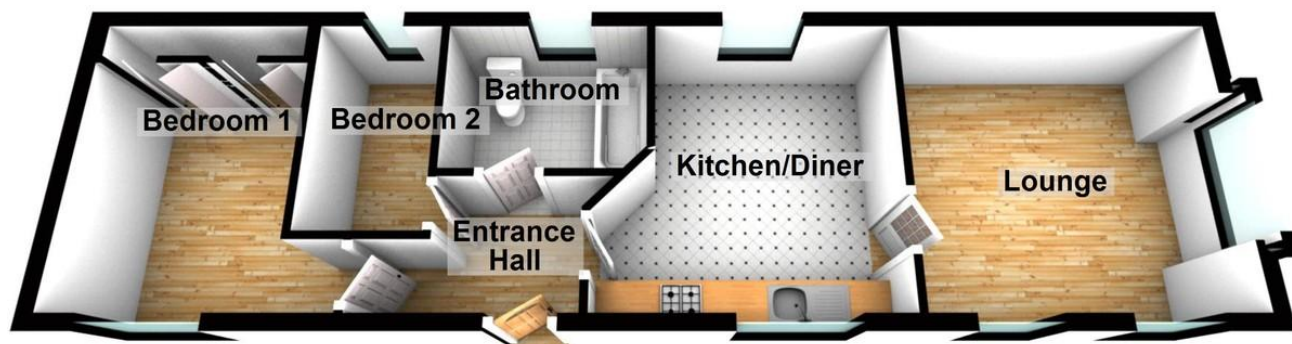

25 Market Square, Waltham Abbey,
Essex, EN9 1DU

www.rainbowestateagents.co.uk

01992 711222

rebecca@rainbowestateagents.co.uk

Agents Note: Whilst every care has been taken to prepare these particulars, they are for guidance purposes only. All measurements are approximate and for general guidance purposes only and whilst every care has been taken to ensure their accuracy, they should not be relied upon and potential buyers/tenants are advised to recheck the measurements