



THE
ASHMORE
A two bedroom semi-
detached and terraced home



BLUEBELL
HOMES

CGI shows two semi-detached Ashmore homes. Elevational treatments may vary by plot.

THE ASHMORE

A two bedroom semi-detached and terraced home

Plot 177 has a single storey side bay/ gable fronted *

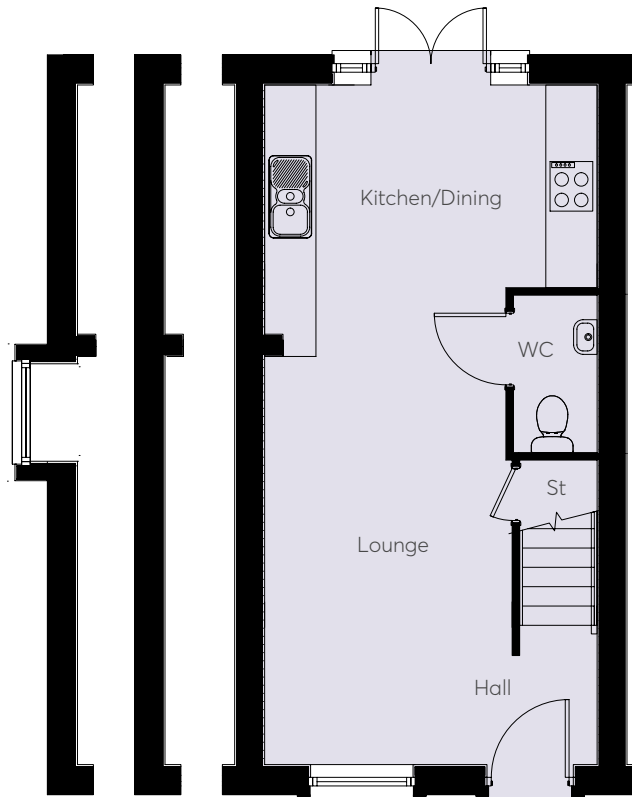

Ground Floor

Kitchen / Dining	3.89m x 3.18m	12'9" x 10'5"
Lounge	4.77m x 2.90m	15'8" x 9'6"

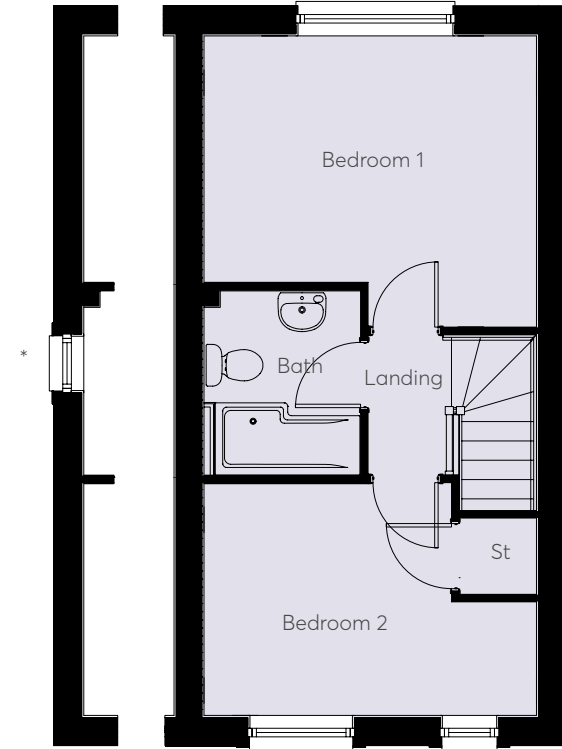

First Floor

Bedroom 1	3.89m x 3.41m	12'9" x 11'2"
Bedroom 2	3.89m x 2.72m	12'9" x 8'11"

Elevational treatments may vary by plot. Some plots will have windows as indicated by *

**CONSUMER
CODE FOR
HOME BUILDERS**

www.consumercode.co.uk

These images are designed to give an impression of the development and our housetypes - they may not reflect a specific plot and do not form part of any contract. Final finishes, landscaping and detail will vary. This information has been provided in good faith, however all layouts and measurements are approximate only. Some house types include areas of reduced headroom. Bathroom and kitchen layouts are indicative only and designs may change due to our process of continuous product development. Images used in marketing materials may be computer generated or photography of previous developments. Dimensions are taken to the maximum.



**BLUEBELL
HOMES**