



LAWRENCE RAND

Allonby Drive, Ruislip

£590,000



Allonby Drive

Ruislip, Ruislip

This larger than average four bedroom, two bathroom end of terrace family home is set within a quiet cul-de-sac location in a modern development, just over a mile away from Ruislip High Street and is being offered for sale with no onward chain.

Council Tax band: D

Tenure: Freehold

- Four bedrooms
- Two bathrooms
- Cul-de-sac location
- Spacious accommodation
- Local to shops and leisure facilities
- Catchment for excellent schooling
- Secluded garden





Allonby Drive

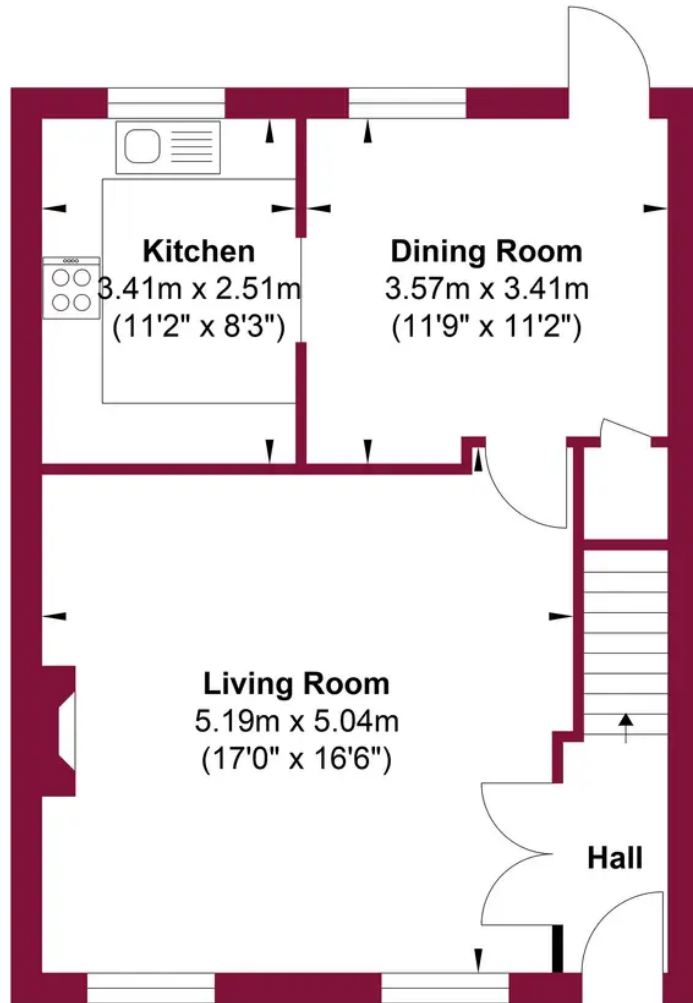

Ground Floor

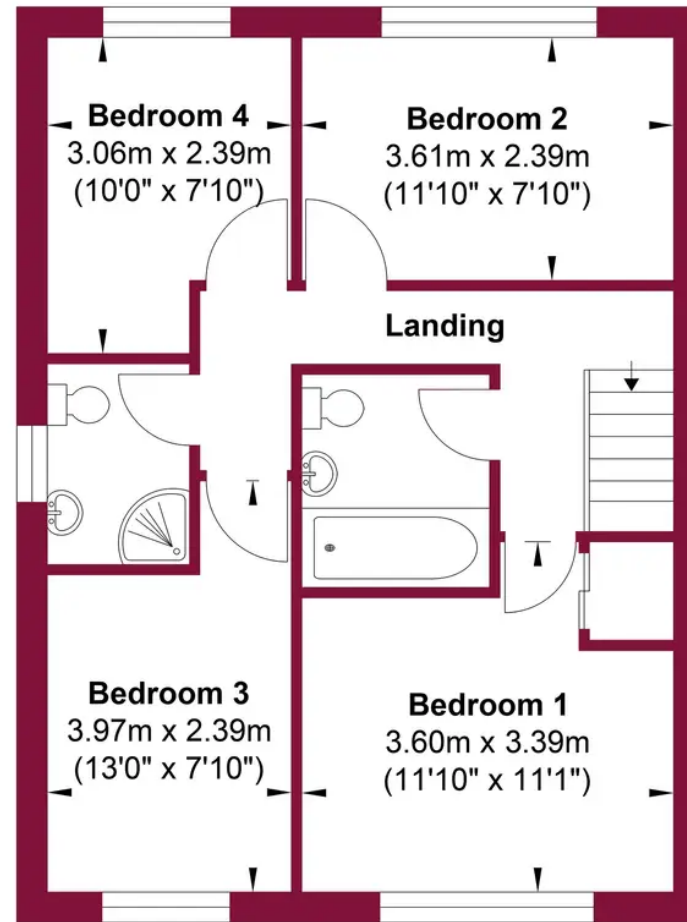

First Floor

Gross Internal Floor Area : 98.4 m2 ... 1059 ft2

This floor plan is for illustrative purposes and layout guidance only. It is not drawn to scale. Dimensions should not be used for carpet or flooring sizes and are not intended to form part of any contract.



Lawrence Rand

Lawrence Rand, 106 Victoria Road - HA4 0AL

01895 632211

Info@lawrence-rand.co.uk

www.lawrence-rand.co.uk/



LAWRENCE RAND