



**LAWRENCE RAND**

Woodlands Avenue, Ruislip

£699,950



## Woodlands Avenue

Ruislip, Ruislip

This very well-presented three bedroom extended semi-detached family home is located in a sought after road, close to Newnham Primary and just a short walk from the shops, restaurants and station in Eastcote.

Council Tax band: E

Tenure: Freehold

- Three bedrooms
- Semi-detached
- Two bathrooms
- Potential to extend (stpp)
- Utility room
- Kitchen with island
- Double Garage
- Large through lounge/dining
- Walking distance to amenities
- Great transport links









# Woodlands Avenue, Eastcote, Middlesex, HA4

Approximate Area = 1385 sq ft / 128.6 sq m (includes garage)

For identification only - Not to scale

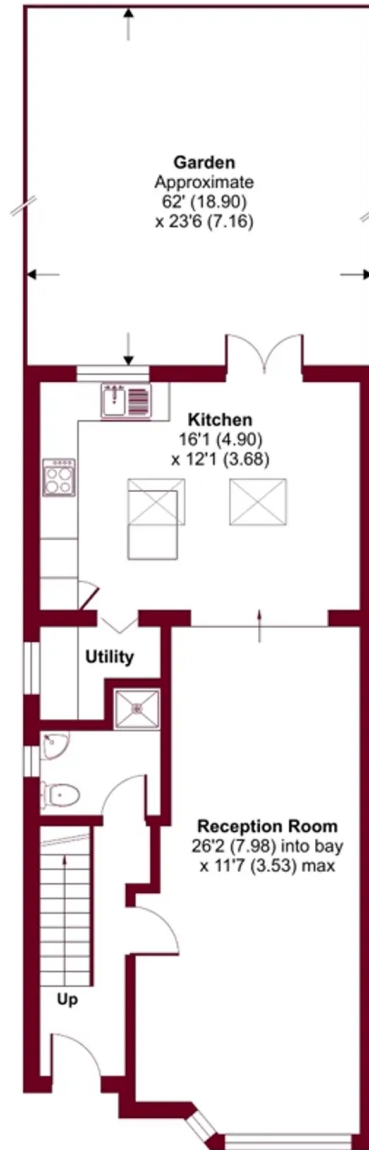

GROUND FLOOR

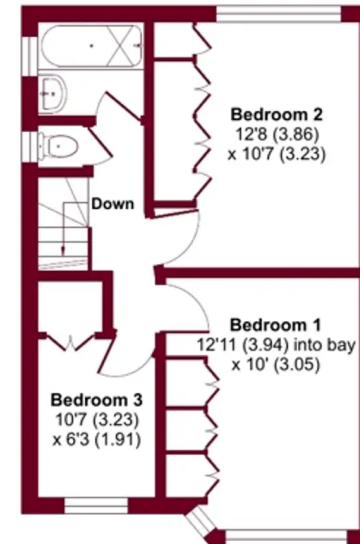
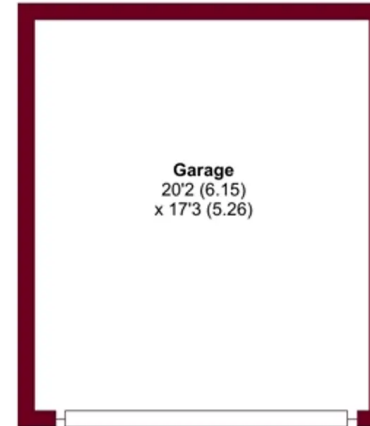

FIRST FLOOR



Floor plan produced in accordance with RICS Property Measurement Standards incorporating International Property Measurement Standards (IPMS2 Residential). © nichecom 2023. Produced for Lawrence Rand. REF: Order: #969881





## Lawrence Rand

Lawrence Rand, 106 Victoria Road - HA4 0AL

01895 632211

[Info@lawrence-rand.co.uk](mailto:Info@lawrence-rand.co.uk)

[www.lawrence-rand.co.uk/](http://www.lawrence-rand.co.uk/)



**LAWRENCE RAND**