



**LAWRENCE RAND**

**32 Sycamore Close, Northolt**  
**£225,000**





## 32 Sycamore Close

Northolt, Northolt

An exceptionally spacious one double-bedroom ground-floor flat set within this small development overlooking communal gardens.

Long lease and parking.

Council Tax band: C

Tenure: Leasehold

- Ground floor flat
- Spacious lounge/dining room
- Separate kitchen
- Communal garden
- Ideal starter home or investment opportunity









# Sycamore Close, Northolt, UB5

APPROX. GROSS INTERNAL FLOOR AREA 486 SQ FT 45.1 SQ METRES

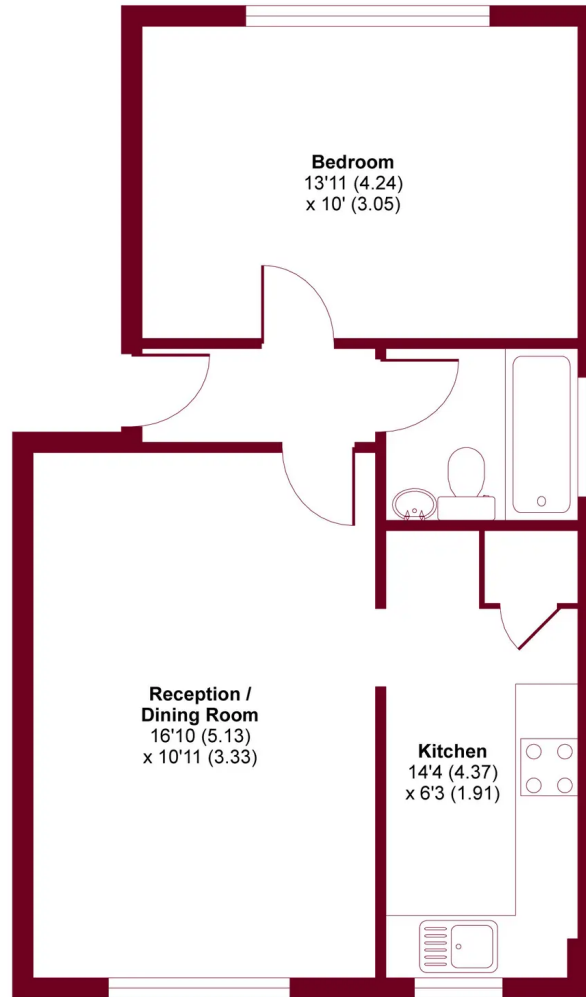

**GROUND FLOOR**

Whilst every attempt has been made to ensure the accuracy of the floor plan contained here, measurements of doors, windows and rooms are approximate and no responsibility is taken for any error, omission or misstatement. These plans are for representation purposes only as defined by RICS Code of Measuring Practice and should be used as such by any prospective purchaser. Specifically no guarantee is given on the total square footage of the property if quoted on this plan. Any figure given is for initial guidance only and should not be relied on as a basis of valuation.





## Lawrence Rand

Lawrence Rand, 106 Victoria Road - HA4 0AL

01895 632211

[Info@lawrence-rand.co.uk](mailto:Info@lawrence-rand.co.uk)

[www.lawrence-rand.co.uk/](http://www.lawrence-rand.co.uk/)



**LAWRENCE RAND**