



LAWRENCE RAND

10a The Sigers, Pinner
£325,000



10a The Sigers

Pinner, Pinner

The Sigers is one of the most sought after locations in the area, being well-located within a few minutes walk of the shopping & transport facilities in Eastcote. This two bedroom first floor maisonette has NO CHAIN, lease extension (to 139 years) included and there is also currently a garage available to rent.

Council Tax band: D

Tenure: Leasehold

- First Floor Maisonette
- Two Double Bedrooms
- Sought After Cul-de-sac
- Own Private Entrance
- Residents Permit Parking
- Garage Available to Rent
- Short Walk from Station & Shops
- Close to Highly Regarded Local Schools
- No Chain & Lease Extension







The Sigers, Pinner, Middlesex, HA5

Approximate Area = 617 sq ft / 57.3 sq m

For identification only - Not to scale

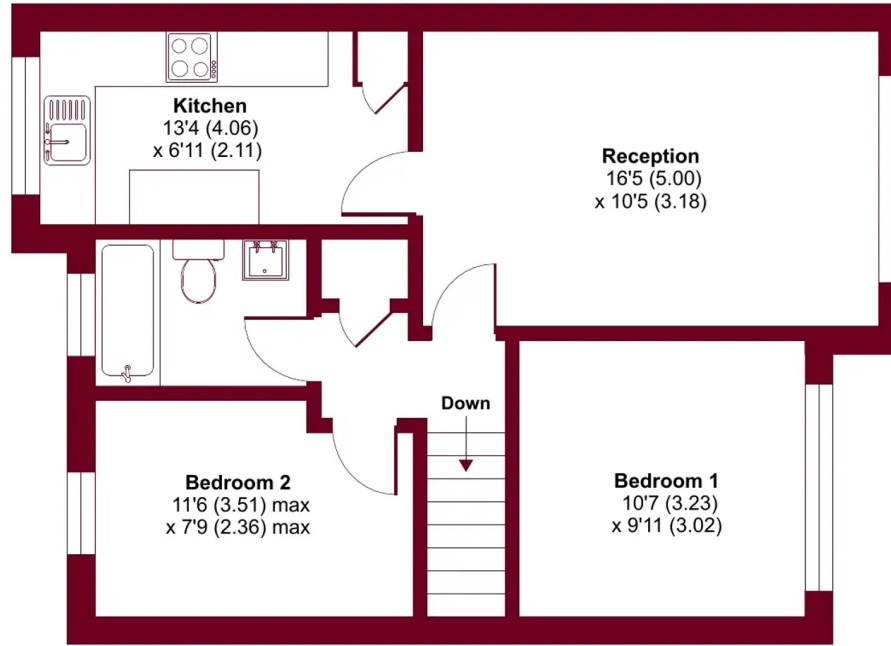

FIRST FLOOR

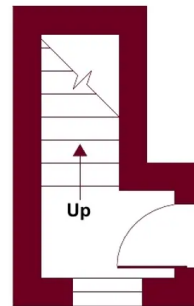

GROUND FLOOR





Lawrence Rand

Lawrence Rand, 106 Victoria Road - HA4 0AL

01895 632211

Info@lawrence-rand.co.uk

www.lawrence-rand.co.uk/



LAWRENCE RAND