



LAWRENCE RAND

Flat 21, 260 Field End Road, Ruislip

Guide Price **£320,000**



Flat 21

260 Field End Road, Ruislip

A luxury one-bedroom apartment situated in a secure gated development. Ultra-convenient location in the heart of Eastcote, near to the Zone 5 Underground Station (Met/Piccadilly Lines) and the extensive shopping facilities at Eastcote High Street. The property comes with its own parking space.

Council Tax band: C

Tenure: Leasehold

- Luxury apartment
- One bedroom
- Open plan living
- Juliette Balcony
- Gated secure parking
- Nearby Zone 5 underground
- Close to all amenities







Field End Road, Ruislip, HA4

Approximate Area = 426 sq ft / 39.5 sq m

For identification only - Not to scale

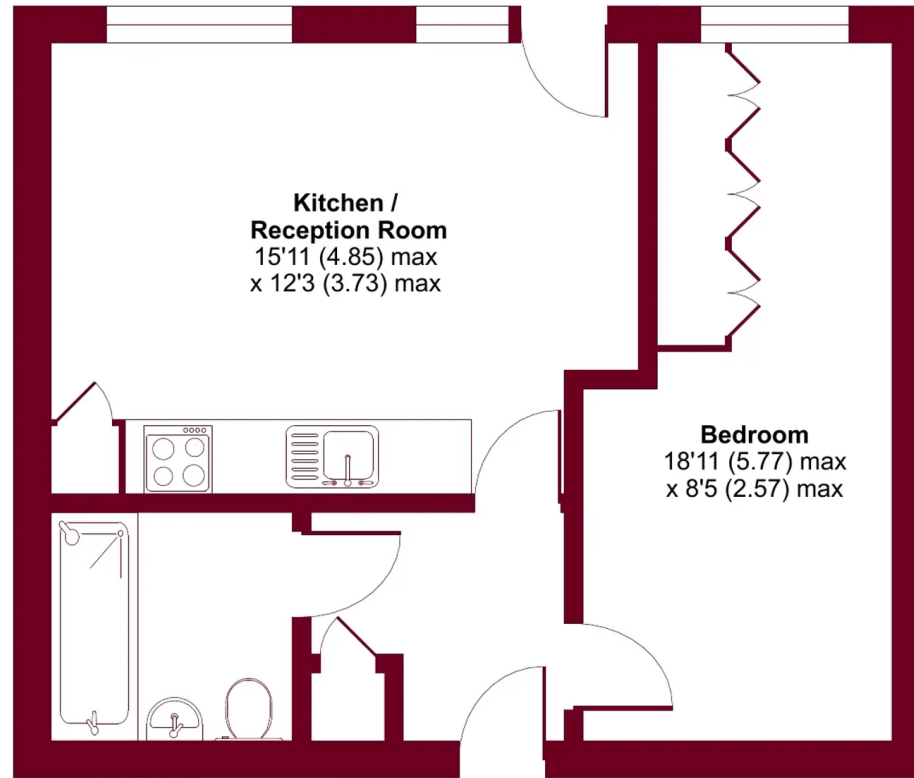

FIRST FLOOR





Lawrence Rand

Lawrence Rand, 106 Victoria Road - HA4 0AL

01895 632211

Info@lawrence-rand.co.uk

www.lawrence-rand.co.uk/



LAWRENCE RAND