



Belmont Street, HU9

**Guide Price** £74,950

Council Tax Band A



## A smart move...

A good sized two bedroom terraced house which would be perfect for a couple or small family. The property is vacant and available for viewings now, so call the office today to avoid disappointment.

This property is well presented throughout and briefly comprises of; a bright and airy lounge, fully fitted kitchen, a family bathroom with white suite downstairs and two good sized bedrooms upstairs.

Externally, the property benefits from a small yard leading to a sheltered storage space to the rear.

The property is ideally positioned within easy walking distance of the Holderness Road shopping area which offers a vast array of shopping facilities, public transportation and within a short driving distance to the City Centre as well as Woodford Leisure Centre and East Park.

COUNCIL TAX BAND A.

- Fitted Kitchen
- Shops & Amenities Nearby
- Spacious Lounge
- Close to Public Transport
- Rear Yard
- External Storage Area

## Rooms

## Directions

## Agents Note





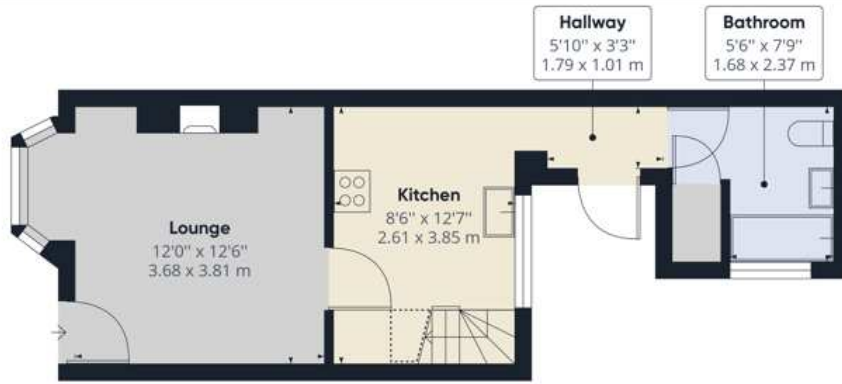

Ground Floor



Floor 1

Approximate total area<sup>(1)</sup>

584.40 ft<sup>2</sup>  
54.29 m<sup>2</sup>

Reduced headroom

8.48 ft<sup>2</sup>  
0.79 m<sup>2</sup>

(1) Excluding balconies and terraces

Reduced headroom  
(below 1.5m/4.92ft)

While every attempt has been made to ensure accuracy, all measurements are approximate, not to scale. This floor plan is for illustrative purposes only.

GIRAFFE360

**Lime Property (Hull Ltd)**

Royal Mail Suburb KT13 8DE

Call: 01482 216060

Web: [www.lime-property.co.uk](http://www.lime-property.co.uk)

Email: [info@lime-property.co.uk](mailto:info@lime-property.co.uk)

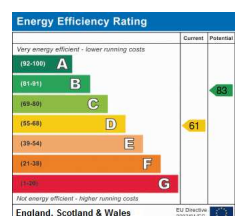

Check your disclaimer in settings. Fic tempor apelenimpore laut odit eosam apicto officipic tem eaquund ele strupti sin non eligenduscid estuir aut plitas ea porernatia volore sum fuga dio. Occum quam animusamet a consequam re dest vollatur rehenturib ea dolum reperib usdanto blaniet aut as venim volorumet.