

Newbiggin

£1,500 pcm

Manor House
Newbiggin
Penrith
CA11 0HT

A fantastic opportunity to rent a spacious Manor House in large grounds. Offered furnished the property comprises; lounge, large kitchen dining, utility, sun room, two bathrooms and three bedrooms. Cleaner & Gardener included in rent.

- Three Bedroom Manor House
- Lounge, Spacious Kitchen Dining, Utility & Sun Room
- Newly Renovated Bathroom and Additional Shower Room
- Offered Furnished
- Large Grounds and Gardener Included in the Rent
- Older Children Welcome Due to Pond in Garden
- Pets Considered
- No Sharers or Smokers
- Council Tax Band E
- Available Mid January 2024 for 6 Months Only

Property Ref: PR025





Lounge

Location: From Penrith proceed out of the Town Centre and over Castletown Bridge, following the B5288 for approximately two and a half miles. At The Clickham Inn take a left turn towards Newbiggin. Manor House can be found on the left through a gated entrance approximately one mile along this road.

Services: Mains Electric, Private Oil, Mains Water & Drainage

Viewings: Strictly by appointment with Hackney & Leigh – Penrith Office.

Applying for a Tenancy: Tenancy Application Forms are available from any Hackney & Leigh office. Each application must be accompanied by payment of a Holding Deposit (one weeks rent) payable either by debit or credit card. This is paid to reserve the property and will be held by us for a period of 15 days unless we agree otherwise.

All adults of 18yrs and over who will be living at the property will be asked to provide evidence of nationality and identity to validate their "Right to Rent" under the Immigration Act 2014.

Referencing: All applicants will be required to provide satisfactory references eg: employer, current landlord and two character references. For the self-employed, a reference from your accountant or solicitor will be required. A credit reference will be obtained for each applicant. Acceptance of references and the offer of a tenancy is at our discretion.

The Tenancy: The property will be let on a fixed term Assured Shorthold Tenancy for an initial period of 6 months. There is no automatic provision within the lease for early termination and the tenant is responsible for rent for the whole term.

The tenant is responsible for Council Tax for the tenancy period and for all charges for water and sewerage, gas, electricity, telephone or other

utility/service providers' charges supplied to the tenant during the tenancy.

Deposit & Rent: The successful Tenant will be required to pay a deposit (equal to a maximum of 5 weeks rent depending on the property). This will be held in accordance with the Tenancy Deposit Scheme Regulations and will be re-fundable at the end of the tenancy, subject to the property being left in a satisfactory condition. Rent is payable on or by each rent day and is payable by standing order. One month's rent in advance PLUS the deposit, is required at the time of signing the agreement. Please Note: It is NOT possible to use the deposit as rent for the final month.

Pets: Higher rent may be payable where pets are permitted at the Landlords' discretion. Pets may not be acceptable for a number of reasons including allergies/medical reasons, conditions within the property lease, lack of outside space, communal grounds or close proximity to a main road. Acceptance of a pet is subject to the Landlords discretion.

Insurance: It is the Tenants' responsibility to insure their own possessions. Tenants are strongly advised to take out accidental damage cover in respect of the Landlord's property and contents.

Energy Performance Certificate: The full Energy Performance Certificate is available on our website www.hackney-leigh.co.uk and also at any of our offices.

How to rent: Prospective tenants are advised to read the government's leaflet which is available here: <https://www.gov.uk/government/publications/how-to-rent>



Kitchen Dining Room



Views

Newbiggin, Penrith, CA11

Approximate Area = 1776 sq ft / 164.9 sq m

For identification only - Not to scale

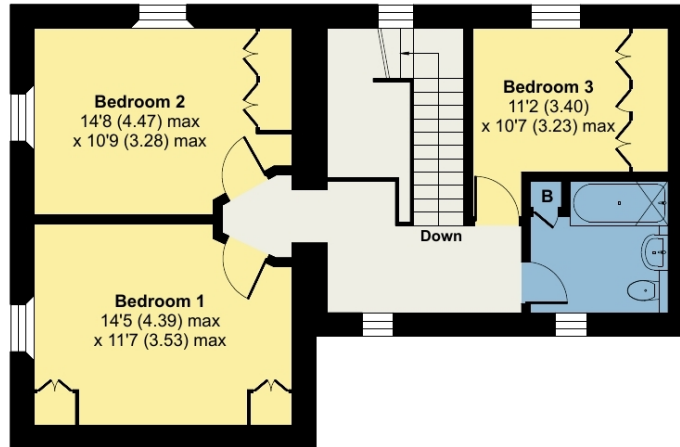

FIRST FLOOR



GROUND FLOOR



Floor plan produced in accordance with RICS Property Measurement Standards incorporating International Property Measurement Standards (IPMS2 Residential). © n/checom 2023. Produced for Hackney & Leigh. REF: 1003074

Newbiggin - Ref: PR025

Property particulars and appointments to view are provided on the understanding that all negotiations are conducted through Hackney and Leigh Ltd. This information is provided for general guidance only. It does not form part of any contract or agreement and no guarantee of accuracy is given. Prospective tenants should make their own enquiries as to the suitability or otherwise of the property. No responsibility can be accepted for any loss or expense incurred in viewing or in the event of a property being let or withdrawn. Please contact us to confirm the property's availability, especially if travelling some distance.