



25
YEARS
SERVING
BEACONSFIELD
SINCE 1998

Challow Stoke Wood, Stoke Poges

Guide Price £2,000,000

Ashington Page

A Beautifully presented and spacious six bedroom home located in the highly prized private estate of Stoke Wood and close to Stoke Poges, Beaconsfield and Gerrards Cross. The accommodation is over three floors and of high standard throughout with a modern kitchen and bathrooms. Separate office cabin with wc, light and power. Stunning garden with lawn, children's play area, patio and woodland. Long gated driveway leading to double garage with electric up and over doors and loft space. Plot approximately 0.45acres. NO ONWARD CHAIN.

Freehold

Council Tax Band G
EPC C

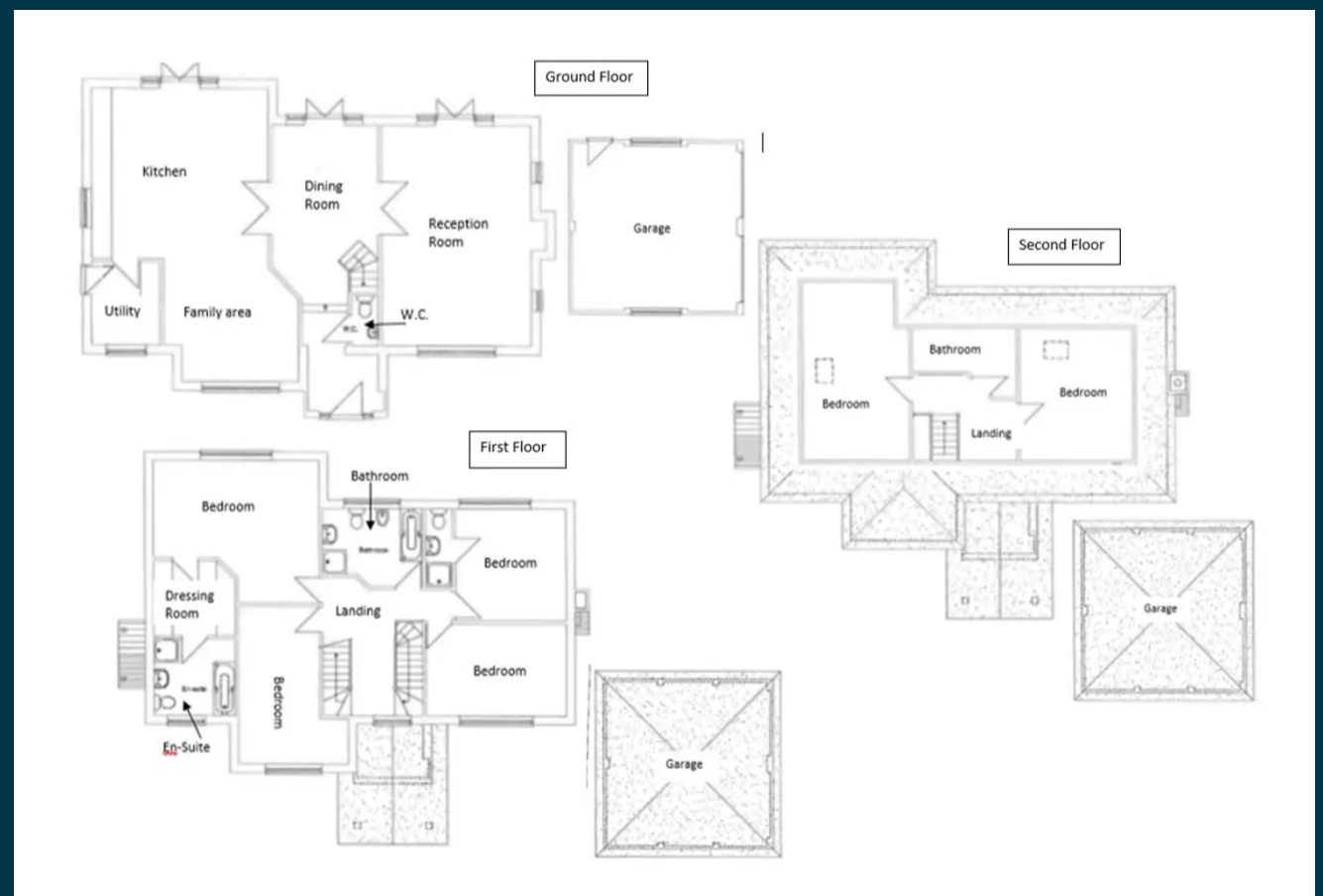

These particulars are for guidance only. They are prepared and issued in good faith and are intended to give a fair summary of the property. Any description should not be relied on as a statement or representation of fact or that the property, or its services, are in good condition. The photographs show only certain parts of the property at the time they were taken. Any areas, measurements or distance given are approximate only. Any reference to alterations to, or use of, any part of the property is not a statement that any necessary planning, building regulations or other consent has been obtained. These matters must be verified by an intending purchaser. All statements contained in these particulars in relation to the property are made without responsibility of Ashington Page or its clients. Neither Ashington Page (nor any joint agents) nor any of their employees has any authority to make or give any representation or warranty whatsoever in relation to the property



01494 680018
info@ashingtonpage.co.uk
www.AshingtonPage.co.uk

