



**LAWRENCE RAND**

**The Uplands, Ruislip**

Guide Price **£775,000**



## The Uplands

Ruislip, Ruislip

A semi-detached charming family home, with three bedrooms, two receptions, providing comfortable living and is perfectly positioned to local amenities at both Ruislip, Ruislip Manor and Eastcote. Benefits include; garage via own drive, NO ONWARD CHAIN and potential to extend (stpp).

Council Tax band: F

Tenure: Freehold

- Semi-detached House
- Three Bedrooms
- Two Receptions
- Large Garden
- Own Drive to Garage
- Great Transport Links
- Walking Distance to Amenities
- Highly Regarded Local Schools







# The Uplands, Ruislip, Middlesex, HA4

Approximate Area = 1444 sq ft / 134.1 sq m (includes garage)

For identification only - Not to scale

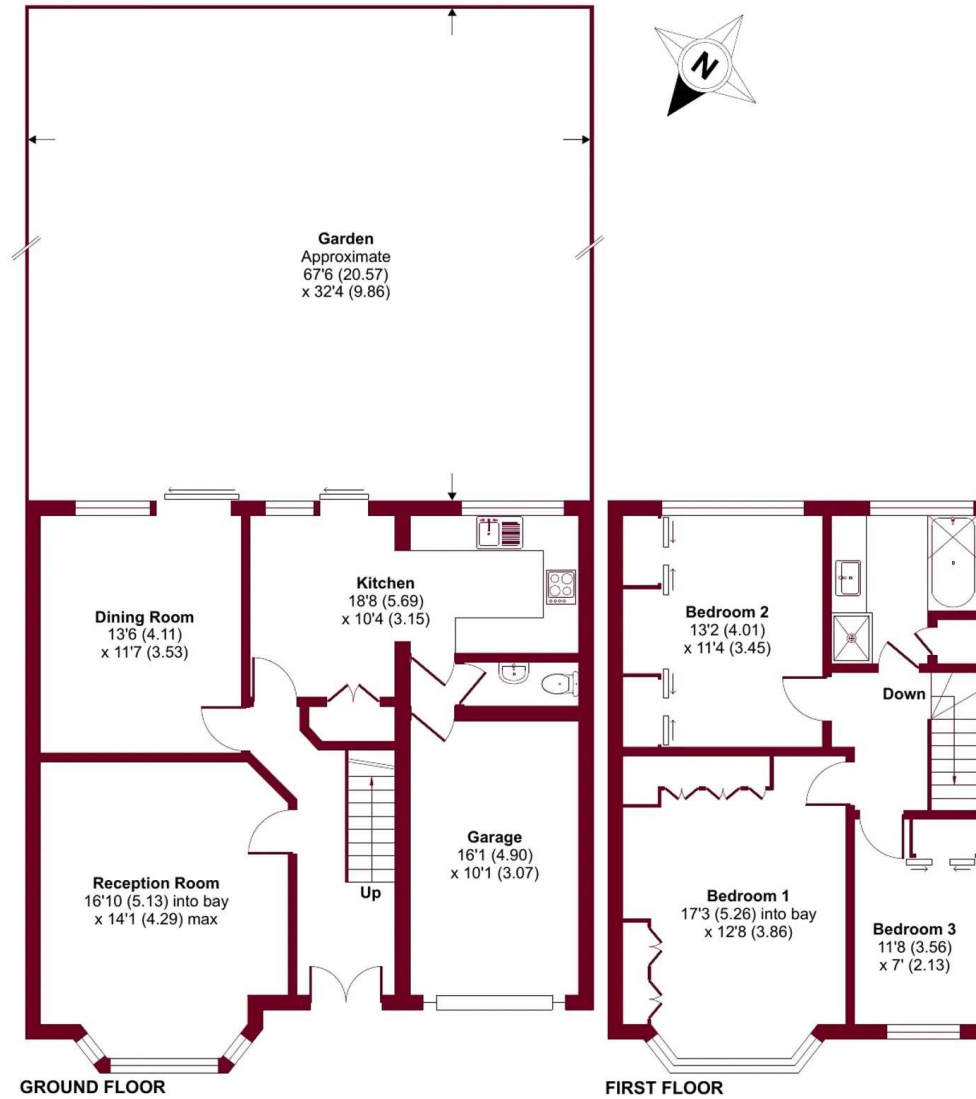



## Lawrence Rand

Lawrence Rand, 106 Victoria Road - HA4 0AL

01895 632211

[Info@lawrence-rand.co.uk](mailto:Info@lawrence-rand.co.uk)

[www.lawrence-rand.co.uk/](http://www.lawrence-rand.co.uk/)



**LAWRENCE RAND**