



28 Sunningdale Road, Baffins

Portsmouth

Offers in Region of £300,000





28 Sunningdale Road

Baffins, Portsmouth

Beautifully presented with freshly painted neutral decor and new carpets throughout, this three bedroom extended house in Sunningdale Road, Baffins is ready to move straight into! It's located within walking distance to many local amenities including local shops, schools and parks so would make a great family home for those of you looking to move into the area. The entrance hall feels light and airy and has the benefit of a shower room off. A good size Lounge with it's imposing bay window will easily accomodate modern furniture.

An extended dining room comes next and has double glazed french doors opening out into the garden. It's such a good size room that it could be used as a dedicated Lounge Dining Room all on it's own! The modern shaker style kitchen is well executed and flows around the room providing plenty of storage and countertop with space for appliances too. This room also overlooks the garden with access to it via a doorway. Upstairs you'll find three bedrooms off a large landing. Two good sized double rooms and a further large single room to the rear. All the bedrooms are neutrally decorated with new carpets so ready to move straight into. The bathroom has a modern white suite, with a shower over with contemporary tiling.

Outside, the west facing garden is a great size and a safe place for little ones to play in. You'll also find a workshop at the end of the garden which has rear access. We think this would make a great office space or with work could be made into a garage? All in all we think this is a wonderful family home and good value compared to others locally. It also has no forward chain so you could be living here sooner than you think!

Council Tax band: C

Tenure: Freehold





Ground Floor

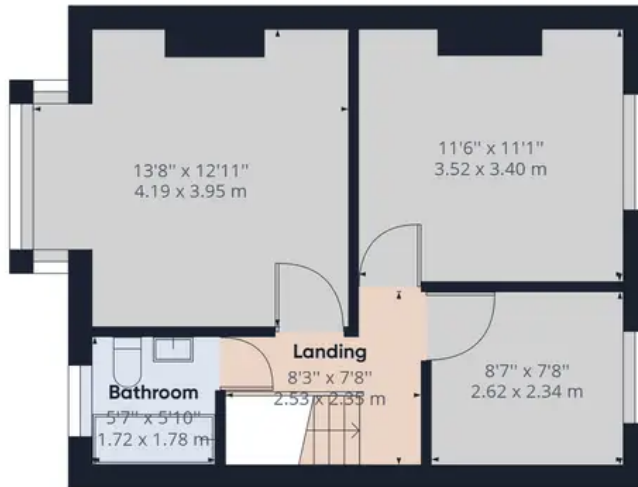

Floor 1

Approximate total area⁽¹⁾

1036.04 ft²

96.25 m²

(1) Excluding balconies and terraces

While every attempt has been made to ensure accuracy, all measurements are approximate, not to scale. This floor plan is for illustrative purposes only.

GIRAFFE 360

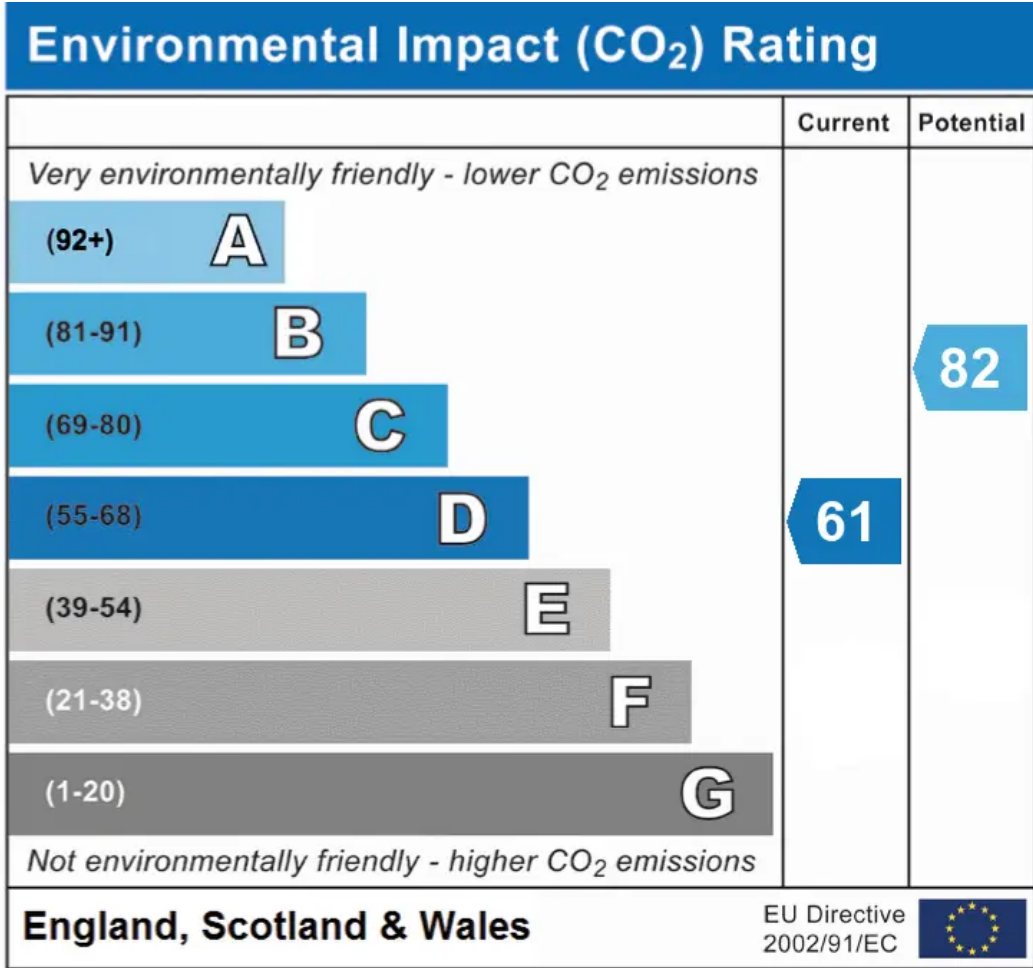
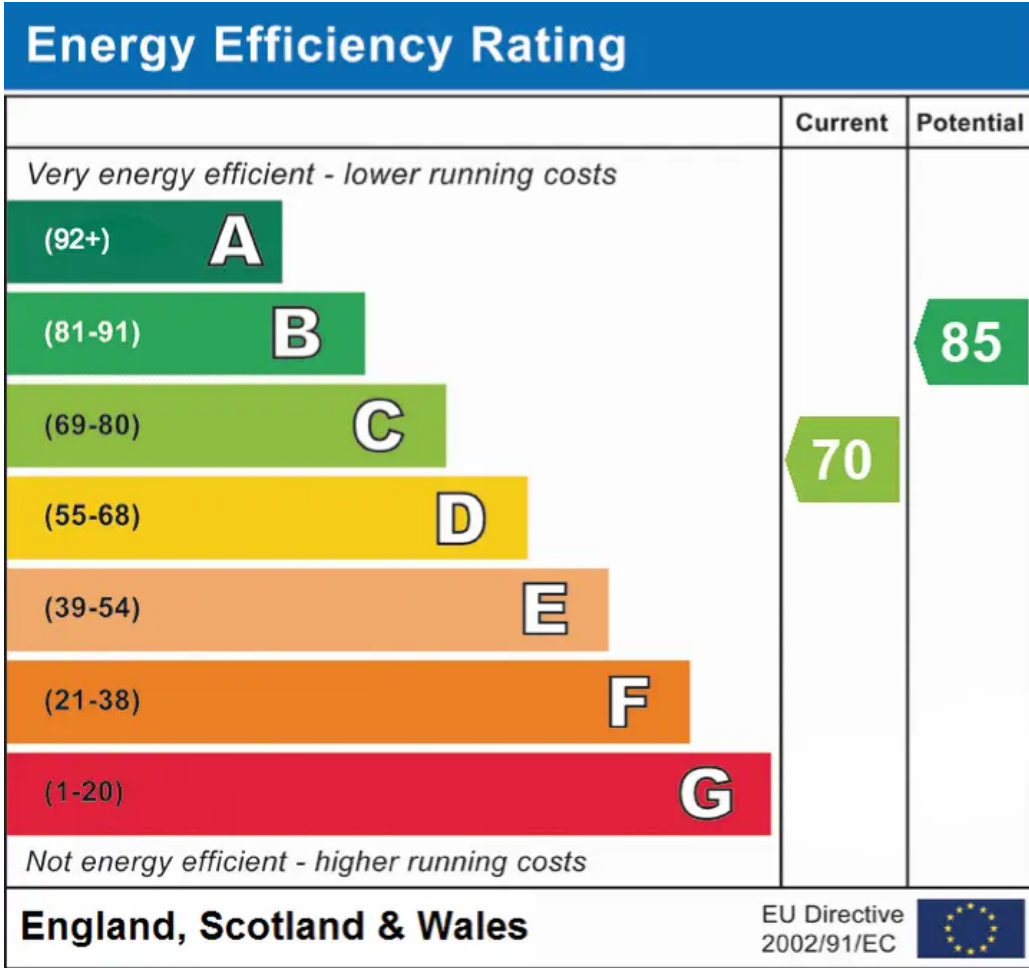

Chinneck Shaw

Bridge House, Milton Road, Portsmouth – PO3 6AN

023 9282 6731

hello@chinneckshaw.co.uk

www.chinneckshaw.co.uk/

Chinneck Shaw, Bridge House, Milton Road, PO3 6AN Consumer Protection from Unfair Trading Regulations 2008: These details are for guidance only and complete accuracy cannot be guaranteed. If there is any point which is of particular importance, verification should be obtained. The do not constitute a contract or part of a contract. All measurements are approximate. No guarantee can be given with regard to planning permissions or fitness for purpose. No apparatus, equipment, fixture or fitting has been tested. Items shown in the photographs are NOT necessarily included. Interested Parties are advised to check availability and make an appointment to view before travelling to see a property.