



kelway
law

Hindhead Galleries, Tilford Road, Hindhead

£500 PCM EPC - D

Hindhead Galleries

At a glance:

- Brand new fitted kitchen
- Access to A3
- Brand new fitted carpet
- Spacious living area
- Local conveniences near by
- Fully fitted shower
- Fridge freezer
- Gas oven

This spacious studio apartment is situated in a perfect location in Hindhead for anyone looking for access to the A3.

The first floor apartment is set in a building with only 4 other apartments. Accommodating a new fitted kitchen coming equipped with a fridge freezer and gas oven. The light and airy generous living space, provides the opportunity to use as a sitting room/bedroom

Also benefiting from a separate and private shower room which is fitted with a white suite,



Hindhead Galleries

Hindhead & Surroundings:

The property is set close to local conveniences such as the post office/store/petrol station, a dentist and a coffee shop. Further conveniences include playing fields, Hindhead Golf Club, local shops and restaurants, pharmacy, churches and a primary school.

The larger towns of Farnham and Haslemere are within a short driving distance, both with high street shopping and main-line rail connections to London in under an hour. Access to the A3 is just a few minutes away, with dual carriageways leading to London and Portsmouth. The surrounding area hosts a large choice of primary and secondary schools plus beauty spots including The Devil's Punchbowl and The Golden Valley.

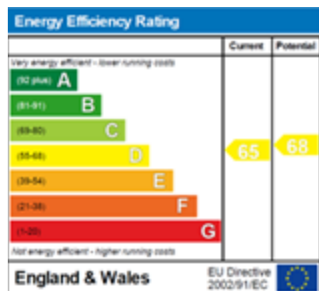

Agents Note:

Whilst we endeavour to make our details accurate and reliable, if there is any point which is of particular importance to you please contact this office and we will be pleased to check the relevant information. Do so particularly if contemplating travelling some distance to view a property. The appliances mentioned have not been professionally tested.

2 Hindhead Galleries

Viewings Arrangements:

Viewings are strictly by appointment with Kelway Law Estate Agents and can be booked by calling the local office or via our website www.kelwaylaw.co.uk

We are open:

Monday – Friday: 09:00 – 18:00
Saturday: 09:00 – 17:00

Are you selling locally?

Your property is our passion and we would be delighted to assist with your move. To book your free no obligation valuation call your local office or visit www.kelwaylaw.co.uk

Haslemere: 01428 661525
Hindhead: 01428 604488
Liphook: 01428 722447

Investment Purchase?

Buying a property to let then you'll need to know the in's and out's from rental value through to your legal obligations as a Landlord. Being members of Association of Regulated Letting Agents (ARLA) means that you can be sure of a professional knowledgeable person looking after your property.

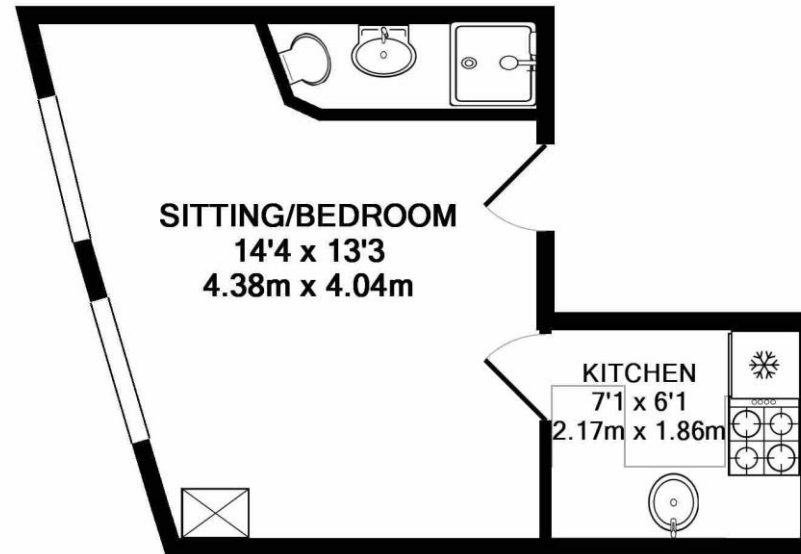

TOTAL APPROX. FLOOR AREA 218 SQ.FT. (20.2 SQ.M.)

Whilst every attempt has been made to ensure the accuracy of the floor plan contained here, measurements of doors, windows, rooms and any other items are approximate and no responsibility is taken for any error, omission, or mis-statement. This plan is for illustrative purposes only and should be used as such by any prospective purchaser. The services, systems and appliances shown have not been tested and no guarantee as to their operability or efficiency can be given
Made with Metropix ©2017